

Overnight closure of Lawley Middleway - A4540

Part of Birmingham's Ring Road

HS2-BBV-26-2071

Location

Lawley Middleway (A4540) Between Garison Circus and Curzon Circus

Duration

A southbound only closure from 10pm until 6am each night from 22nd May until 7 June, and a full closure 10pm until 6am each night from 25th May until 27th May

What we are doing

In August 2025, we successfully launched the Lawley Middleway Bridge, a key element of the new railway that will carry high-speed trains over Lawley Middleway and directly into the centre of Birmingham.

We now need to prepare the structure for the installation of the bridge deck. This work will include removing elements of the temporary substructure and installing the required drainage. We have carefully planned this work to take place during the school holidays and over a bank holiday weekend, when overnight traffic levels are generally much quieter.

What to expect

A full diversion route will be in place

We are committed to keeping you informed about work on HS2. This includes ensuring you know what to expect and when to expect it, as well as how we can help you. Should you have any questions or concerns about our works you can contact us by:



Freephone **08081 434 434**



Minicom **08081 456 472**



Email **HS2enquiries@hs2.org.uk**



Writing to **FREEPOST
HS2 Community Engagement**



Website **www.hs2.org.uk**

Keep up to date with what is happening in your local area at

**[www.hs2.org.uk/in-your-area/
in-your-area-map/](http://www.hs2.org.uk/in-your-area/in-your-area-map/)**

Closure area - Southbound

From 22nd May until 7th June, the southbound carriageway will be closed each night from from Garrison Circus to Curzon Circus

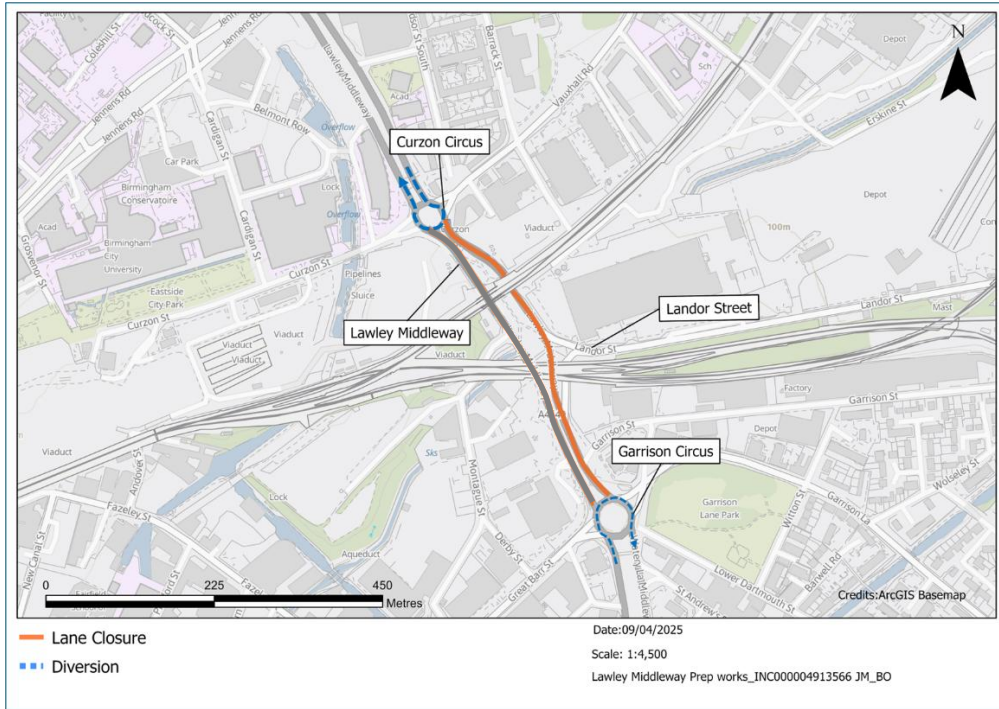

Closure area - Northbound

From 25 May until 27 May, the northbound carriageway will be closed each night from Garrison Circus to Curzon Circus resulting in a full closure of this section of the ring road

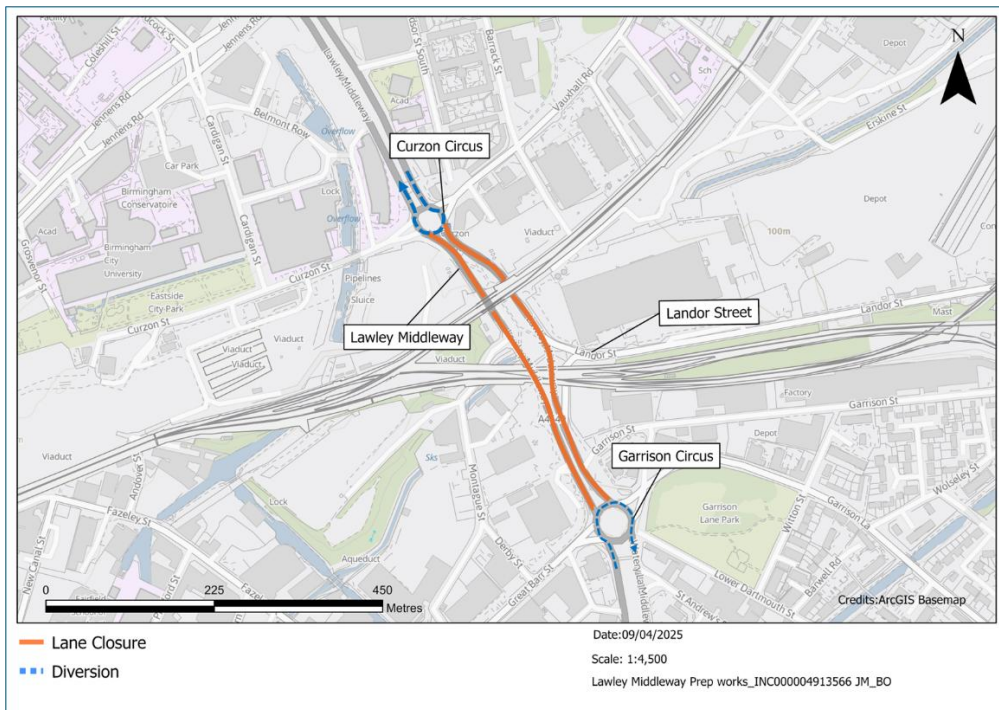

Diversion Route

Vehicles will be diverted via the ring road. However, road users are free to choose alternative routes if they prefer. Please note that the official diversion route has been planned to avoid entering the Birmingham Clean Air Zone (CAZ). For more information about the CAZ, please visit:

birmingham.gov.uk/info/20076/pollution/1763/a_clean_air_zone_for_birmingham

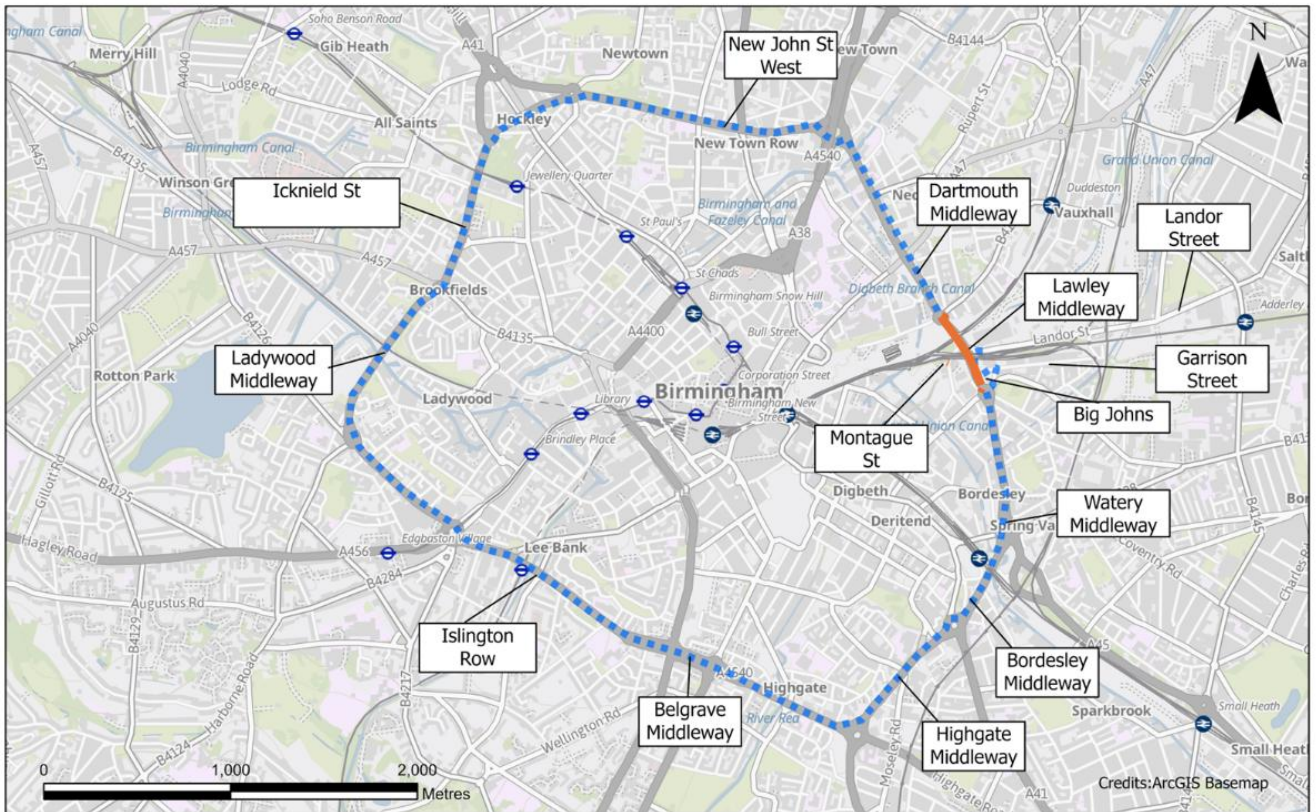

- Closure
- - - Diversion

Date:09/05/2025

Scale: 1:24,006

LawleyMiddlewayClosure_INC000004920265_BP_JP

Access arrangements for Landor Street

Between 10pm and 6am, vehicles will be diverted (fully signed) onto Langdon Street, where they'll be met by one of our traffic marshals. The marshal will then escort vehicles northbound using the southbound carriageway onto Landor Street.

We'll also have marshals assisting any vehicles leaving Landor Street, to ensure everyone remains safe throughout the closure

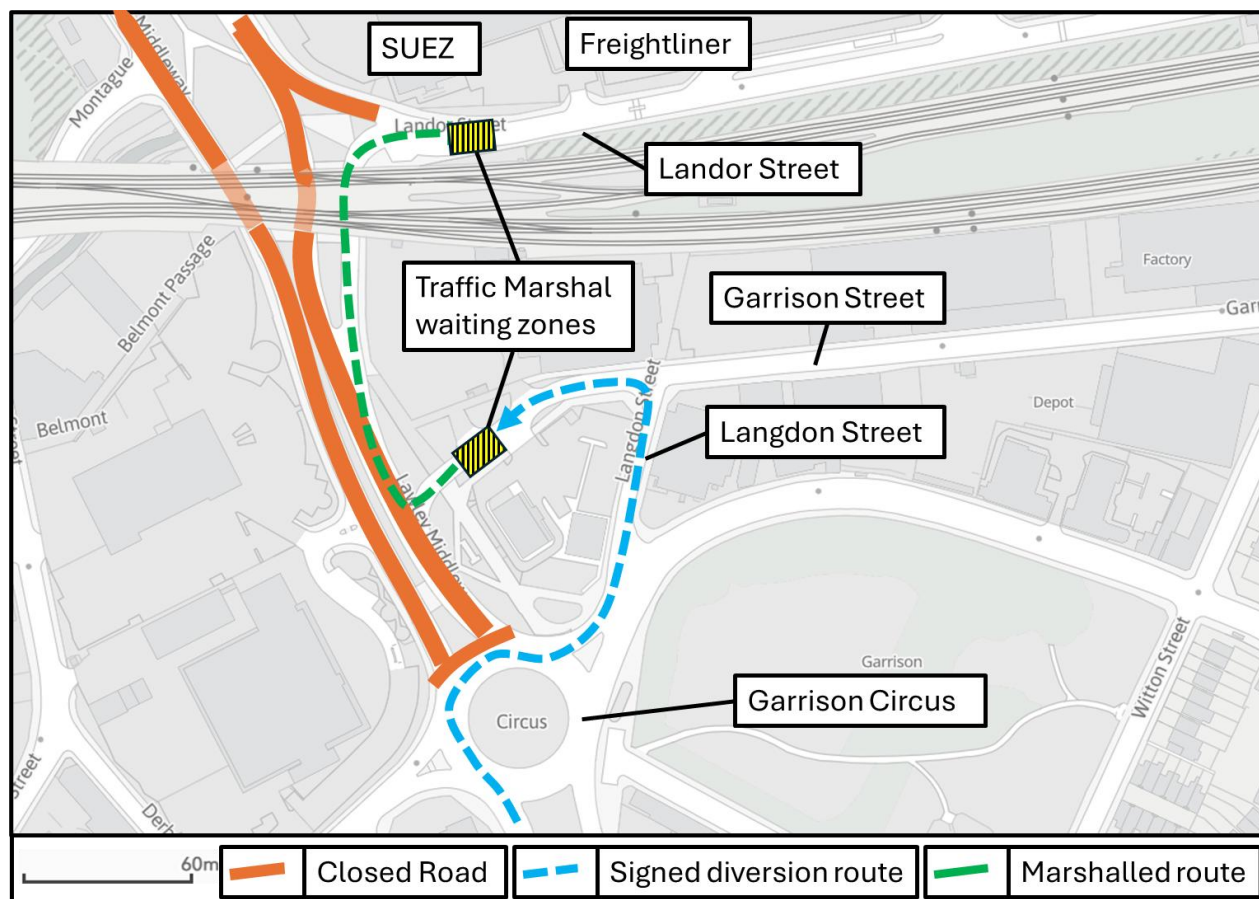

Please contact us if you'd like a free copy of this document in large print, Braille, audio or 'easy read' format. You can also contact us for help and information in a different language.

Holding us to account

If you are unhappy for any reason, you can make a complaint by contacting our HS2 Helpdesk team. For more information, visit: www.hs2.org.uk/how-to-complain

We have an independent Residents' and Construction Commissioner who helps settle disputes and monitors the way in which we manage and respond to complaints about construction.

For more information visit: www.hs2.org.uk/independent-commissioner