

Update: Notice of weekend road closures B4525, near Greatworth

HS2-EKFB-26-1882

Location

B4525, Welsh Lane near Greatworth

Duration

Weekend road closure 1: 8pm Friday 8 May to 6am Monday 11 May 2026.

Weekend road closure 2: 8pm Friday 15 May to 6am Monday 18 May 2026.

Traffic lights: until Sunday 31 May 2026.

Updated Wednesday 6 May 2026.

Please note: These dates are subject to change dependent on the construction schedule and the weather.

What we are doing

Following the cancellation of work last month, we require further weekend closures to complete utility work on a section of B4525. This includes the previously advised contingency weekend (8-11 May) and the following weekend (15-18 May).

What to expect

Weekend and evening working

We are committed to keeping you informed about work on HS2. This includes ensuring you know what to expect and when to expect it, as well as how we can help you. Should you have any questions or concerns about our works you can contact us by:



Freephone **08081 434 434**



Minicom **08081 456 472**



Email **HS2enquiries@hs2.org.uk**



Writing to **FREEPOST HS2 Community Engagement**



Website **www.hs2.org.uk**

Keep up to date with what is happening in your local area at

www.hs2.org.uk/in-your-area/in-your-area-map/

Weekend road closures diversion map

A section of the road will be closed between the Greatworth turn and the roundabout on B4525. In addition, there will be a lane closure on a short section near the road closure. A diversion will be in place as shown on the map below.

Following the road closures, there will be some periods of traffic lights on the B4525, in the same location as the closures.

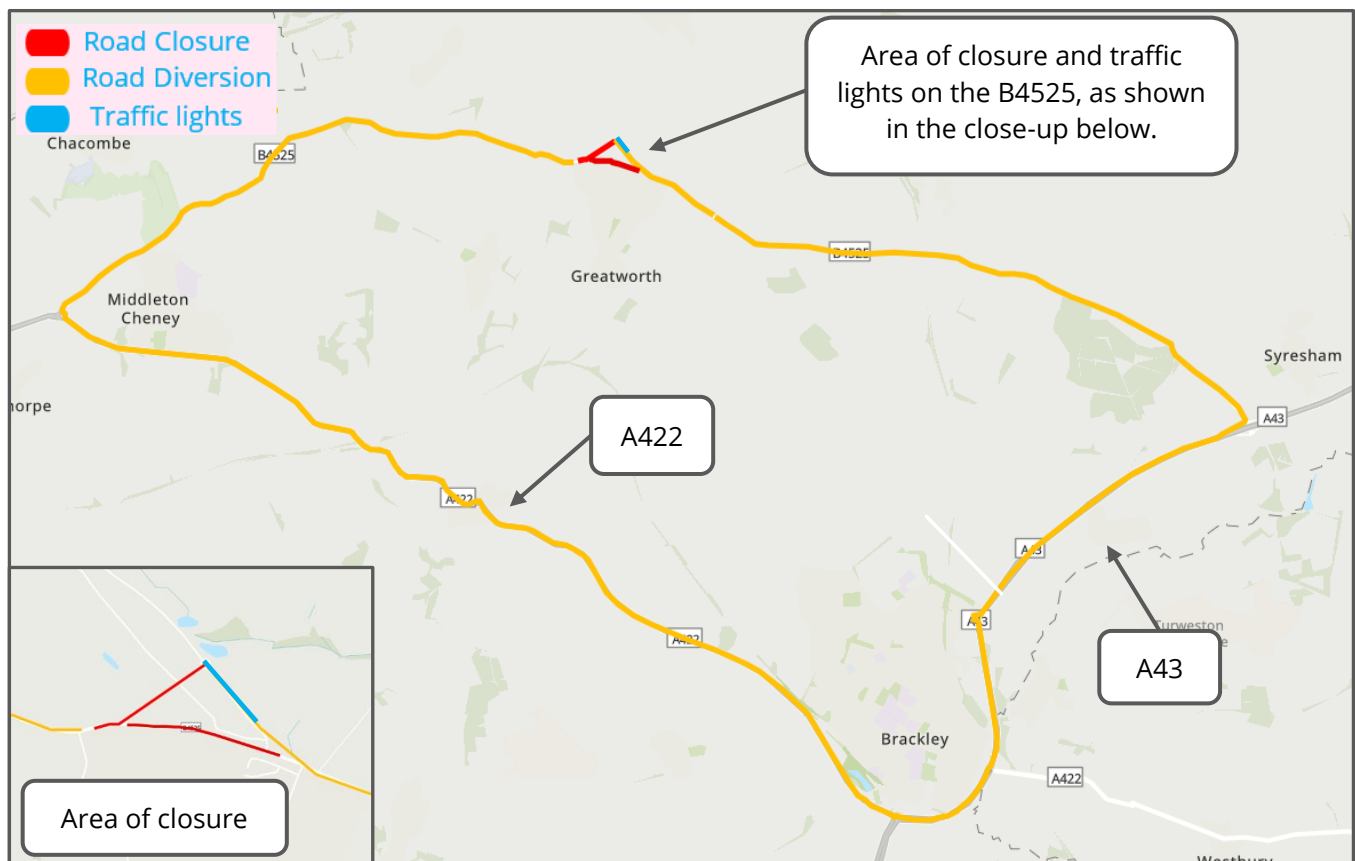

Please contact us if you'd like a free copy of this document in large print, Braille, audio or 'easy read' format. You can also contact us for help and information in a different language.

Holding us to account

If you are unhappy for any reason, you can make a complaint by contacting our HS2 Helpdesk team. For more information, visit: www.hs2.org.uk/how-to-complain

We have an independent Residents' and Construction Commissioner who helps settle disputes and monitors the way in which we manage and respond to complaints about construction.

For more information visit: www.hs2.org.uk/independent-commissioner