

# Notice of road closure Werner Terrace/Brackley Lane, Calvert

**HS2-EKFB-26-1729**

## Location

Werner Terrace/Brackley Lane junction, Calvert Green

## Duration

16 March until 11 April 2026, 24 hours a day

## What we are doing

The works involve removing a 30m section of the existing road surface at the junction of Werner Terrace and Brackley Lane. New kerbs will be installed, and the road surface will be reinstated to tie in with the new highway over the Calvert Road overbridge.

## What to expect

Expect periods of increased noise during the road construction. The works are expected to create low levels of vibration and we continuously be monitoring vibration levels. Calvert link road will temporarily close during these works. Vehicles will not be permitted along the road with the exception of the school and public bus service which will still operate to timetable. The link road will remain open for pedestrians and cyclists.

We are committed to keeping you informed about work on HS2. This includes ensuring you know what to expect and when to expect it, as well as how we can help you. Should you have any questions or concerns about our works you can contact us by:



Freephone **08081 434 434**



Minicom **08081 456 472**



Email **HS2enquiries@hs2.org.uk**



Writing to **FREEPOST  
HS2 Community Engagement**



Website **www.hs2.org.uk**

Keep up to date with what is happening in your local area at

**[www.hs2.org.uk/in-your-area/in-your-area-map/](http://www.hs2.org.uk/in-your-area/in-your-area-map/)**

## Where we will be working

The map shows the location of the road closure on the junction of Werner Terrace and Brackley Lane, Calvert Green, from 16 March to 11 April 2026. It also shows the closure of the temporary road linking Calvert Green and the Claydon's and the Steeple Claydon to Twyford Road closure. Traffic management will be in place on Gawcott Road until 29<sup>th</sup> May 2026. Diversion routes are shown in yellow.

During morning and evening peaks, some delays are expected, but the system is working as designed and will remain in place for the duration of the closure. We ask that all road users follow the traffic signals at all times, avoid jumping any lights which will trigger any additional waiting times. We recognise the impact these works have on your daily journeys and routines, and we appreciate that this is frustrating. Your patience, respect for staff, and adherence to the restrictions is greatly appreciated.

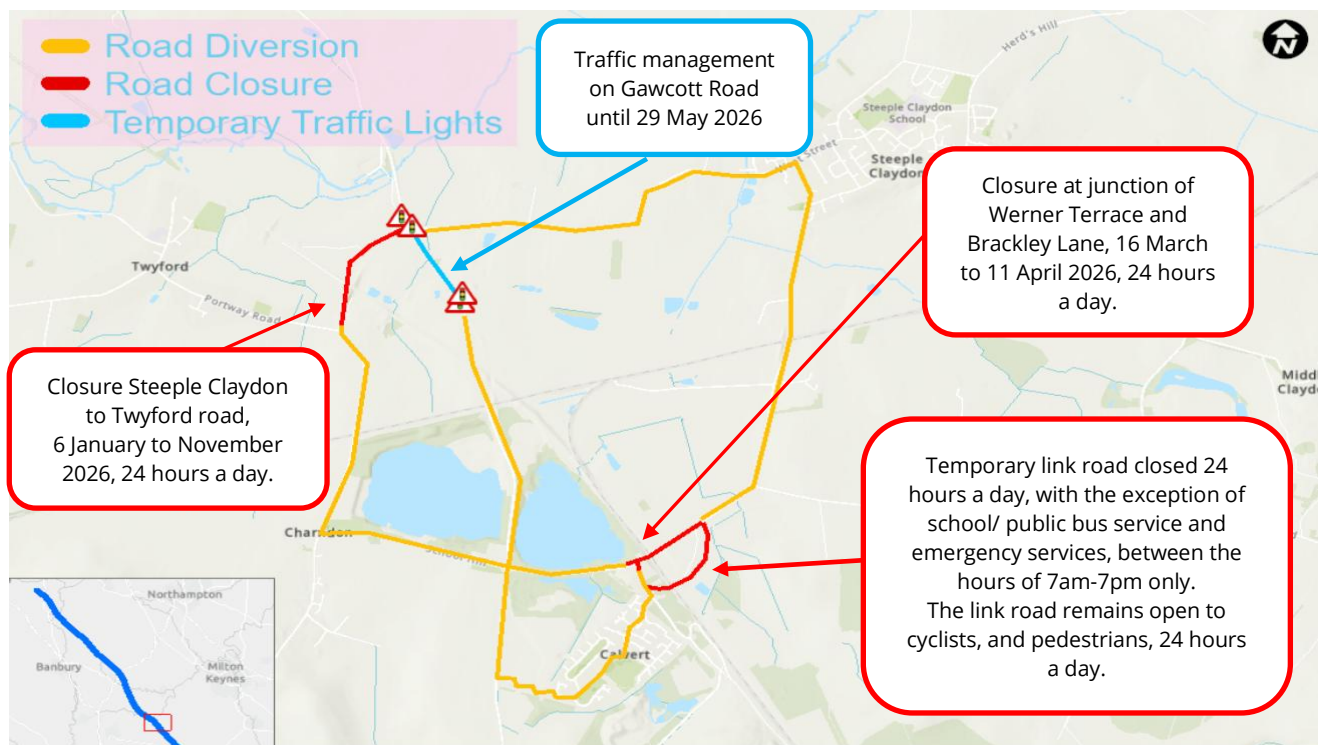

Please contact us if you'd like a free copy of this document in large print, Braille, audio or 'easy read' format. You can also contact us for help and information in a different language.

## Holding us to account

If you are unhappy for any reason, you can make a complaint by contacting our HS2 Helpdesk team. For more information, visit: [www.hs2.org.uk/how-to-complain](http://www.hs2.org.uk/how-to-complain)

We have an independent Residents' and Construction Commissioner who helps settle disputes and monitors the way in which we manage and respond to complaints about construction.

For more information visit: [www.hs2.org.uk/independent-commissioner](http://www.hs2.org.uk/independent-commissioner)