



Notice of two overnight road closures of M42 northbound in February 2025

February 2025 | www.hs2.org.uk

High Speed Two (HS2) is the new high speed railway for Britain. Balfour Beatty VINCI is working in partnership with HS2 Ltd to build the new high-speed railway in your area.

The work we will be doing

As we prepare for construction of the new M42 Coleshill Triple Box Bridge across the M42 motorway we will be carrying out overnight maintenance works, and validation of the current speed cameras placed along that section of motorway.

To allow us to complete these works, there will be overnight closures of the M42 northbound carriageway from junction 7 to junction 8. This will also include the slip road from M42 northbound at junction 7 to M6 southbound and the M6 Toll connector road northbound, from M6 junction 3a to M42 northbound.

When the work will take place

To ensure the safety of our workforce, we will be installing two overnight road closures on Friday 21 February and again overnight on Monday 24 February. The closures will be in place from 8pm each night and will be removed at 5am each morning.

This work is subject to consent with National Highways.

Where will the work take place

Please be aware other work affecting the M42/M6 link road, M6 Toll and M42 is ongoing, details can be found at www.hs2.org.uk/warwickshire

If you have a question about HS2 or our works, please contact our HS2 Helpdesk team on 08081 434 434 or email hs2enquiries@hs2.org.uk

Subject to consent Duration of works

Overnight road closure on M42 northbound on Friday 21 February and Monday 24 February, from 9pm to 5am each night.

What to expect

Clearly signed diversion route

What we will do

Inform you of any changes in advance

Keep you informed of updates via:

hs2.org.uk/warwickshire

Notice of two overnight road closures of M42 northbound in February 2025

www.hs2.org.uk

Map of closure and diversion route

This map shows where the road closures will be in place on the M42.

A road closure of the M42 northbound carriageway from J7 to J8 as well as the slip road from M42 northbound at J7 to M6 southbound and the M6Toll northbound connector road from M6 northbound at J3a to M42 northbound at J7a.

A diversion route will be in place from M6 northbound to J5. At M6 J5 traffic should leave and rejoin the M6 southbound to M6 J4a, eastbound link road to rejoin the M42 where the diversion ends.

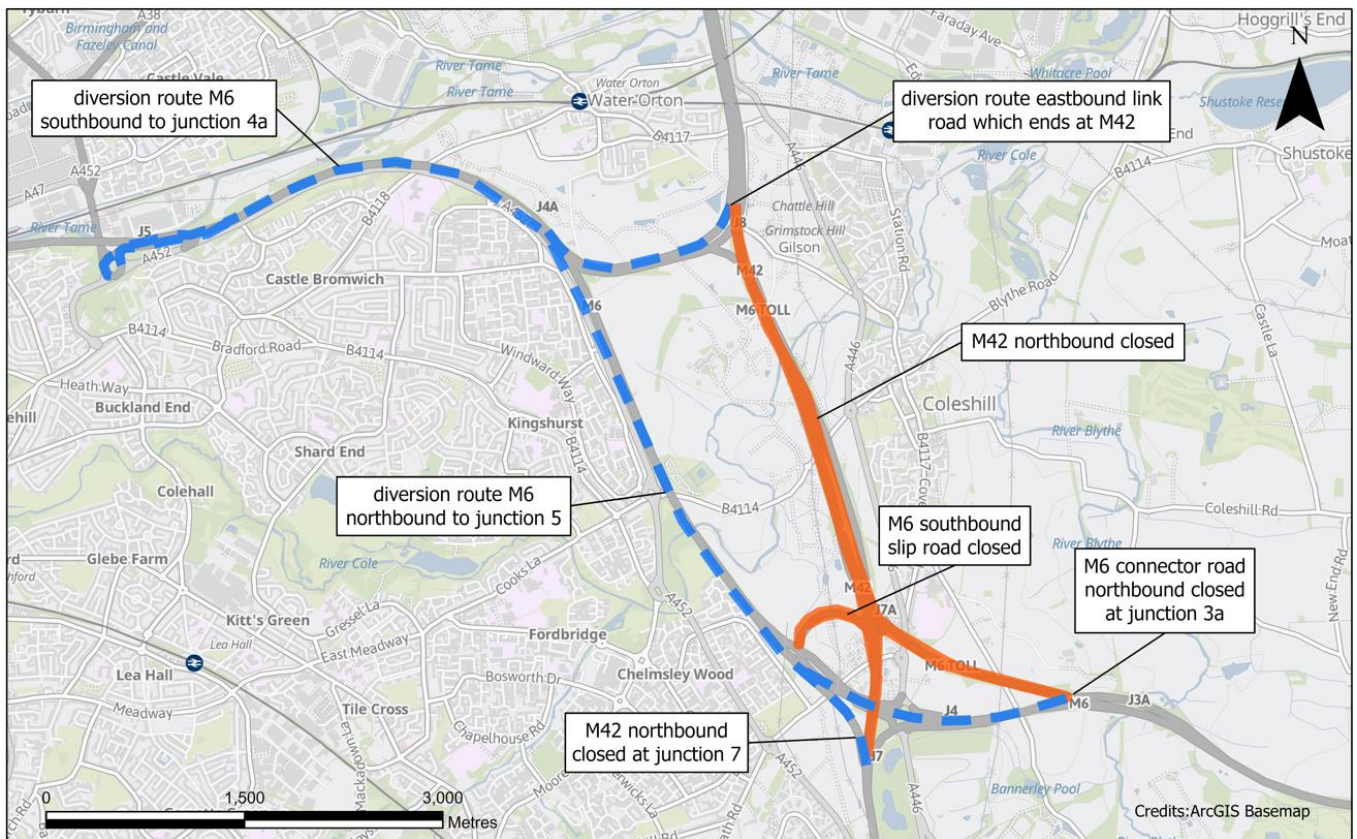

- Orange line: Road Closure
- Blue dashed line: Diversions

Date: 29/01/2025

Scale: 1:35,000

M42 Road Closure_INC000004887923_INC000004888417MB_BO

Contact our HS2 Helpdesk team on **08081 434 434**

What else is happening in your area?

www.hs2.org.uk

Contact our HS2 Helpdesk team

Our team is here to listen and respond to your enquiry, complaint or feedback to help us be a good neighbour.

You can contact our Helpdesk team all day, every day of the year on:

Freephone: **08081 434 434**

Minicom: **08081 456 472**

Email: hs2enquiries@hs2.org.uk



Keep up-to-date with your local community website

To find out more about what's happening in your area and receive regular email updates, you can sign up to our local community websites at: www.hs2inyourarea.co.uk.

About our Community and Business Funds

We are offering two funds that are available to local communities and businesses between the West Midlands and London, to help with the disruption caused by our construction work. These are the Community and Environment Fund (CEF) and the Business and Local Economy Fund (BLEF).

The CEF is designed to give communities the opportunity to share in the benefits of HS2. It is an allocated fund that communities are able to apply for, to help to support local projects that aim to improve their local area.

The BLEF is designed to support local economies that may be disrupted by the construction of HS2. BLEF grants are for local business support organisations and local authorities to help maintain business activity in local communities.

For more information about each of these funds, including how to apply, please visit: <https://www.groundwork.org.uk/hs2funds>



Keeping you informed

We are committed to keeping you informed about work on HS2. This includes ensuring you know what to expect and when to expect it, as well as how we can help you.

The Residents' Commissioner

The independent Residents' Commissioner oversees and monitors our commitments to you.

The commissioner's reports and our responses can be found at www.gov.uk/government/collections/hs2-ltd-residents-commissioner

The Residents' Commissioner makes sure we fulfil the commitments in the HS2 Community Engagement Strategy (<https://bit.ly/3oOA25j>).

The Residents' Commissioner can be contacted on: residentscommissioner@hs2.org.uk

Construction Commissioner

The independent Construction Commissioner regularly meets our Chief Executive Officer to raise any concerns or emerging trends across HS2.

The Construction Commissioner's role has been developed to monitor the way we manage and respond to construction complaints.

The commissioner mediates on disputes about construction, involving individuals and organisations, that we can't resolve. The commissioner advises members of the public about how to make a complaint about construction.

The Construction Commissioner can be contacted on: complaints@hs2-cc.org.uk

Property and compensation

You can find out about HS2 and properties along the route by visiting:

www.gov.uk/government/collections/hs2-property

Find out if you can claim compensation at:

www.gov.uk/claim-compensation-if-affected-by-hs2

Holding us to account

If you are unhappy for any reason you can make a complaint by contacting the HS2 Helpdesk. For more details on our complaints process, please visit:

www.hs2.org.uk/in-your-area/contact-us/how-to-complain/

Reference number: HS2-MW-BBV-Ph1-Ar-No-N1-Traf-41-28/01/2025

High Speed Two (HS2) Limited, registered in England and Wales.

Registered office: Two Snowhill, Snow Hill Queensway, Birmingham B4 6GA.

Company registration number: 06791686. VAT registration number: 888 8512 56

Contact us

Contact our HS2 Helpdesk team all day, every day of the year on:

 Freephone **08081 434 434**

 Minicom **08081 456 472**

 Email **HS2enquiries@hs2.org.uk**

Write to:

FREEPOST

HS2 Community Engagement

Website **www.hs2.org.uk**

To keep up to date with what is happening in your local area, visit: **www.HS2inyourarea.co.uk**

Please contact us if you'd like a free copy of this document in large print, Braille, audio or 'easy read' format. You can also contact us for help and information in a different language.

HS2 Ltd is committed to protecting personal information. If you wish to know more about how we use your personal information please see our Privacy Notice: <https://www.gov.uk/government/publications/high-speed-two-ltd-privacy-notice>