



Update: Use of the Adelaide Road site welfare facilities

January 2025 | www.hs2.org.uk

High Speed Two (HS2) is the new high speed railway for Britain.

Use of welfare facilities

From **Tuesday 14 January 2025**, the welfare facilities in the Adelaide Road Ventilation Shaft and Headhouse site will be used by our staff for the remainder of 2025, as part of the ongoing works to protect the Grade II* Listed Camden Winding Engine Vaults located beneath the railway near Juniper Crescent and Gilbey's Yard.

For details of these works, please read here:

<https://www.hs2.org.uk/work-items/lorry-deliveries-near-gilbeys-yard/>.

The workforce will be transported between our site and the Vaults by minibus, so the site gates will be in use for the minibus during working hours.

The Adelaide Road Ventilation Shaft and Headhouse site will remain in a 'safe stop' until further notice, with no site activities taking place other than security and maintenance works.

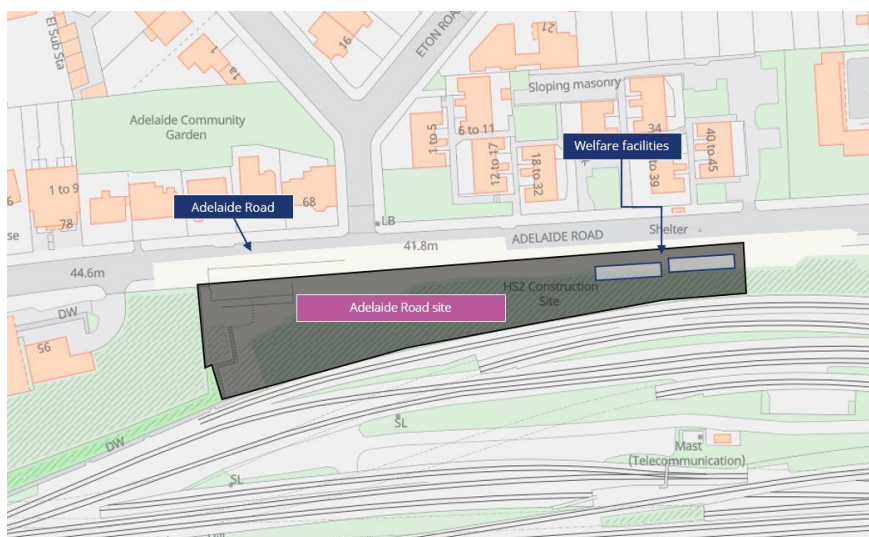

If you have a question about HS2 or our works, please contact our HS2 Helpdesk team on 08081 434 434 or email hs2enquiries@hs2.org.uk

Duration of works

From 14 January 2025, throughout 2025

Working hours:

8am to 6pm, Monday to Fridays and 8am to 1pm, Saturdays

We may be on site for an hour before the start and/or end of each shift

What to expect

You may notice staff and vehicles on site accessing the welfare facilities

What we will do

Dates mentioned in this notification may change.

We will provide updates a HS2inCamden.co.uk

Keeping you informed

We are committed to keeping you informed about work on HS2. This includes ensuring you know what to expect and when to expect it, as well as how we can help you.

The Residents' Commissioner

The independent Residents' Commissioner oversees and monitors our commitments to you.

The commissioner's reports and our responses can be found at www.gov.uk/government/collections/hs2-ltd-residents-commissioner

The Residents' Commissioner makes sure we fulfil the commitments in the HS2 Community Engagement Strategy (<https://bit.ly/3oOA25j>).

The Residents' Commissioner can be contacted on: residentscommissioner@hs2.org.uk

Construction Commissioner

The independent Construction Commissioner regularly meets our Chief Executive Officer to raise any concerns or emerging trends across HS2.

The Construction Commissioner's role has been developed to monitor the way we manage and respond to construction complaints.

The commissioner mediates on disputes about construction, involving individuals and organisations, that we can't resolve. The commissioner advises members of the public about how to make a complaint about construction.

The Construction Commissioner can be contacted on: complaints@hs2-cc.org.uk

Property and compensation

You can find out about HS2 and properties along the route by visiting:

www.gov.uk/government/collections/hs2-property

Find out if you can claim compensation at:

www.gov.uk/claim-compensation-if-affected-by-hs2

Holding us to account

If you are unhappy for any reason you can make a complaint by contacting the HS2 Helpdesk. For more details on our complaints process, please visit:

www.hs2.org.uk/in-your-area/contact-us/how-to-complain/

Contact us

Contact our HS2 Helpdesk team all day, every day of the year on:

 Freephone **08081 434 434**

 Minicom **08081 456 472**

 Email **HS2enquiries@hs2.org.uk**

Write to:

FREEPOST

HS2 Community Engagement

Website **www.hs2.org.uk**

To keep up to date with what is happening in your local area, visit:
www.HS2inyourarea.co.uk

Please contact us if you'd like a free copy of this document in large print, Braille, audio or 'easy read' format. You can also contact us for help and information in a different language.

HS2 Ltd is committed to protecting personal information. If you wish to know more about how we use your personal information please see our Privacy Notice:
<https://www.gov.uk/government/publications/high-speed-two-ltd-privacy-notice>

Reference number: HS2-EW-SCS-Ph1-Ar-So-S1-Prog-Works-1-10/01/2025

High Speed Two (HS2) Limited, registered in England and Wales.

Registered office: Two Snowhill, Snow Hill Queensway, Birmingham B4 6GA.

Company registration number: 06791686. VAT registration number: 888 8512 56