

Notice of road closures and traffic management, A4010 Risborough Road

October 2024 | www.hs2.org.uk

High Speed Two (HS2) is the new high speed railway for Britain. If you have any questions or enquiries about our work, please contact our Helpdesk to find out more. You can sign up for regular updates in your local area at www.hs2inyourarea.co.uk.

What are we doing?

Earlier this year we began diverting the Thames Water main along the A4010 Risborough Road. In November, we will be continuing this work as well as carrying out surveys in a second location relating to the construction of the new relief road.

The works on the water main will be completed under a lane closure controlled by traffic lights. Our work area will be separated from the live carriageway by concrete barriers. We must close the road completely for one night to install these barriers before the works begin and for one day when they are finished to remove them.

We will then survey the existing road at the connecting point to the new relief road. We will also be carrying out works to locate underground utilities in this area. This will be completed under a single lane closure, with a full road closure necessary for the final day only.

When will these works take place?



- Full road closure Friday 8 November 8:30pm – Saturday 9 November 5:30am
- 2-way traffic lights Saturday 9 November 5:30am – Sunday 24 November 9am (24-hour)
- Full road closure Sunday 24 November 9am-3pm
- 3-way traffic lights Monday 25 November – Thursday 28 November 9am-3pm
- Full road closure Friday 29 November 9am-3pm

These dates may change due to conditions outside of our control.

Please refer to the HS2 website regularly to check for any changes and updates.

If you have a question about HS2 or our works, please contact our HS2 Helpdesk team on 08081 434 434 or email hs2enquiries@hs2.org.uk

Notification



Duration of works

Road closures:

Friday 8 – Saturday 9
November 8:30pm-5:30am

Sunday 24 November
9am-3pm

Friday 29 November 9am-
3pm

Traffic management:

2-way lights Saturday 9 –
Sunday 24 November, 24-
hour

3-way lights Monday 25
November – Thursday 28
November 9am-3pm

What to expect

Closures and traffic lights
on the A4010 Risborough
Road

Increased travel time

Signposted diversions

What we will do

Provide updates for
communities and maintain
regular contact with
emergency services.

Notice of road closures and traffic management, A4010 Risborough Road



Where will these works take place?

The map below shows the sections of the A4010 Risborough Road which will be closed overnight from Friday 8 – Saturday 9 November 8:30pm-5:30am, during the day on Sunday 24 November 9am-3pm and during the day on Friday 29 November 9am-3pm. The map also shows the signposted diversion route.

During each road closure access for residents and businesses who are **inside the closure**, including The Bucks Goat Centre and Freemantle Court, will be maintained. We have been advised that all of these businesses will be open as usual.

Access for residents and businesses who are **outside the closure** will be maintained via the signposted diversion route only.

Access for pedestrians and emergency services will be maintained through all closures.

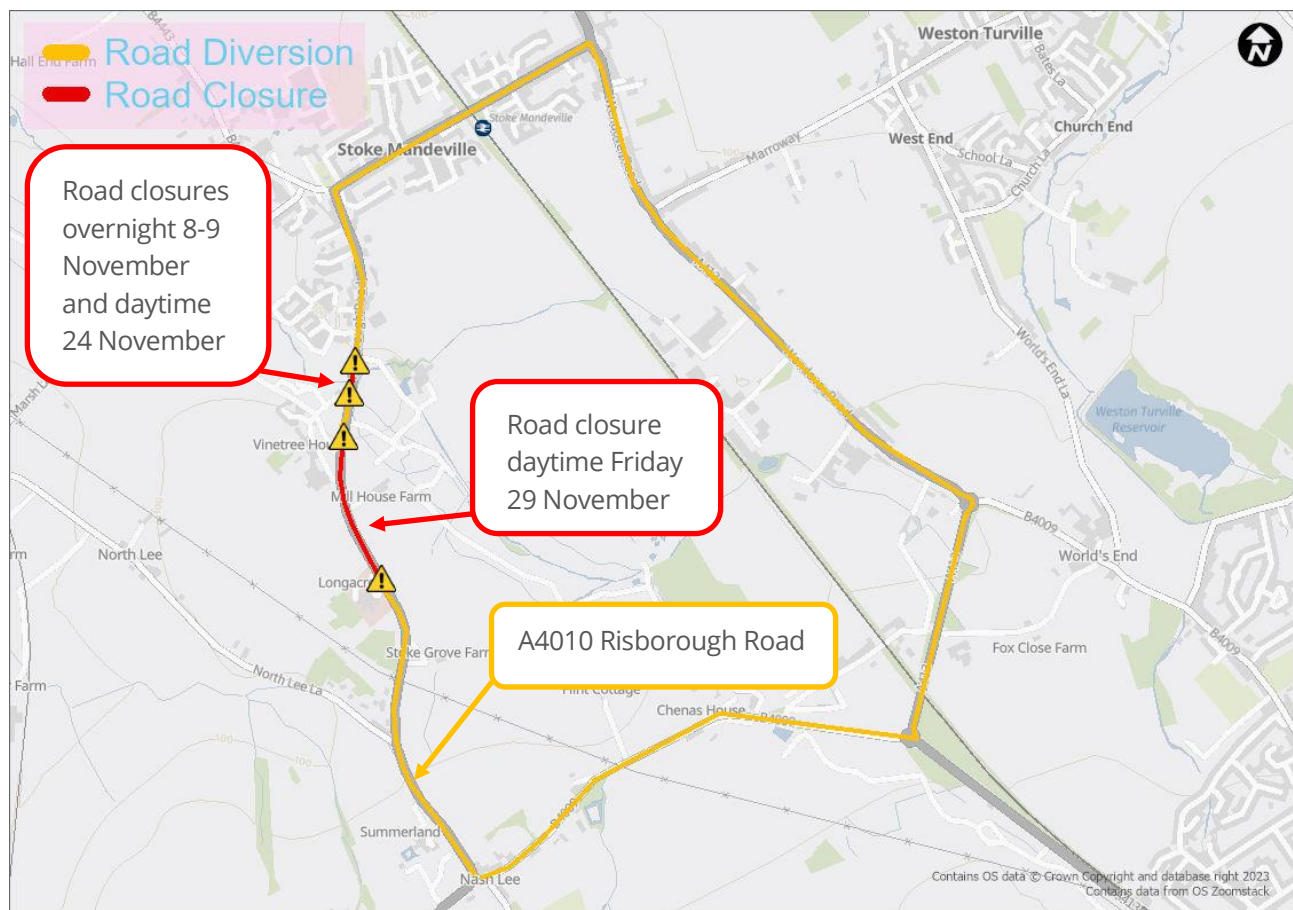

Notice of road closures and traffic management, A4010 Risborough Road



Where will these works take place?

The map below shows the sections of the A4010 Risborough Road which will be under traffic management from 5:30am Saturday 9 November – 9am Sunday 24 November (24 hour) and Monday 25 November – Thursday 28 November (9am-3pm).

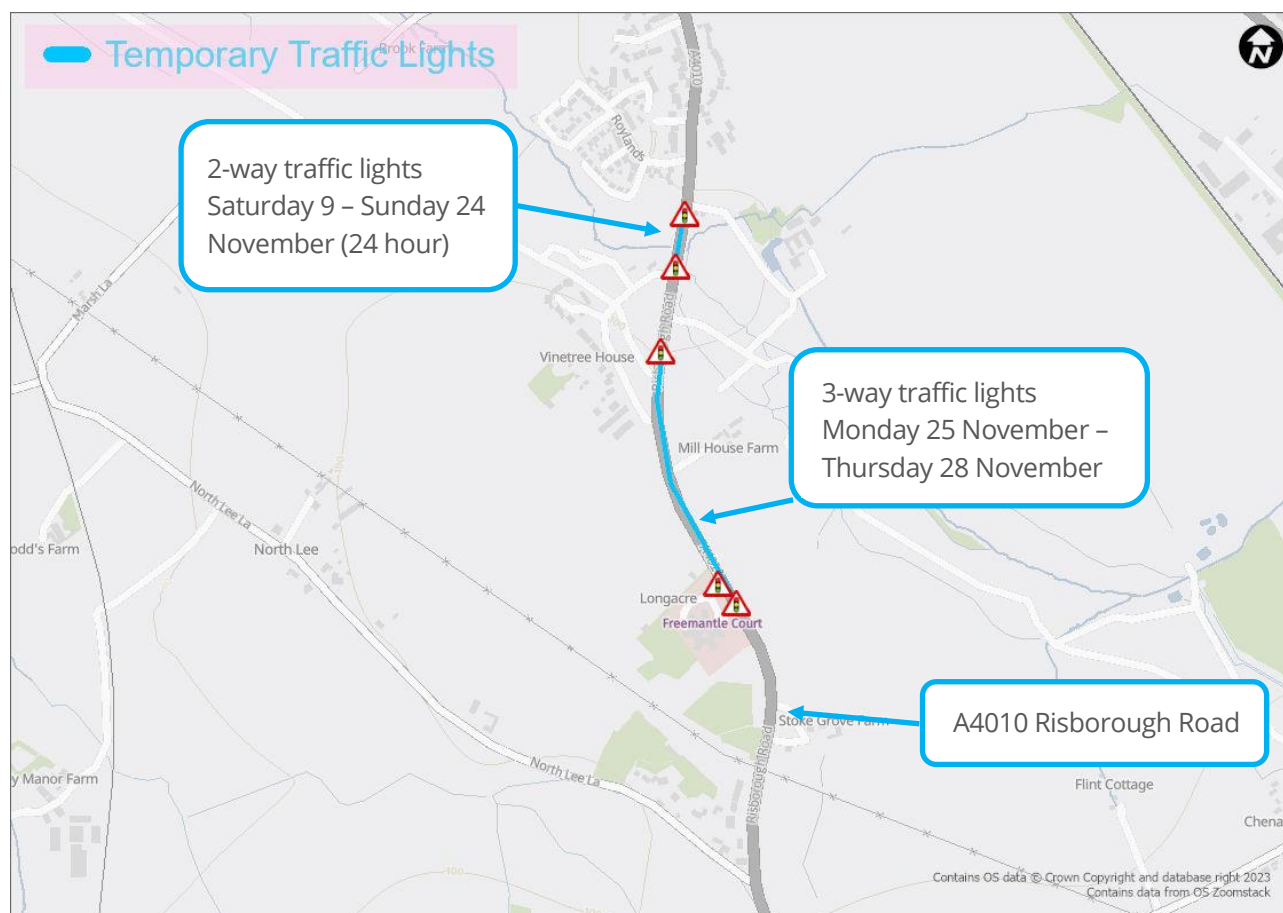

Keeping you informed

We are committed to keeping you informed about work on HS2. This includes ensuring you know what to expect and when to expect it, as well as how we can help.

Residents' Charter and Commissioner

The Residents' Charter is our promise to communicate as clearly as we possibly can with people who live along or near the HS2 route.
www.gov.uk/government/publications/hs2-residents-charter

We also have an independent Residents' Commissioner whose job is to make sure we keep to the promises we make in the Charter and to keep it under constant review. Find reports at:
www.gov.uk/government/collections/hs2-ltd-residents-commissioner

You can contact the Commissioner at:
residentscommissioner@hs2.org.uk

Construction Commissioner

The Construction Commissioner's role is to mediate and monitor the way in which HS2 Ltd manages and responds to construction complaints. You can contact the Construction Commissioner by emailing:
complaints@hs2-cc.org.uk

Property and compensation

You can find out all about HS2 and properties along the line of route by visiting:
www.gov.uk/government/collections/hs2-property
Find out if you're eligible for compensation at:
www.gov.uk/claim-compensation-if-affected-by-hs2

Holding us to account

If you are unhappy for any reason you can make a complaint by contacting our HS2 Helpdesk team. For more details on our complaints process, please visit our website:
www.hs2.org.uk/how-to-complain

Contact Us

Contact our HS2 Helpdesk team all day, every day of the year on:

 Freephone **08081 434 434**

 Minicom **08081 456 472**

 Email **hs2enquiries@hs2.org.uk**

Write to:

FREEPOST

HS2 Community Engagement

Website: www.hs2.org.uk

To keep up to date with what is happening in your local area, visit:
www.hs2inyourarea.co.uk

Please contact us if you'd like a free copy of this document in large print, Braille, audio or easy read. You can also contact us for help and information in a different language.

HS2 Ltd is committed to protecting personal information. If you wish to know more about how we use your personal information please see our Privacy Notice
<https://www.gov.uk/government/publications/high-speed-two-ltd-privacy-notice-notice>

Reference number: HS2-MW-EK-Ph1-Ar-Ce-C1-Traf-27-08/10/2024

High Speed Two (HS2) Limited, registered in England and Wales.

Registered office: Two Snowhill, Snow Hill Queensway, Birmingham B4 6GA.

Company registration number: 06791686. VAT registration number: 888 8512 56.