

Contact our HS2 Helpdesk team on **08081 434 434**

HS2 Update

Our works along Old Oak Common Lane

August 2024

As part of our work to build the new HS2 station in west London, we need to lower Old Oak Common Lane. To allow us to do these works, we may need to close the road for a number of years. However, no decisions regarding road closures or the exact length of time have been made.

We are currently carrying out traffic surveys as well as air quality and noise assessments. This information will inform how we do our work on Old Oak Common Lane.

We will give you an update on our progress by autumn 2024. The community will be notified if any decisions about road closures are made. We recognise that this work will have an impact on the local area, and we will do all that we can to minimise the disruption.

Why are we lowering Old Oak Common Lane?

The HS2 Act has identified the need to provide better connectivity to serve the future Old Oak Common Station and the wider redevelopment of the Old Oak and Park Royal area. Double-decker buses will help to meet this need but, currently, the bridges along Old Oak Common Lane only provide access for single decker buses. We will need to lower the road by up to two meters so that double-decker buses can pass under the railway bridges.

Enabling double-decker buses to pass under the new bridges will help to future proof the bus networks and is part of a parliamentary legal agreement with TfL called an Undertaking and Assurance (U&A).



What are we building?

High Speed Two (HS2) is the new high-speed railway for Britain.

We are building a new HS2 railway station in Old Oak Common. The station is set to be the best connected and largest new railway station ever built in the UK. It will become one of the country's most vital transport super hubs, providing connections into the heart of London, Heathrow Airport, the West Country, south Wales, the West Midlands, the north of England and Scotland.



Why are we lowering the road?

As well as providing access to double decker buses, the road will be lowered to build new railway lines and bridges.

Increased railway lines and new bridges

On the Great Western Main Line (trains from Paddington to Wales and the West of England) the railway lines will be doubled from the current four tracks to eight tracks.

Challenges

One of the major challenges with Old Oak Common Lane is that it has been used as a 'utilities super-highway' since the mid 1800's.

Therefore, we need to move important services, such as water, gas, electricity and telecommunications, which dominate this part of North-West London and the road network.

As part of our work along Old Oak Common Lane, we need to divert 18 utilities which are either under the road or within the railway bridges. We have installed eight Under Track Crossings (UTX's) which will house the utility diversions. The UTXs are underground tunnels that have been built from north to south, adjacent to Old Oak Common Lane. As part of this work, we will make other infrastructure improvements including rebuilding depot access and the development of segregated walkways along Old Oak Common Lane. We have already completed the Wells House Road retaining wall stabilisation.

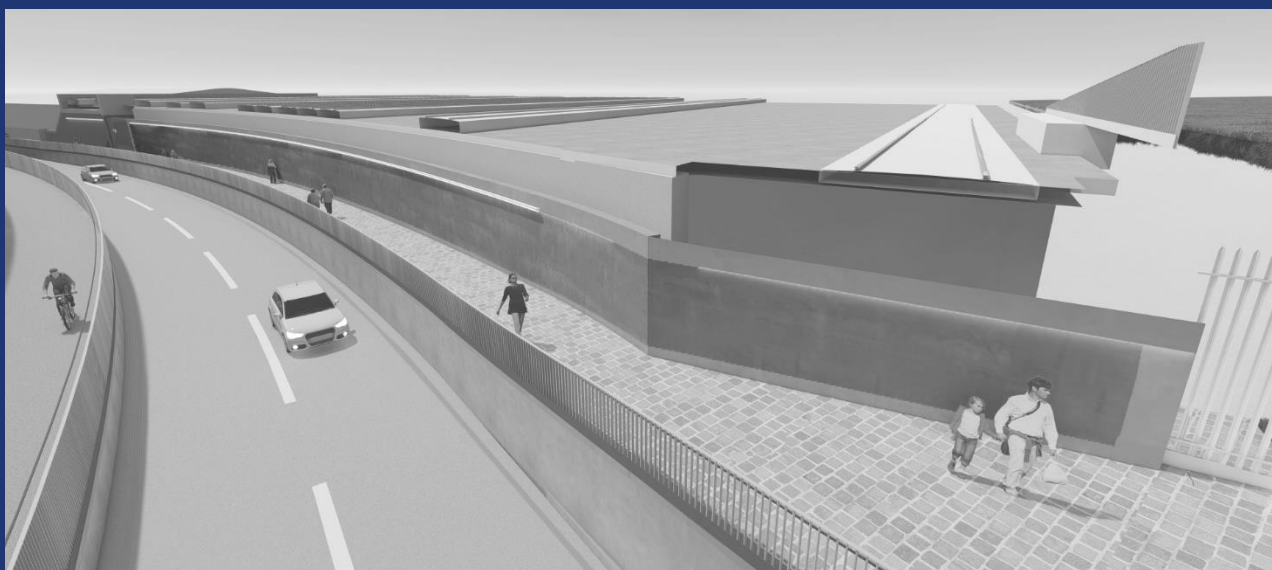

What are we doing

We are working closely with the local authorities, TfL, emergency services, local communities, local businesses, utility companies and others to plan our works on Old Oak Common Lane.

To ensure clear communication, we will engage with the community and local authorities and ensure that all advisory signage is in place ahead of any access restrictions.

We understand that the works required on Old Oak Common Lane will have a big impact on residents and businesses. We are doing all we can to minimise these impacts including keeping noise, vibration and light levels from the works to a minimum.

We are also working with Ealing Council and the OPDC to develop further support measures for residents and businesses. We will inform you of our proposals once this has been confirmed.

As soon as plans for any road closures have been finalised, local communities and businesses will be notified by newsletter. We will also host a series of in person and virtual events to provide further information and respond to any questions.

What do you consider when planning to lower the road?

This is a very complex process – we need to understand how much the road needs to be lowered, which utilities will need to be moved and how this will affect traffic, pedestrians, drainage and structures.

Understanding which utilities are in the area is essential. In order to do this, we ask statutory undertakers to provide details of assets, we carry out desktop surveys, we do site investigations with non-intrusive ground penetration radars or, if necessary, we bore trial holes to take a closer look.

Currently, there are 18 different utilities along Old Oak Common Lane, which is why it's often referred to as a utilities super-highway. This includes two significant water mains, extra high voltage distribution mains, gas lines and comms lines, to name a few. All of these will need to be diverted to allow works to progress.

Before this is done, we engage with utility providers to develop solutions and minimise any possible disruption.



Map of potential closures

The map (right) outlines potential closures along Old Oak Common Lane. However, no decisions about these closures have been made (such as when they will take place or how long they will last).

To complete works on Old Oak Common Lane, we would need to have hard closures south of the junction to Wells House Road, and north of the junction with Wulfstan Street. Hard closures mean no vehicles can pass through. This is because there will be open excavations in the road.

To enable local access in the area there would be soft closures north of Wells House Road and south of the junction with Wulfstan Street. Soft closures mean local access will be available for residents, guests, businesses, deliveries and emergency services. The road closure points will be confirmed once we have completed our assessments, and the traffic modelling has been finalised.

The footpath will remain open for pedestrian and accessible access (such as wheelchairs and prams) throughout the works. However, occasionally it will be closed when it would be unsafe to allow people to walk, whilst works take place. For example, when we need to lift structures overhead, the footpath will close. We anticipate this will only be for short periods of time.

Cyclists and e-scooter users will be asked to dismount when using the footpath along Old Oak Common Lane, and this would be enforced by our traffic management teams. In addition, our security and logistics team are prepared to manage the parking of Lime hire bikes and e-scooters around footpath areas to prevent hazards for pedestrian traffic.

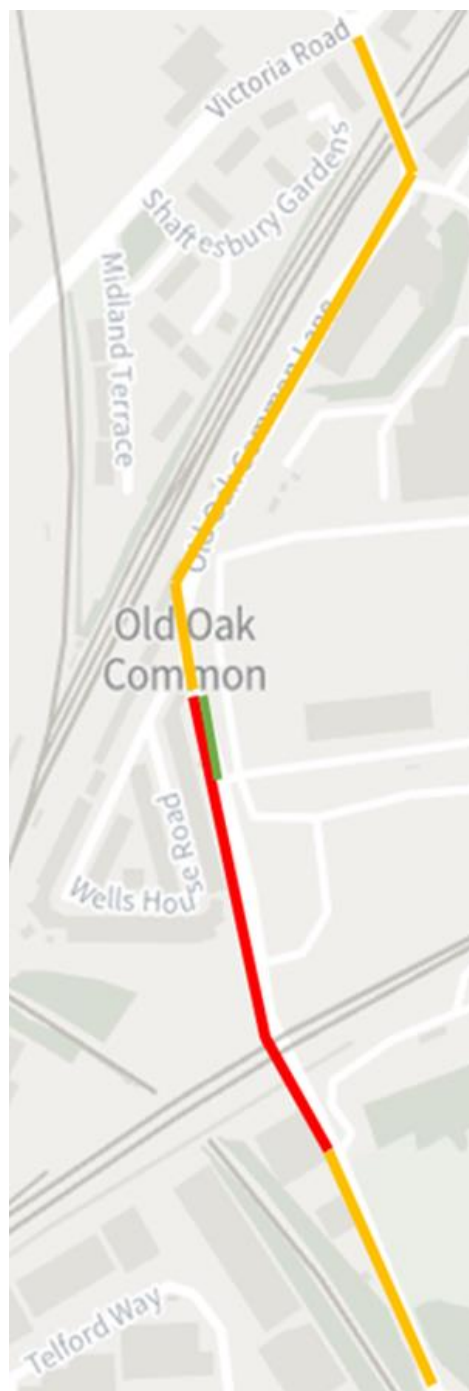

Legend

Local access only

Site access only

Full road closure



Myth busting

Will pedestrian access be maintained?

The footpath will remain open for pedestrian and accessible access (such as wheelchairs and prams). However, occasionally it will be closed to allow for work to take place where it would be unsafe to allow people to walk along. We anticipate this will only be for short periods of time (for example when we use a large crane to install new bridges). We will make sure that any closures are communicated in advance.



Will there be local access on Old Oak Common Lane?

Yes. Local vehicular access from Atlas Road roundabout will be available for residents, guests, businesses and deliveries for properties off of Old Oak Common Lane. On the south side of the closure there will be vehicular and pedestrian access to Minsters and Walking on Wood.



How long will Old Oak Common Lane be closed?

We are currently exploring a number of options to undertake the works on Old Oak Common Lane, and we're at the very beginning of this process. **No decisions have been made** and we will be working closely with the local authorities, TfL, emergency services, local communities and businesses, utility companies and others to plan these works.



Community investment

The Ramadan Challenge

During the month of Ramadan, we raised £1,460 for local charity, Bubble & Squeak. Staff at Old Oak Common take part in the Ramadan Challenge each year, fasting for at least one day to raise awareness, show solidarity and support a good cause. This was the fourth year of the challenge and so far, the project has raised over £5,000 for Bubble & Squeak (2024 & 2022), Refugee Education UK (2023) and Acton Homeless Concern (2021).

Adding a splash of colour

In June, 15 volunteers from BBVS subcontractors Expanded and Select spent the day at Old Oak Common Primary School, helping to brighten up their outdoor space.



HS2 Community and Business Funds

HS2 has created the Community and Environment Fund (CEF) and the Business and Local Economy Fund (BLEF) to aid community groups and business partnerships impacted by the construction of the new railway.

To date, the programme has invested £16.09m and supported 285 projects. There have been 18 awards in the boroughs of Brent, Ealing and Hammersmith & Fulham including a £56,000 grant awarded to Bikeworks.



To find out more about the funds and who is eligible, scan the QR code here.



Bikeworks – a much loved social enterprise which encourages the elderly, less mobile and those with disabilities to get outdoors and experience cycling – has secured its financial future for two more years thanks to HS2 grant funding.

Future works

As we move forward with the construction of Old Oak Common Station, we have previously provided information regarding our future works in the area. These notified works include:

- Utility trial holes on Old Oak Common Lane
- Conveyor belt removal and construction of cable bridge which includes weekend road closures and overnight work.

For updates on future works or to find out what's happening in your area, visit:

www.hs2.org.uk/in-your-area/



Scan the QR code for a sneak peek at the future Old Oak Common Station

Opportunity to engage

Once the local access and road closure plan has been finalised, we will be arranging community drop in events to share the information and give you the opportunity to speak to the teams from BBVS and HS2. More information on these engagements will be provided in the next Old Oak Common Lane newsletter at the end of the summer.

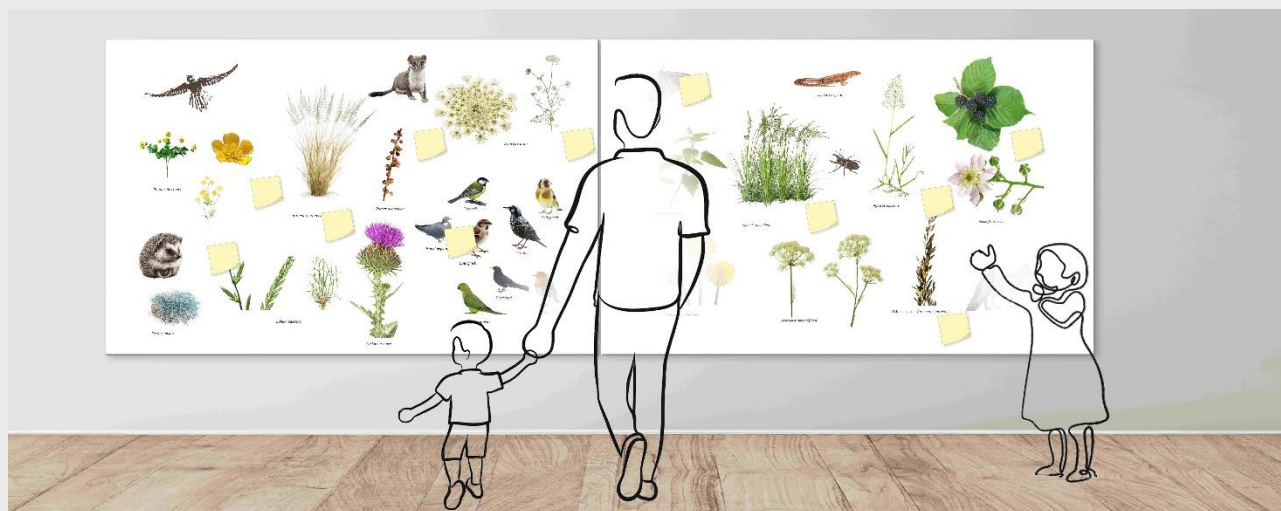

Keeping you informed

We are committed to keeping you informed about work on HS2. This includes ensuring you know what to expect and when to expect it, as well as how we can help you.

The Residents' Commissioner

The independent Residents' Commissioner oversees and monitors our commitments to you.

The commissioner's reports and our responses can be found at www.gov.uk/government/collections/hs2-ltd-residents-commissioner

The Residents' Commissioner makes sure we fulfil the commitments in the HS2 Community Engagement Strategy (<https://bit.ly/3oOA25j>).

The Residents' Commissioner can be contacted on: residentscommissioner@hs2.org.uk

Construction Commissioner

The independent Construction Commissioner regularly meets our Chief Executive Officer to raise any concerns or emerging trends across HS2.

The Construction Commissioner's role has been developed to monitor the way we manage and respond to construction complaints.

The commissioner mediates on disputes about construction, involving individuals and organisations, that we can't resolve. The commissioner advises members of the public about how to make a complaint about construction.

The Construction Commissioner can be contacted on: complaints@hs2-cc.org.uk

Property and compensation

You can find out about HS2 and properties along the route by visiting:

www.gov.uk/government/collections/hs2-property

Find out if you can claim compensation at:

www.gov.uk/claim-compensation-if-affected-by-hs2

Holding us to account

If you are unhappy for any reason you can make a complaint by contacting the HS2 Helpdesk. For more details on our complaints process, please visit:

www.hs2.org.uk/in-your-area/contact-us/how-to-complain/

Contact us

Contact our HS2 Helpdesk team all day, every day of the year on:



Freephone **08081 434 434**



Minicom **08081 456 472**



Email **HS2enquiries@hs2.org.uk**

Write to:

FREEPOST

HS2 Community Engagement

Website **www.hs2.org.uk**

To keep up to date with what is happening in your local area, visit:
www.HS2inyourarea.co.uk

Please contact us if you'd like a free copy of this document in large print, Braille, audio or 'easy read' format. You can also contact us for help and information in a different language.

HS2 Ltd is committed to protecting personal information. If you wish to know more about how we use your personal information please see our Privacy Notice: <https://www.gov.uk/government/publications/high-speed-two-ltd-privacy-notice>

Reference number: HS2-MW-BBVS-Ph1-OOC-St-S4-CR-47-16/07/2024

High Speed Two (HS2) Limited, registered in England and Wales.

Registered office: Two Snowhill, Snow Hill Queensway, Birmingham B4 6GA.

Company registration number: 06791686. VAT registration number: 888 8512 56