

Notification



Update on platform decking works, Mandeville Road Vent Shaft site

October 2024 | www.hs2.org.uk

High Speed Two (HS2) is the new high speed railway for Britain.

You can sign up for regular updates in your local area at HS2inbrentandealing.co.uk

What we are doing

We wrote to you on 4 October 2024 to let you know that between the 21 and 25 October 2024, we would be installing a platform between the sheet piles at the northern end of the site. See image below. The platform will be used for storage of materials that we need to relocate in preparation for future works.

Due to delays in finalising design for these works they are now to be carried out from 28 October to 1 November 2024. All works will be during our core working hours of Monday to Friday 8am to 6pm. We will keep you updated if dates change.

During these dates we will be using cutting and grinding tools to erect the steelwork. You may notice more noise from the tools we'll be using. We will use noise reducing barriers to help keep noise and vibration to a minimum.

We would like to apologise for any disruption or inconvenience this may cause. Every effort is being taken to ensure that these works are carried out in the least impactful way. We will keep disruption to a minimum.

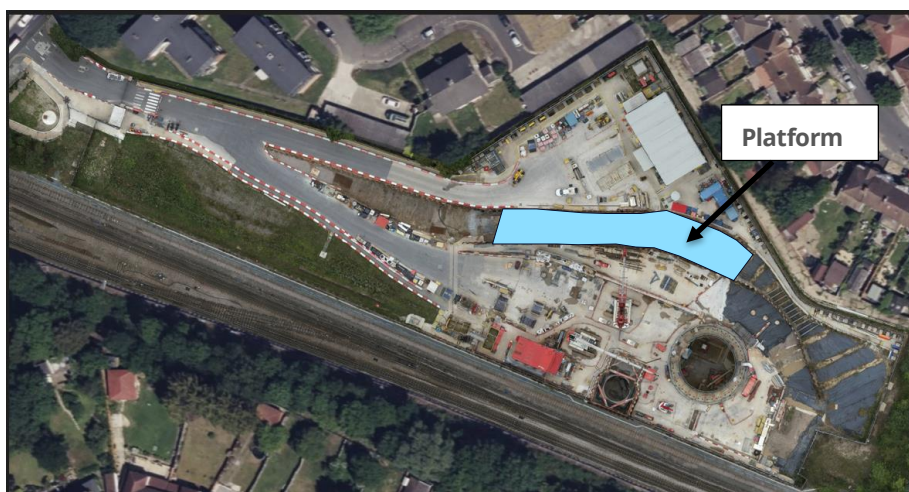

If you have a question about HS2 or our works, please contact our HS2 Helpdesk team on 08081 434 434 or email hs2enquiries@hs2.org.uk

Duration of works

28 October to
1 November 2024

Working hours

Monday to Friday
8am to 6pm

What to expect

You may notice noise and vibration from the construction machinery

What we will do

Use acoustic barriers around the machinery to help reduce noise

Dates mentioned in this notification may change. We will provide updates at:
HS2inbrentandealing.co.uk

Keeping you informed

We are committed to keeping you informed about work on HS2. This includes ensuring you know what to expect and when to expect it, as well as how we can help.

Residents' Charter and Commissioner

The Residents' Charter is our promise to communicate as clearly as we possibly can with people who live along or near the HS2 route.
www.gov.uk/government/publications/hs2-residents-charter

We also have an independent Residents' Commissioner whose job is to make sure we keep to the promises we make in the Charter and to keep it under constant review. Find reports at:
www.gov.uk/government/collections/hs2-ltd-residents-commissioner

You can contact the Commissioner at:
residentscommissioner@hs2.org.uk

Construction Commissioner

The Construction Commissioner's role is to mediate and monitor the way in which HS2 Ltd manages and responds to construction complaints. You can contact the Construction Commissioner by emailing:
complaints@hs2-cc.org.uk

Property and compensation

You can find out all about HS2 and properties along the line of route by visiting:
www.gov.uk/government/collections/hs2-property
Find out if you're eligible for compensation at:
www.gov.uk/claim-compensation-if-affected-by-hs2

Holding us to account

If you are unhappy for any reason you can make a complaint by contacting our HS2 Helpdesk team. For more details on our complaints process, please visit our website:
www.hs2.org.uk/how-to-complain

Contact Us

Contact our HS2 Helpdesk team all day, every day of the year on:

 Freephone **08081 434 434**

 Minicom **08081 456 472**

 Email **hs2enquiries@hs2.org.uk**

Write to:

FREEPOST

HS2 Community Engagement

Website **www.hs2.org.uk**

To keep up to date with what is happening in your local area, visit:
www.hs2inyourarea.co.uk

Please contact us if you'd like a free copy of this document in large print, Braille, audio or easy read. You can also contact us for help and information in a different language.

HS2 Ltd is committed to protecting personal information. If you wish to know more about how we use your personal information please see our Privacy Notice
<https://www.gov.uk/government/publications/high-speed-two-ltd-privacy-notice>

Reference number: HS2-EW-SCS-Ph1-Ar-So-S2-Prog-Works-1-09/08/2024_2

High Speed Two (HS2) Limited, registered in England and Wales.
Registered office: Two Snowhill, Snow Hill Queensway, Birmingham B4 6GA.
Company registration number: 06791686. VAT registration number: 888 8512 56.

Call our HS2 Helpdesk team on **08081 434 434**