



Notice of road closure, Truggist Lane – Balsall Common/Berkswell

May 2024 | www.hs2.org.uk

High Speed Two (HS2) is the new high speed railway for Britain. Balfour Beatty VINCI (BBV) is working in partnership with HS2 Ltd to build the new high-speed railway in your area.

The work we will be doing

The new railway will pass over Truggist Lane and Bayleys Brook on an elevated structure known as a viaduct. Either side of Truggist Lane will be one of the viaducts piers that are supported by pile foundations. In March we closed Truggist Lane to construct the pile foundation using a rotary piling machine to excavate the earth, insert reinforcements and fill with concrete. We now need to install 'sheet piling' next to the road. Sheet piling enables us to work close to the road without destabilising the carriageway.

In order to do this safely we will need to close the road on 14 June from 9am until 3pm, then from 17 June until 21 June from 9am until 3pm each day. A fully signed diversion will be in place.

Please note that it is a requirement that when Truggist Lane is closed Baulk Lane must also be closed.

Location plan

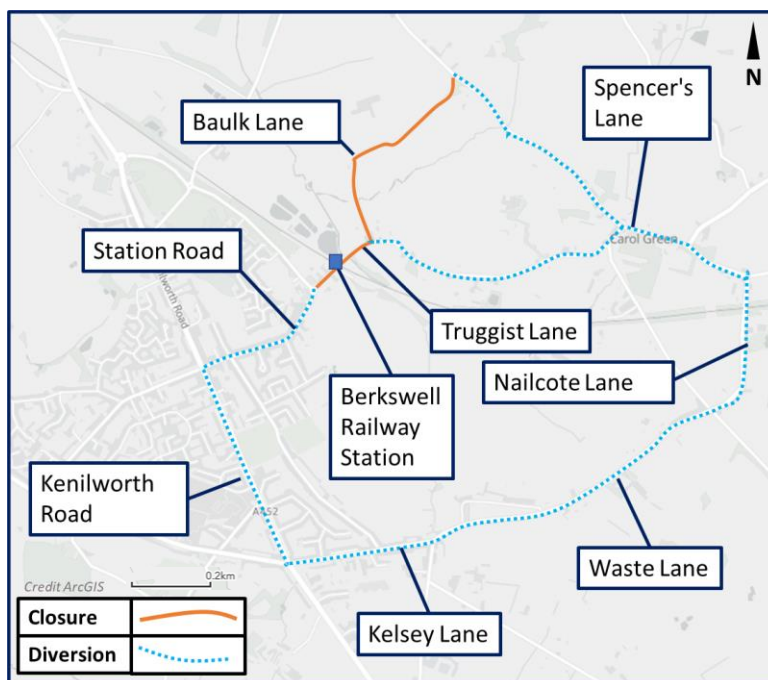

Duration of works

The road will be closed on 14 June from 9am until 3pm, then from 17 June until 21 June from 9am until 3pm each day.

What to expect

This installation works will be heard – Noise levels will be monitored.

Longer journey times following diversion - Allow 5 minutes.

What we will do

Keep you up to date with any changes at www.hs2insolihull.co.uk

Keep all sites safe and secure.

Keeping you informed

We are committed to keeping you informed about work on HS2. This includes ensuring you know what to expect and when to expect it, as well as how we can help you.

The Residents' Commissioner

The independent Residents' Commissioner oversees and monitors our commitments to you.

The commissioner's reports and our responses can be found at www.gov.uk/government/collections/hs2-ltd-residents-commissioner

The Residents' Commissioner makes sure we fulfil the commitments in the HS2 Community Engagement Strategy (<https://bit.ly/3oOA25j>).

The Residents' Commissioner can be contacted on: residentscommissioner@hs2.org.uk

Construction Commissioner

The independent Construction Commissioner regularly meets our Chief Executive Officer to raise any concerns or emerging trends across HS2.

The Construction Commissioner's role has been developed to monitor the way we manage and respond to construction complaints.

The commissioner mediates on disputes about construction, involving individuals and organisations, that we can't resolve. The commissioner advises members of the public about how to make a complaint about construction.

The Construction Commissioner can be contacted on: complaints@hs2-cc.org.uk

Property and compensation

You can find out about HS2 and properties along the route by visiting: www.gov.uk/government/collections/hs2-property

Find out if you can claim compensation at: www.gov.uk/claim-compensation-if-affected-by-hs2

Holding us to account

If you are unhappy for any reason you can make a complaint by contacting the HS2 Helpdesk. For more details on our complaints process, please visit: www.hs2.org.uk/in-your-area/contact-us/how-to-complain/

Contact us

Contact our HS2 Helpdesk team all day, every day of the year on:

 Freephone **08081 434 434**

 Minicom **08081 456 472**

 Email **HS2enquiries@hs2.org.uk**

Write to:

FREEPOST

HS2 Community Engagement

Website **www.hs2.org.uk**

To keep up to date with what is happening in your local area, visit: **www.HS2inyourarea.co.uk**

Please contact us if you'd like a free copy of this document in large print, Braille, audio or 'easy read' format. You can also contact us for help and information in a different language.

HS2 Ltd is committed to protecting personal information. If you wish to know more about how we use your personal information please see our Privacy Notice: <https://www.gov.uk/government/publications/high-speed-two-ltd-privacy-notice>

Reference number: HS2-MW-BBV-Ph1-Ar-No-N1-Traf-05-11/05/2024

High Speed Two (HS2) Limited, registered in England and Wales.

Registered office: Two Snowhill, Snow Hill Queensway, Birmingham B4 6GA.

Company registration number: 06791686. VAT registration number: 888 8512 56