



## UPDATE -Notice of completion works to new A452/A446 junction – Marston Green

April 2024 | [www.hs2.org.uk](http://www.hs2.org.uk)

High Speed Two (HS2) is the new high speed railway for Britain. Balfour Beatty VINCI (BBV) is working in partnership with HS2 Ltd to build the new high-speed railway in your area.

### UPDATE

We previously advised that between 20 May and 24 May there would be overnight closures on part of the northbound A452 and on the northbound slip road these closures are likely to continue until 31 May. Full details below.

### The work we will be doing

BBV have been significantly reconfiguring the junction of the A446 Stonebridge Road and A452 Chester Road near Birmingham Business Park to facilitate the construction of a bridge that will take the new railway over the M42. As this work comes near to completion, we will be undertaking a series of finishing works that will include tree planting landscaping, new signage, new street furniture, permanent footpaths and other improvements to the public realm. This work can be largely completed without impacting the flow of traffic however some work will require us to close part of the road. To avoid unnecessary disruption this will either be done under lane closure or at night or weekend and in manageable phases.

### When will this work take place

#### 2 April -19 April

Between 2 April and 19 April there will be full overnight closures on the southbound slip road of the A446 known as Biddle's Loop. The road will be closed from 8pm until 6am. A full diversion will be in place.

#### 5 April – 8 April

Between 5 April and 8 April there will be a full weekend closure of the A446 northbound slip road of Biddle's Loop from 8pm on 5 April until 6am on 8 April. A full diversion will be in place.

#### 20 May -31 May

Between 20 May and 31 May there will be full overnight closures on part of the northbound A452 in front of Melbicks Garden Centre and the A446 northbound slip road of Biddle's Loop from 8pm until 6am. A full diversion will be in place. Please note on 30 May we will not close the road until 11:30pm to allow easier departure for concert goers leaving the NEC.

#### 17 May – 14 June

From 17 May until 7 June, one lane of the A452 southbound slip road will be closed.

### Duration of works

From 2 April until 14 June in four phases.

### What to expect

Overnight closures, weekend closures and lane closures

Fully signed diversions when needed – Allow 10 minutes when following diversion

Low Level Noise from our work

### What we will do

Keep you up-to-date with any changes at [www.hs2insolihull.co.uk](http://www.hs2insolihull.co.uk)

Keep all sites safe and secure.

# Notice of completion works to new A452/A456 junction – Marston Green

[www.hs2.org.uk](http://www.hs2.org.uk)

**2 April -19 April**

Between 2 April and 19 April there will be full overnight closures on the southbound slip road of the A446 known as Biddle's Loop. The road will be closed from 8pm until 6am. A full diversion will be in place.

Notification

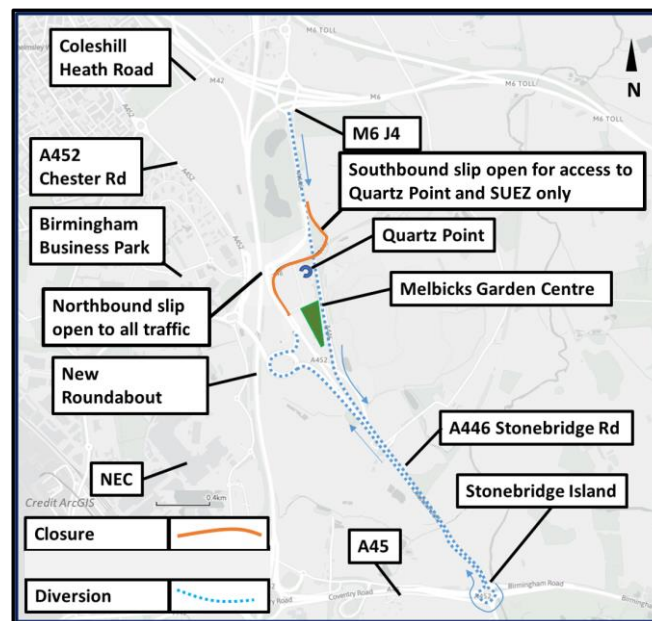

**5 April – 8 April**

Between 5 April and 8 April there will be a full weekend closure of the A446 northbound slip road of Biddle's Loop from 8pm on 5 April until 6am on 8 April. A full diversion will be in place.

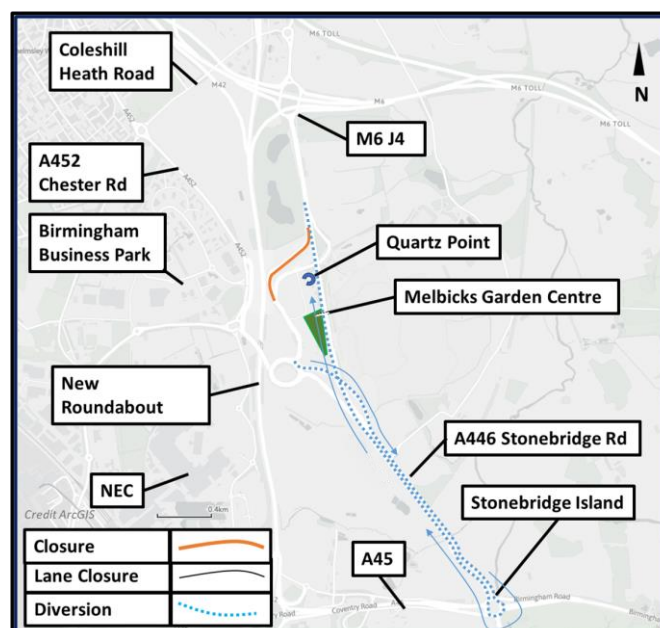

Contact our HS2 Helpdesk team on **08081 434 434**

# Notice of completion works to new A452/A456 junction – Marston Green

[www.hs2.org.uk](http://www.hs2.org.uk)

Notification



## 20 May -31 May

Between 20 May and 31 May there will be full overnight closures on part of the Northbound A452 in front of the Garden Centre and the A446 northbound slip road of Biddle's Loop from 8pm until 6am. A full diversion will be in place. Please note on 30 May we will not close the road until 11:30pm to allow easier departure for concert goers leaving the NEC.

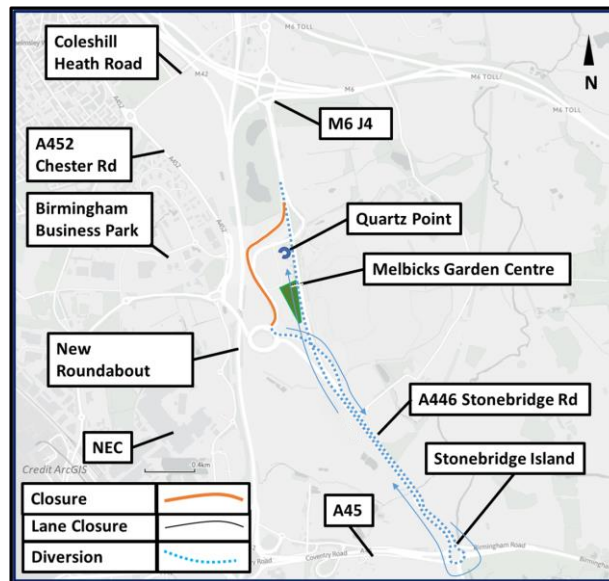

## 17 May – 14 June

From 17 May until 14 June, one lane of the A452 will be closed in both directions.

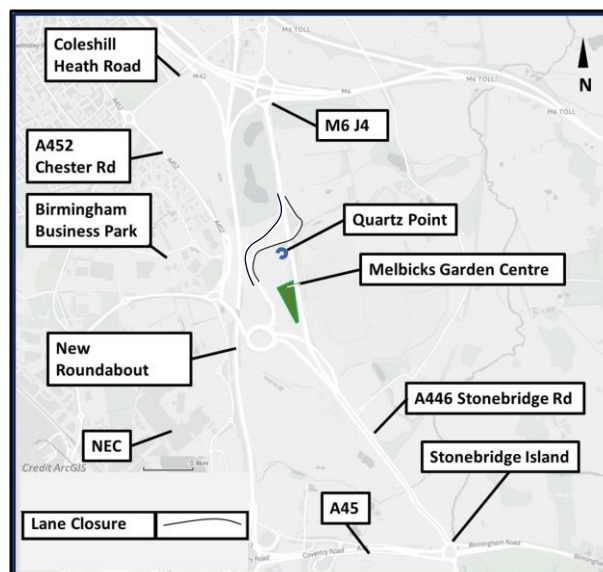

Contact our HS2 Helpdesk team on **08081 434 434**

# Keeping you informed

We are committed to keeping you informed about work on HS2. This includes ensuring you know what to expect and when to expect it, as well as how we can help you.

## The Residents' Commissioner

The independent Residents' Commissioner oversees and monitors our commitments to you.

The commissioner's reports and our responses can be found at [www.gov.uk/government/collections/hs2-ltd-residents-commissioner](http://www.gov.uk/government/collections/hs2-ltd-residents-commissioner)

The Residents' Commissioner makes sure we fulfil the commitments in the HS2 Community Engagement Strategy (<https://bit.ly/3oOA25j>).

The Residents' Commissioner can be contacted on: [residentscommissioner@hs2.org.uk](mailto:residentscommissioner@hs2.org.uk)

## Construction Commissioner

The independent Construction Commissioner regularly meets our Chief Executive Officer to raise any concerns or emerging trends across HS2.

The Construction Commissioner's role has been developed to monitor the way we manage and respond to construction complaints.

The commissioner mediates on disputes about construction, involving individuals and organisations, that we can't resolve. The commissioner advises members of the public about how to make a complaint about construction.

The Construction Commissioner can be contacted on: [complaints@hs2-cc.org.uk](mailto:complaints@hs2-cc.org.uk)

## Property and compensation

You can find out about HS2 and properties along the route by visiting:

[www.gov.uk/government/collections/hs2-property](http://www.gov.uk/government/collections/hs2-property)

Find out if you can claim compensation at:

[www.gov.uk/claim-compensation-if-affected-by-hs2](http://www.gov.uk/claim-compensation-if-affected-by-hs2)

## Holding us to account

If you are unhappy for any reason you can make a complaint by contacting the HS2 Helpdesk. For more details on our complaints process, please visit:

[www.hs2.org.uk/in-your-area/contact-us/how-to-complain/](http://www.hs2.org.uk/in-your-area/contact-us/how-to-complain/)

## Contact us

Contact our HS2 Helpdesk team all day, every day of the year on:

 Freephone **08081 434 434**

 Minicom **08081 456 472**

 Email **HS2enquiries@hs2.org.uk**

Write to:

**FREEPOST**

**HS2 Community Engagement**

Website **[www.hs2.org.uk](http://www.hs2.org.uk)**

To keep up to date with what is happening in your local area, visit:  
**[www.HS2inyourarea.co.uk](http://www.HS2inyourarea.co.uk)**

**Please contact us if you'd like a free copy of this document in large print, Braille, audio or 'easy read' format. You can also contact us for help and information in a different language.**

HS2 Ltd is committed to protecting personal information. If you wish to know more about how we use your personal information please see our Privacy Notice:

<https://www.gov.uk/government/publications/high-speed-two-ltd-privacy-notice>

**Reference number: HS2-MW-BBV-Ph1-Ar-No-N1-Traf-34-24/02/2024**

High Speed Two (HS2) Limited, registered in England and Wales.

Registered office: Two Snowhill, Snow Hill Queensway, Birmingham B4 6GA.

Company registration number: 06791686. VAT registration number: 888 8512 56