

SKANSKA



STRABAG

Working in
partnership with

HS2

A40 Western Avenue

Gas Upgrade Works

Agenda

Item	Topic
1	Delivering HS2 London Tunnels
2	Gas mitigation works and construction programme
3	Traffic management descriptions and layouts
4	Measures in place to reduce disruption
5	Other utility works in the area
6	Keeping you informed
7	Questions



Delivering HS2 London Tunnels

Skanska Costain STRABAG Joint Venture (SCSJV) are working in partnership with HS2 Ltd to build 16.4 miles (26.4 kilometres) of the high-speed railway between Euston and West Ruislip.

This includes 13 miles (21 kilometres) of tunnels and the associated ventilation (vent) shafts and headhouses to provide access to the tunnels for maintenance and emergency services, ventilation and power supply.



Works on A40 Western Avenue

What we are doing

From 6 May to 30 September 2024, we will be carrying out works to protect the mains gas pipe below the A40 Western Avenue between Alperton Lane and Hanger Lane Gyratory prior to construction of the HS2 London Tunnels.

During these dates, there will be phased traffic management in place on the A40 Western Avenue including:

- Lane closures
- Contraflow system to maintain traffic flow
- Diversion over Hanger Lane Gyratory due to A40 tunnel closure

Indicative construction programme

Construction Activity	Date
Removal of central reservation and installation of contraflow system	06 May to 02 June 2024*
Contraflow system in operation and gas upgrade works commence	03 June to 25 August 2024*
Removal of contraflow system and reinstatement of central reservation	26 August to 30 September 2024*

Works on the A40 Western Avenue

The main gas pipe crosses the A40 from Lynwood Road towards West Gate. The excavation area will progress from south to north as the current main is replaced. The excavation in the first section should take around three weeks, and the remaining sections should take around two weeks each.

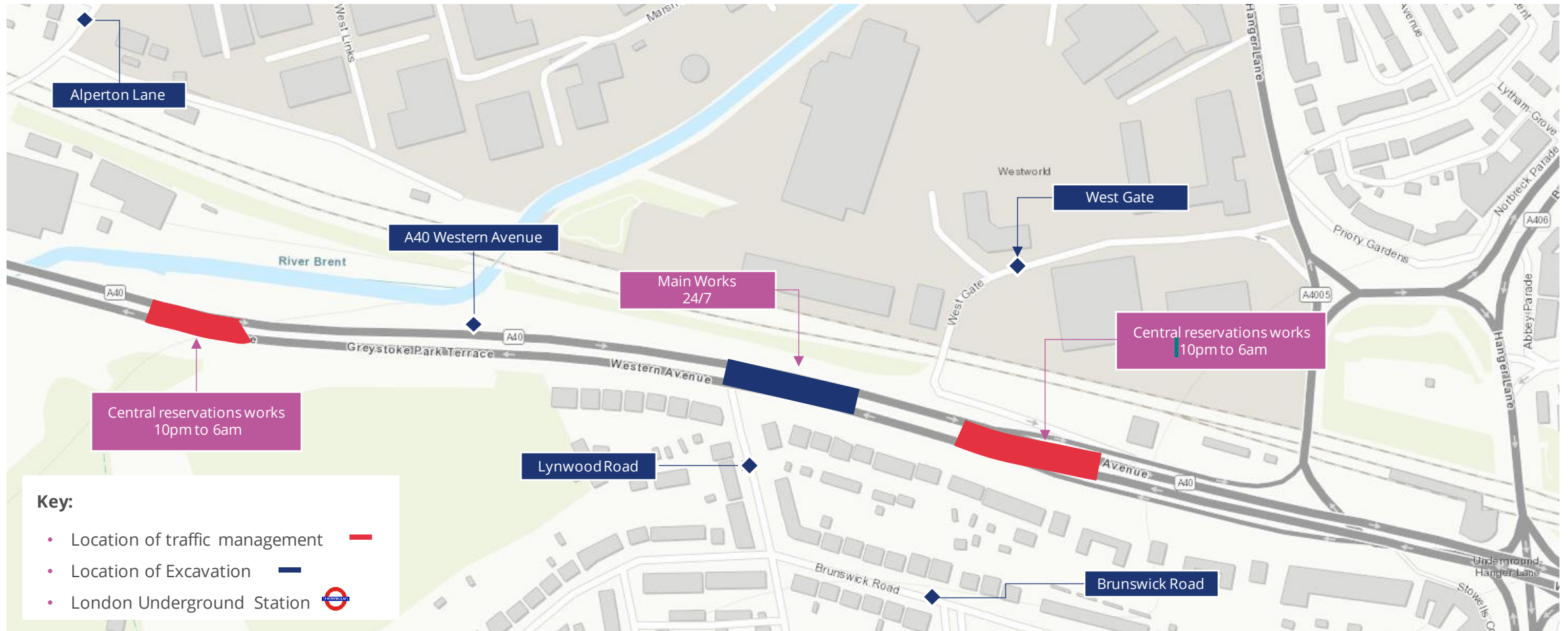

Traffic Management

Phase 1 – 06 May to 02 June 2024*

What will we be doing?

We will be carrying out overnight works to build and construct two crossover sections for a contraflow system which will be used during the upgrade of the main gas pipe. This includes the removal of the central reservation on two sections of the A40 Western Avenue.

How might this affect you?

During the day, we will have traffic management in place which will be a closure of lane three on both the East and Westbound Carriageway between the hours of 6am to 10pm*.

Overnight, we will have traffic management in place which will be a closure of lane two and three on both the East and Westbound Carriageway between the hours of 10pm to 6am*.

Additionally, the Hanger Lane Gyratory tunnels will be closed, and traffic will be diverted around Hanger Lane Gyratory.

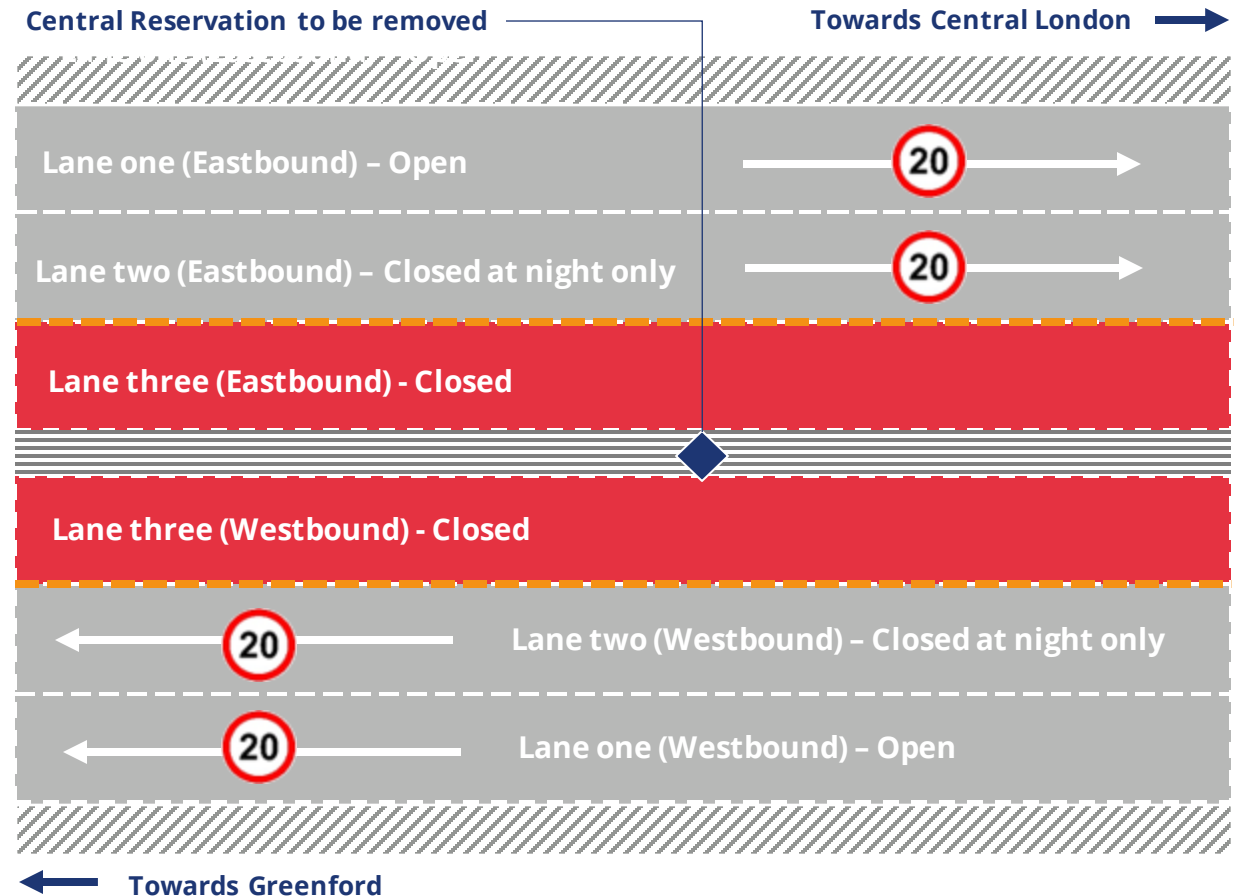

*Dates are indicative and may change.

Traffic Management

Phase 1 – 06 May to 02 June 2024*

How might this affect you?

The Eastbound and Westbound tunnels under Hanger Lane Gyratory will be closed while we work on the central reservation, and traffic will be diverted around the Gyratory.

Diversion signs and information will be clearly visible.

Key:

- Location of works —
- Eastbound diversion —
- Westbound diversion —
- London Underground Station



Traffic Management

Phase 2 – 03 to 23 June 2024*

What will we be doing?

We will be carrying out works to protect the mains gas pipe below the A40 Western Avenue between Alperton Lane and Hanger Lane Gyratory prior to construction of the HS2 London Tunnels.

How might this affect you?

During the day and night, we will have traffic management in place. On the Westbound Carriageway, lanes one and two will be closed, while lane three will be used for traffic travelling Westbound. On the Eastbound carriageway, lane three will be used for traffic travelling Westbound, and lane one and two will be for traffic travelling Eastbound.

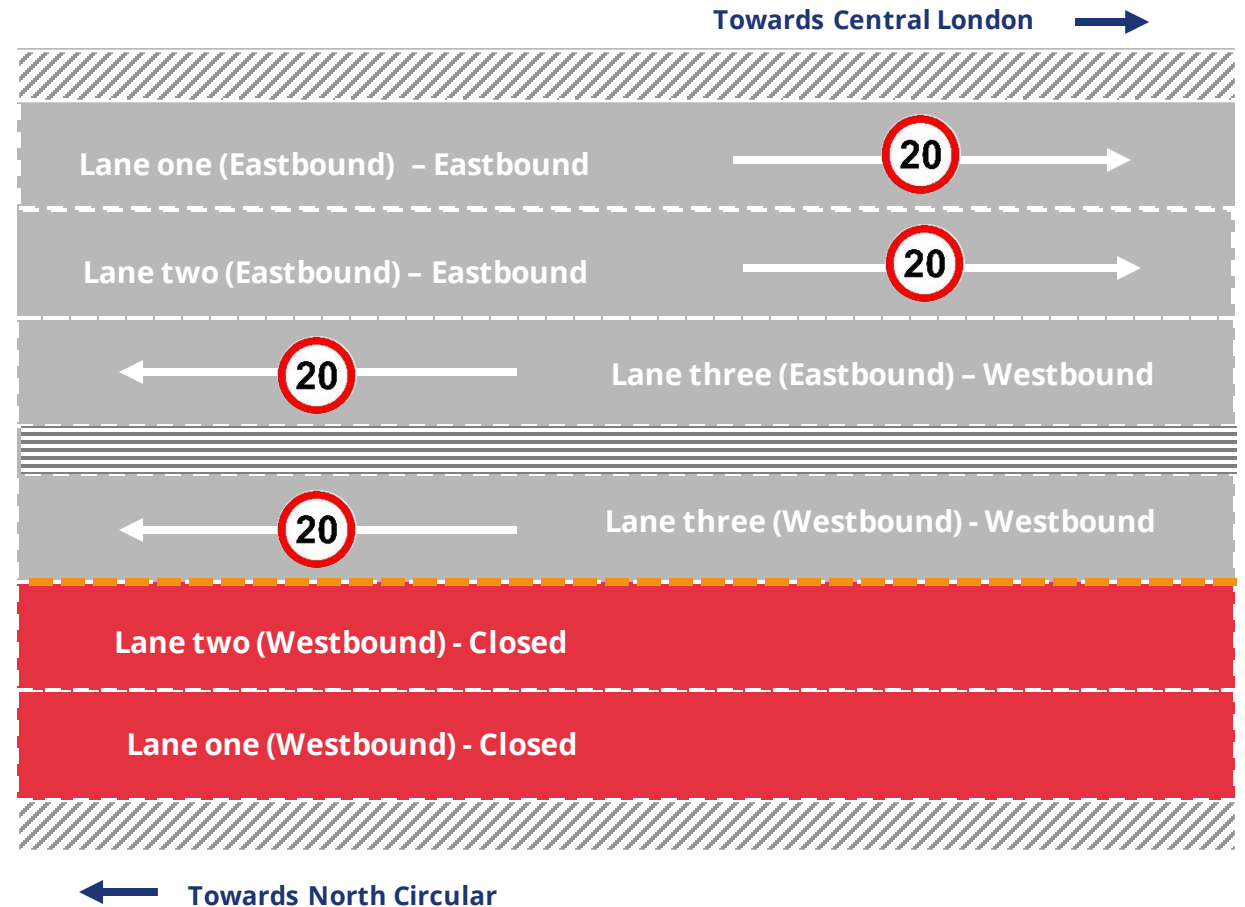

*Dates are indicative and may change.

Parking bay suspensions

From 1 to 24 June 2024*



*Dates are indicative and may change.

Traffic Management

Phase 3 – 24 June to 07 July 2024*

What will we be doing?

We will be carrying out works to protect the mains gas pipe below the A40 Western Avenue between Alperton Lane and Hanger Lane Gyratory prior to construction of the HS2 London Tunnels.

How might this affect you?

During the day and night, we will have traffic management in place. On the Westbound Carriageway, lanes two and three will be closed, while lane one will be used for traffic travelling Westbound. On the Eastbound carriageway, lane three will be used for traffic travelling Westbound, while lanes one and two will be for traffic travelling Eastbound.

Once drivers enter one of the Westbound lanes, they will have to follow it through to the end of the works area, after which they will be able to switch between lanes again.

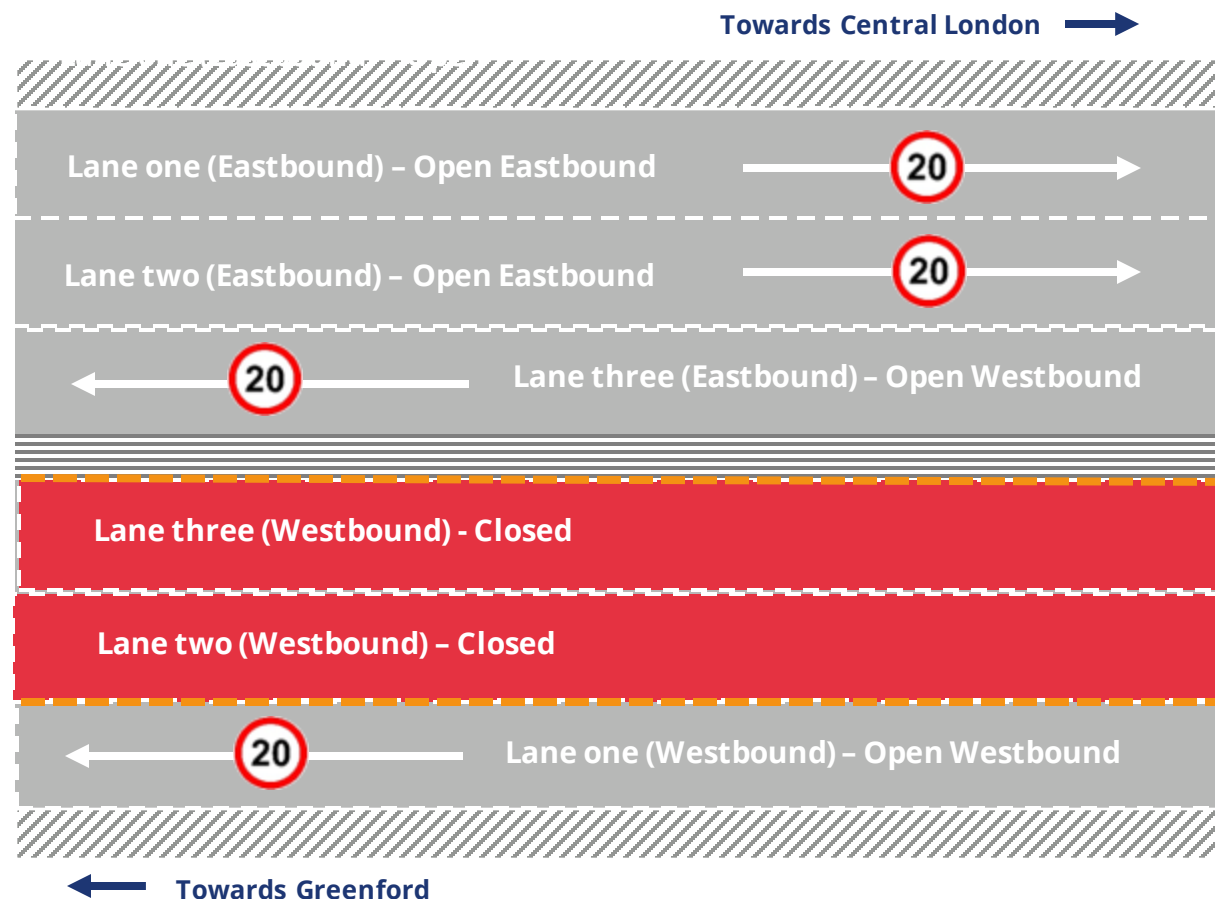

Traffic Management

Phase 4 – 08 to 21 July 2024*

What will we be doing?

We will be carrying out works to protect the mains gas pipe below the A40 Western Avenue between Alperton Lane and Hanger Lane Gyratory prior to construction of the HS2 London Tunnels.

How might this affect you?

During the day and night, we will have traffic management in place. On the Westbound Carriageway, lane three will be closed, while lanes one and two will be used for traffic travelling Westbound. On the Eastbound carriageway, lane three will be closed, while lanes one and two will be used for traffic travelling Eastbound.

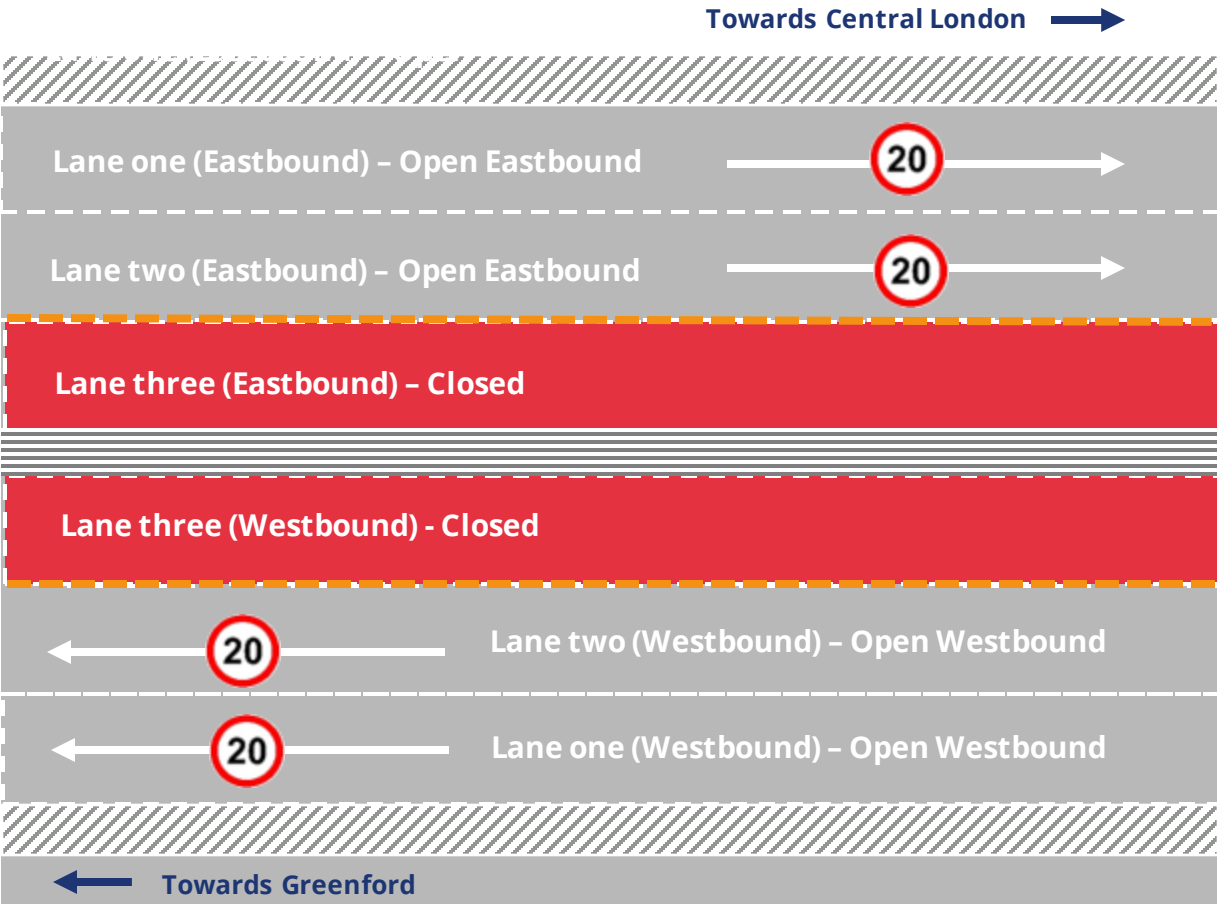

*Dates are indicative and may change.

Traffic Management

Phase 5 – 22 July to 04 August 2024*

What will we be doing?

We will be carrying out works to protect the mains gas pipe below the A40 Western Avenue between Alpertons Lane and Hanger Lane Gyratory prior to construction of the HS2 London Tunnels.

How might this affect you?

During the day and overnight, we will have traffic management in place. On the Westbound Carriageway, lanes one and two will be used for traffic travelling Westbound, while lane three will be used for traffic travelling Eastbound. On the Eastbound carriageway, lanes two and three will be closed, while lane one will be used for traffic travelling Eastbound.

Drivers who wish to access the A406 from Hanger Lane Gyratory should use lane 1 Eastbound.

Drivers travelling into Central London should use the contraflow lane for Eastbound traffic.

Once drivers enter one of the Eastbound lanes, they will have to follow it through to the end of the works area, after which they will be able to switch between lanes again.

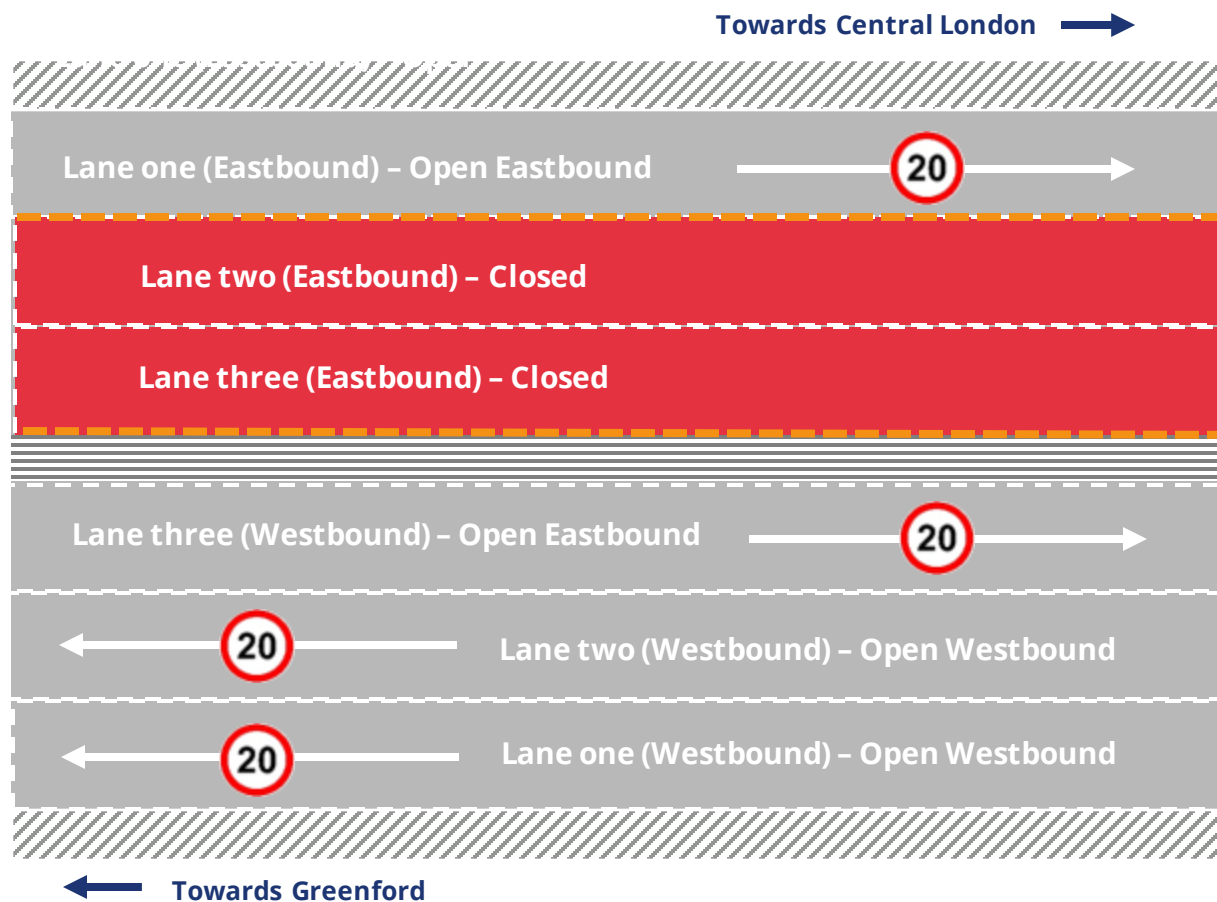

*Dates are indicative and may change.

Traffic Management

Phase 6 – 05 to 25 August 2024*

What will we be doing?

We will be carrying out works to protect the mains gas pipe below the A40 Western Avenue between Alperton Lane and Hanger Lane Gyratory prior to construction of the HS2 London Tunnels.

How might this affect you?

During the day and night, we will have traffic management in place. On the Westbound Carriageway, lanes one and two will be used for traffic travelling Westbound, while lane three will be used for traffic travelling Eastbound. On the Eastbound carriageway, lane three will be used for traffic travelling Eastbound, while lanes one will be closed.

Drivers who wish to access the A406 from Hanger Lane Gyratory should use lane 3 Eastbound.

Drivers travelling into Central London should use the contraflow lane for Eastbound traffic.

Once drivers enter one of the Eastbound lanes, they will have to follow it through to the end of the works area, after which they will be able to switch between lanes again.

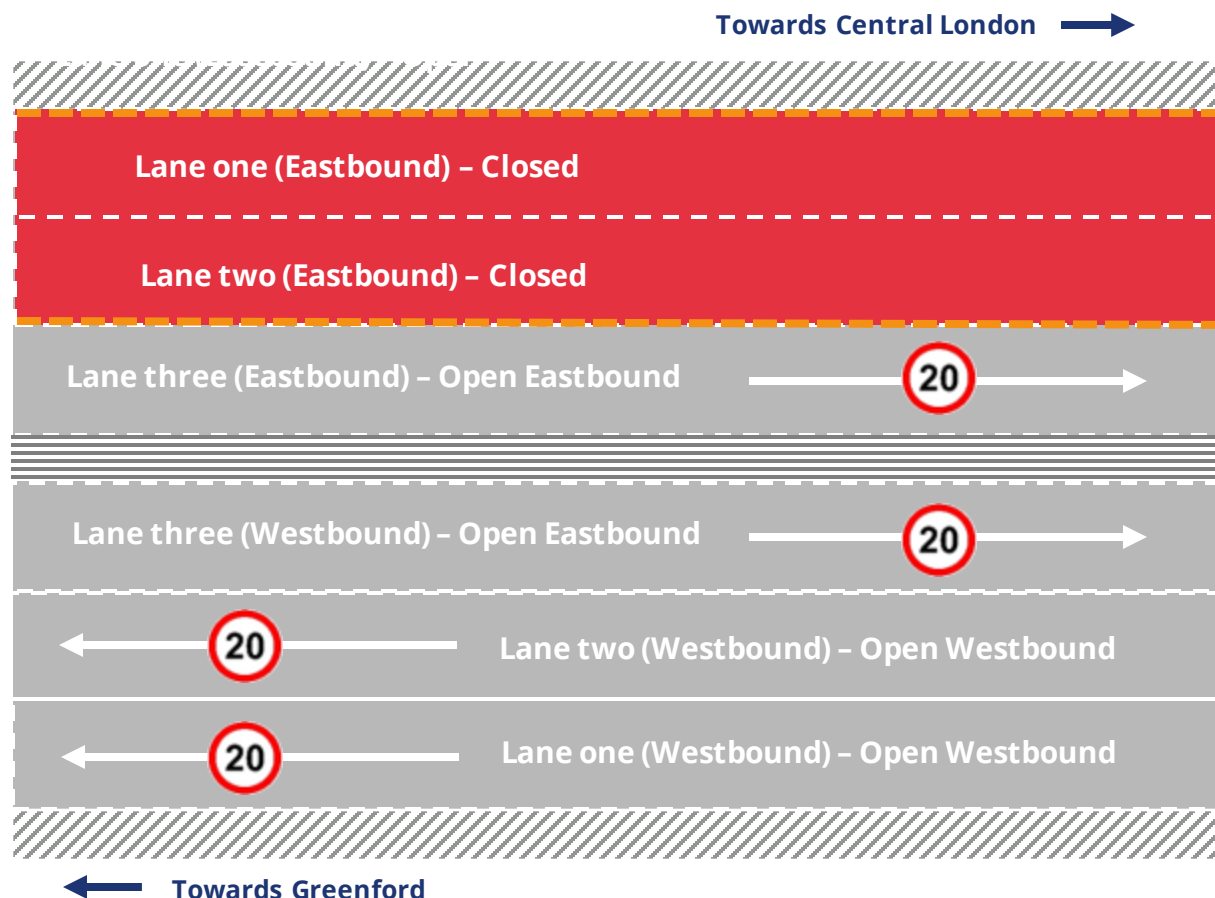

*Dates are indicative and may change.

Traffic Management

Phase 7 – 26 August to 30 September 2024*

What will we be doing?

We will be carrying out works to remove the two crossover sections and contraflow system which were used during the main works. This includes the reconstruction of the central reservation on the A40 Western Avenue.

How might this affect you?

During the day, we will have traffic management in place which will be a closure of lane three on both the East and Westbound Carriageway between the hours of 6am to 10pm*.

Overnight, we will have traffic management in place which will be a closure of lane two and three on both the East and Westbound Carriageway between the hours of 10pm to 6am*.

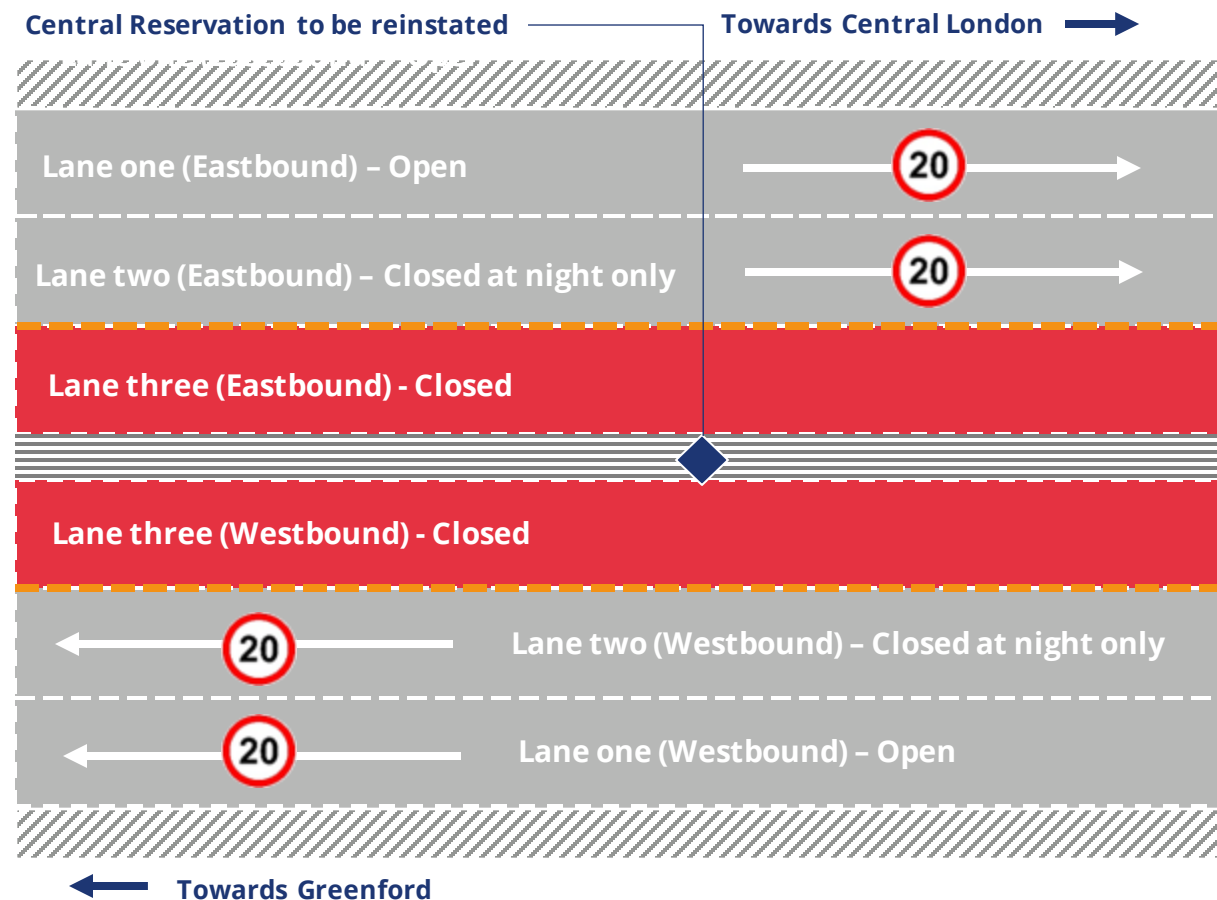

*Dates are indicative and may change.

Traffic Management

Phase 7 – 26 August to 30 September 2024*

How might this affect you?

The Eastbound and Westbound tunnels under Hanger Lane Gyratory will be closed while we work on the central reservation, and traffic will be diverted around the Gyratory.

Diversion signs and information will be clearly visible.

Key:

- Location of works
- Eastbound diversion
- Westbound diversion
- London Underground Station



*Dates are indicative and may change.

Measures to minimise disruption

Noise and Vibration

Noise levels are expected to be highest during excavation which will be taking place:

- Overnight during the removal and reinstatement of the central reservation
- During the day throughout the gas upgrade works

Noise will be managed through:

- Selective plant & equipment
- Acoustic blankets
- Equipment will be switched off when not in use
- Monitoring logs will be kept

Once excavation is complete, noise will be significantly reduced and is not expected to be louder than usual background levels.

Lighting

- All lighting will be low level and within the site focusing away from residential areas
- Lighting will be turned off when staff are not on site

Dust

- Damping down / screening
- Daily dust logs
- Stockpiles will be sheeted, and kept away from local receptors
- Vehicles entering / leaving site will not be overloaded

Other utility works in the local area

You can find below our planned utility works in the Hanger Lane area for the rest of 2024. Please note this is an indicative construction programme and further works may be added.

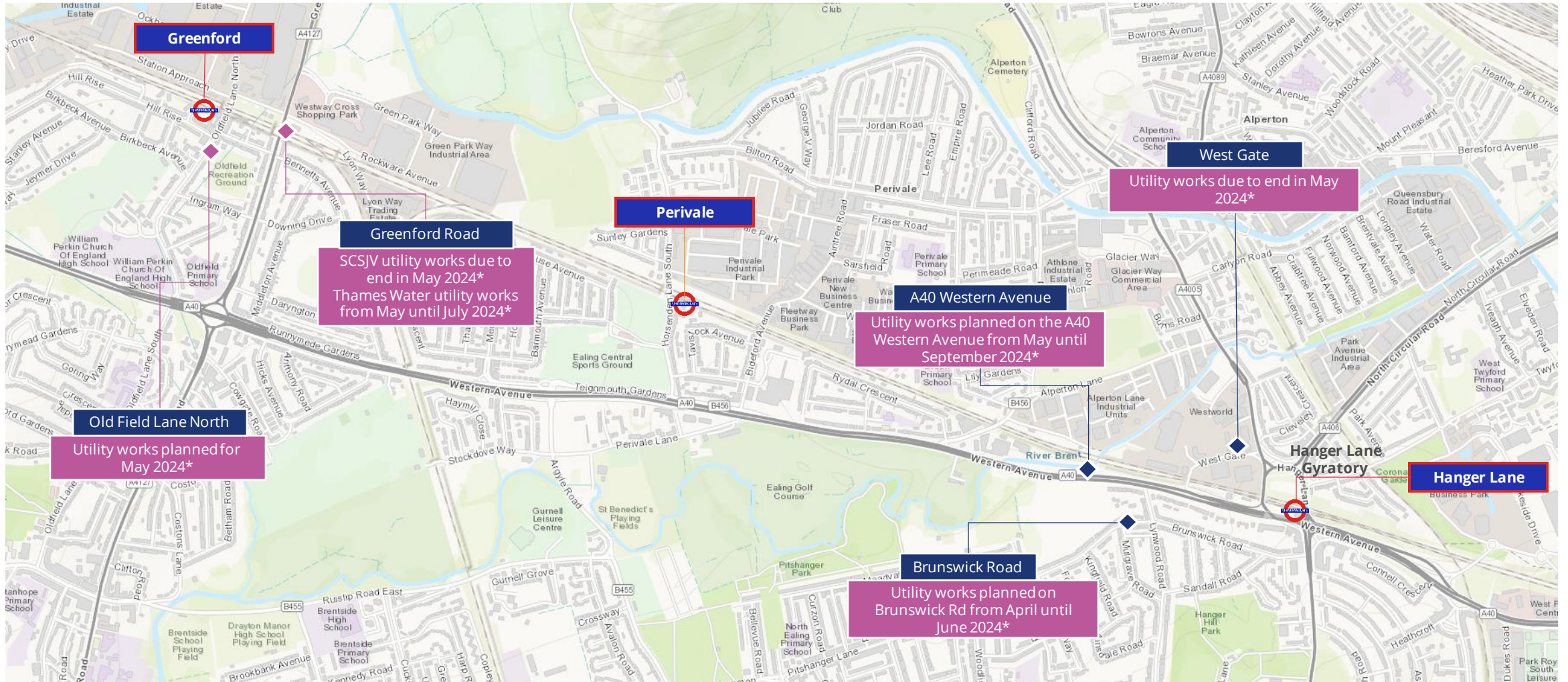

*Dates mentioned are subject to change. We will continue to provide updates at hs2.org.uk/in-your-area/map.

Keeping you informed

As part of our commitment to keeping you informed, we will continue engaging with the local community to provide regular updates on the progress of construction.

Planned engagement activity	Planned engagement date*
Updates about our works	Throughout 2024 on the HS2 updates website
Online community information event	Tuesday 23 April, 6:30 to 8pm
Monthly virtual drop-ins each month	<p>Book a 20-minute slot to speak with the community engagement team from HS2 and SCSJV on:</p> <p>Tuesday 21 May, 4pm to 6pm Tuesday 18 June, 4pm to 6pm Tuesday 16 July, 4pm to 6pm Tuesday 20 August, 4pm to 6pm Tuesday 17 September, 4pm to 6pm</p> <p>To register your attendance for one of our virtual drop-ins, please visit HS2.org.uk/events</p>

If you have a question or a concern about any of works in your local area, please contact the Helpdesk on **08081 434 434** or email **HS2enquiries@hs2.org.uk**. Our local engagement team will contact you via phone or email to discuss your question or concerns.

If you want to keep up to date with HS2 works in your area, please subscribe to [HS2 updates](#) or access the [HS2 in your area map](#).



Thank you

