

Notice of daytime lane closure A413 London Road, Wendover

February 2024 | www.hs2.org.uk

High Speed Two (HS2) is the new high speed railway for Britain, if you have any questions or enquiries about our work, please contact our Helpdesk to find out more. You can sign up for regular updates in your local area at www.hs2inyourarea.co.uk.

What are we doing?

As we move to the next phase of construction of the Small Dean Viaduct, there will be a lane closure across several dates on the A413 to facilitate movement of piling rigs to allow the rigs on to our site. During this time, we will be mobilising and demobilising Small Dean Viaduct piling works.

To carry out these works safely, the lane closures will be under a 2-way temporary traffic light system. This is for safety reasons as our operatives will be working in and around the carriage way.

To reduce impact on road users, these traffic lights will be in operation at off-peak times.

When will these works take place?

These works are scheduled for the **daytime (off-peak) between 9:00am – 3pm** on the following dates:

- Thursday 7 March
- Wednesday 27 March
- Wednesday 3 April
- Wednesday 10 April
- Monday 15 April

These dates may be subject to change due to circumstances outside of our control but works will be completed in or around the set timeframes.

If you have a question about HS2 or our works, please contact our HS2 Helpdesk team on 08081 434 434 or email hs2enquiries@hs2.org.uk

Notification



Duration of works

Daytime lane closures between 9:00am – 3pm on the following dates:

- Thursday 7 March
- Wednesday 27 March
- Wednesday 3 April
- Wednesday 10 April
- Monday 15 April

What to expect

Daytime lane closures on the A413

Various activities around the perimeter of the A413

Signposted diversion route

What we will do

Respond promptly to any complaints we may receive and action accordingly.

Manage any environmental impacts, such as traffic and noise.

Take care to respect the community.

Notice of daytime lane closure

A413 London Road, Wendover



Small Dean Viaduct construction video

To help you understand exactly what work we will be carrying out around the A413 and why it is required, we have produced a video using our 4D design model demonstrating upcoming work for the construction of Small Dean Viaduct including road diversions and utility work.

The annotations narrate each phase to keep you informed of what to expect over the coming months as work in the area ramps up. If you have any questions on the content of the video, please feel free to get in touch via the HS2 helpdesk.

The Small Dean Viaduct construction phase video can be accessed [here](#) or via the QR code.



Where is the phase 1 re-alignment?

Below is the animated example of the diversion of the A413. You can see the original road and the piers to the left and the new temporary surface to the right.

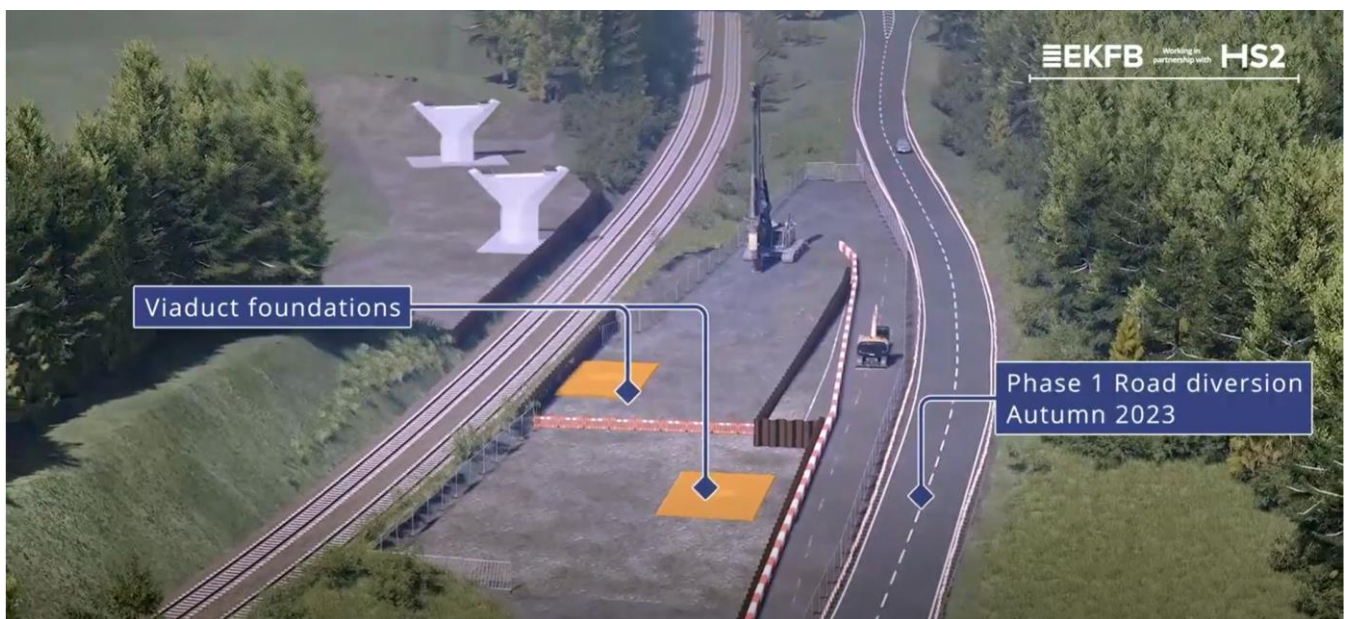

Notice of daytime lane closure A413 London Road, Wendover



Where will the closures be?

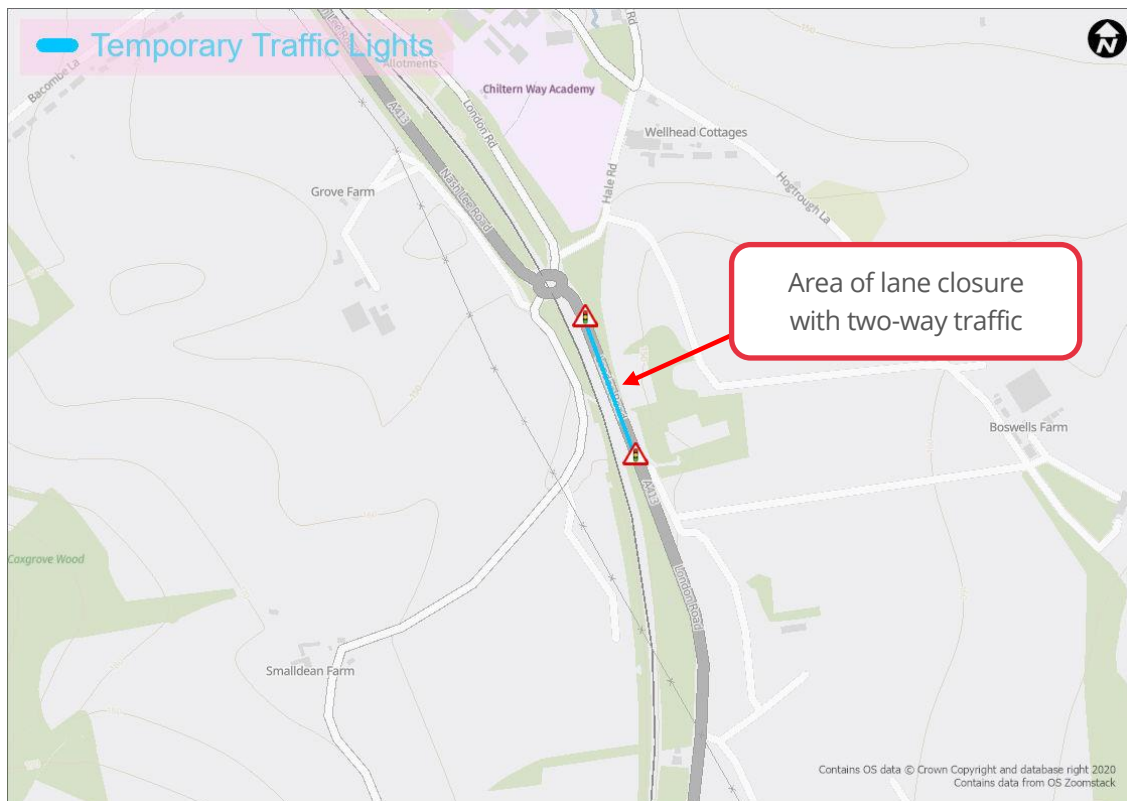

Contact our HS2 Helpdesk team on **08081 434 434**

Keeping you informed

We are committed to keeping you informed about work on HS2. This includes ensuring you know what to expect and when to expect it, as well as how we can help.

Residents' Charter and Commissioner

The Residents' Charter is our promise to communicate as clearly as we possibly can with people who live along or near the HS2 route.

www.gov.uk/government/publications/hs2-residents-charter

We also have an independent Residents' Commissioner whose job is to make sure we keep to the promises we make in the Charter and to keep it under constant review. Find reports at: www.gov.uk/government/collections/hs2-ltd-residents-commissioner

You can contact the Commissioner at: residentscommissioner@hs2.org.uk

Construction Commissioner

The Construction Commissioner's role is to mediate and monitor the way in which HS2 Ltd manages and responds to construction complaints. You can contact the Construction Commissioner by emailing:

complaints@hs2-cc.org.uk

Property and compensation

You can find out all about HS2 and properties along the line of route by visiting:

www.gov.uk/government/collections/hs2-property

Find out if you're eligible for compensation at:

www.gov.uk/claim-compensation-if-affected-by-hs2

Holding us to account

If you are unhappy for any reason you can make a complaint by contacting our HS2 Helpdesk team.

For more details on our complaints process, please visit our website:

www.hs2.org.uk/how-to-complain

Reference number: HS2-MW-EK-Ph1-Ar-Ce-C1-Traf-31-22/02/2024

High Speed Two (HS2) Limited, registered in England and Wales.

Registered office: Two Snowhill, Snow Hill Queensway, Birmingham B4 6GA.

Company registration number: 06791686. VAT registration number: 888 8512 56.

Contact Us

Contact our HS2 Helpdesk team all day, every day of the year on:

 Freephone **08081 434 434**

 Minicom **08081 456 472**

 Email **hs2enquiries@hs2.org.uk**

Write to:

FREEPOST

HS2 Community Engagement

Website **www.hs2.org.uk**

To keep up to date with what is happening in your local area, visit: **www.hs2inyourarea.co.uk**

Please contact us if you'd like a free copy of this document in large print, Braille, audio or easy read. You can also contact us for help and information in a different language.

HS2 Ltd is committed to protecting personal information. If you wish to know more about how we use your personal information please see our Privacy Notice <https://www.gov.uk/government/publications/high-speed-two-ltd-privacy-notice>

Contact our HS2 Helpdesk team on **08081 434 434**