

Notice of road closure, A41

January 2024 | www.hs2.org.uk

High Speed Two (HS2) is the new high speed railway for Britain, if you have any questions or enquiries about our work, please contact our Helpdesk to find out more. You can sign up for regular updates in your local area at www.hs2inyourarea.co.uk.

What are we doing?

In preparation for our A41 realignment works, we will be undertaking utility works to protect cabling by installing ducts on the A41, near Waddesdon.

This ducting will enable the diversion of the BT cable on Blackgrove Road. The work will involve cutting a trench in the carriageway, followed by reinstatement.

As we are working around the carriageway, two consecutive overnight road closures will be in place for road users.

Access to properties along the A41 will be maintained.

When will these works take place?

- **Friday 16 into Saturday 17 February** and **Saturday 17 into Sunday 18 February** between **8:30pm – 5:30am**

Every effort will be made to complete these works within two overnight closures.

However, we have planned contingency dates the following weekend if the works can't be completed due to circumstances outside of our control, such as adverse weather.

- Overnight on **Friday 23 into Saturday 24 February** and **Saturday 24 into Sunday 25 February** between **8:30pm – 5:30am** (contingency dates)

These dates are subject to change due to ground conditions but will be completed in or around the anticipated time schedules.

If you have a question about HS2 or our works, please contact our HS2 Helpdesk team on 08081 434 434 or email hs2enquiries@hs2.org.uk

Notification



Duration of works

Friday 16 February – Sunday 18 February

8:30pm – 5:30am

Contingency dates:

Friday 23 February – Sunday 25 February

8:30pm – 5:30am

What to expect

Utility works on the A41

Overnight road closure of the A41

What we will do

Respond promptly to any complaints we may receive and action accordingly.

Manage any environmental impacts, such as traffic and noise.

Take care to respect the community.

Notice of road closure, A41



Where will the road closure be located and what is the diversion route?

The map below, shows the location of the road closure. Our workforce will be installing the ducting within this location along the A41.

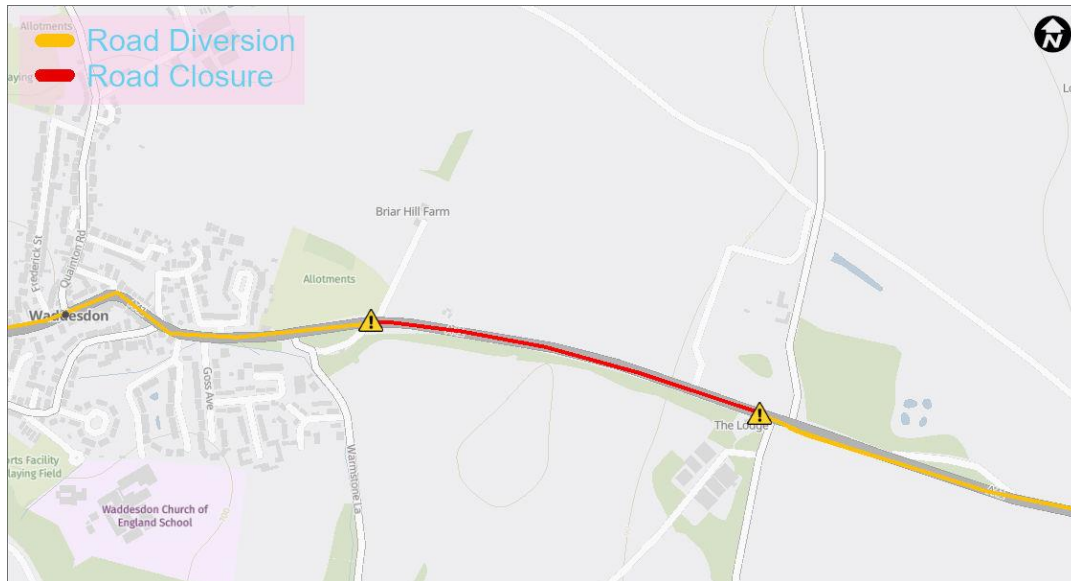

The second map below highlights the diversion route for the road closure. When planning diversion routes, we have to allow for the use of like for like roads for all traffic users. This is to avoid sending vehicles down inappropriate routes for their size.

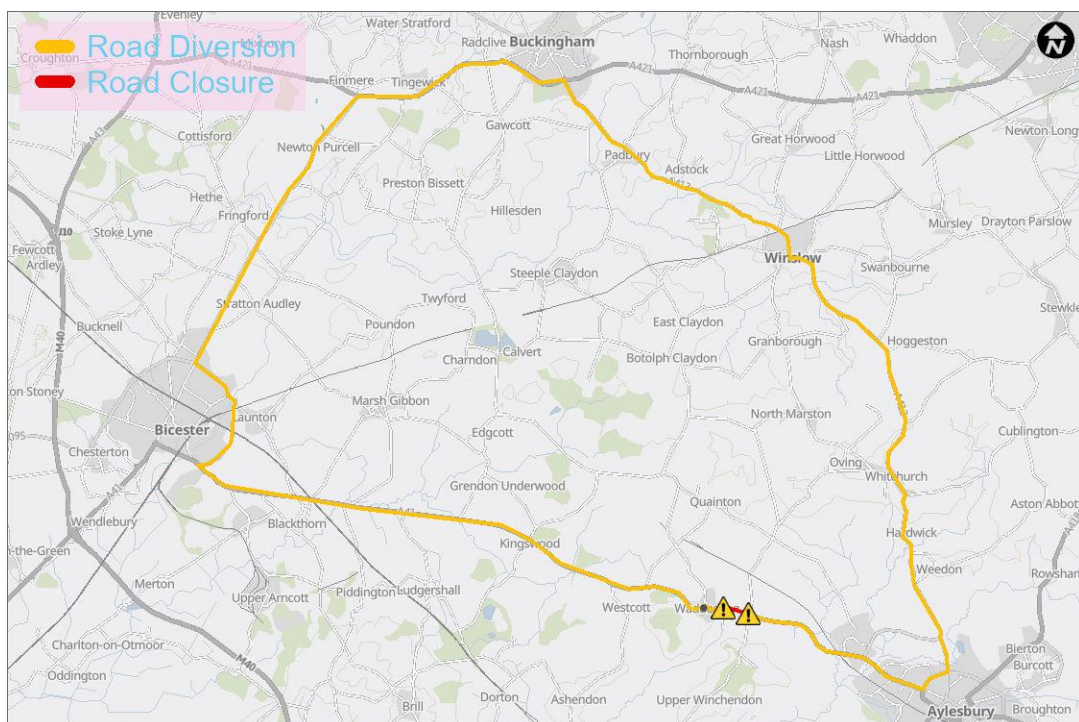

Contact our HS2 Helpdesk team on **08081 434 434**



Notice of road closure, A41

Are there any more works on the A41?

Yes, one of our main sections of work in Aylesbury in re-aligning the A41 to allow for the HS2 trace to run alongside the road. From now until Summer 2024, we will have a programme of works which will provide a phased approach to opening the new alignment to the public. This will include closures on Blackgrove Road and the A41 at separate times. We will communicate this out to the public in due course.

What will the A41 re-alignment look like?

The map shown illustrates the proposed new alignment of the A41.

The new road will sweep to the east of the existing road and connect to Blackgrove Road with a new roundabout. There will be a section of Blackgrove road that will be a bridge which will carry traffic over the HS2 rail line. The existing A41 will be narrowed and used for local access only.

When the new alignment is completed, the temporary roundabout that was installed by the compound will be removed.

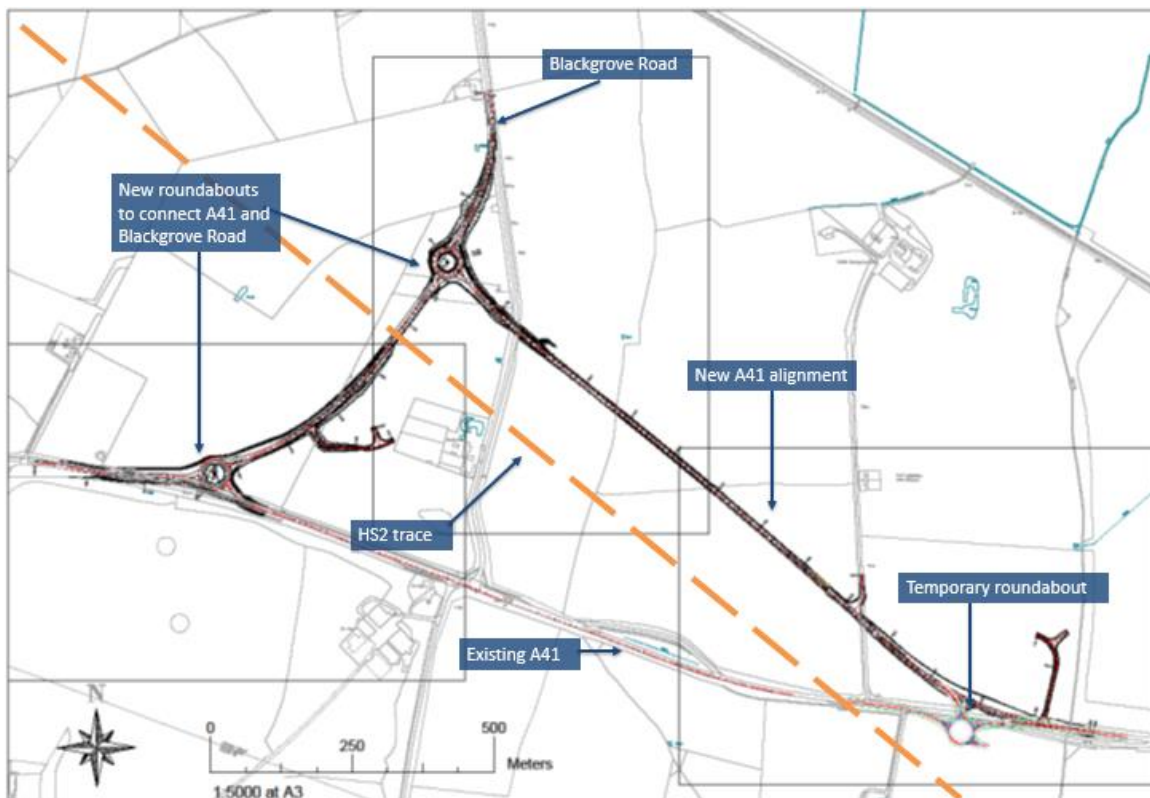

Where can I find out more information?



Why not join us at our next local community drop-in session at our mobile visitor centre where you can speak with our engagement team to find out more about the works around the A41 and the surrounding area.

- **Wednesday 21 February 2024 – 2pm – 6:30pm** | Waddesdon Community Centre car park, Frederick Street, Waddesdon, HP18 0LX



Keeping you informed

We are committed to keeping you informed about work on HS2. This includes ensuring you know what to expect and when to expect it, as well as how we can help.

Residents' Charter and Commissioner

The Residents' Charter is our promise to communicate as clearly as we possibly can with people who live along or near the HS2 route.

www.gov.uk/government/publications/hs2-residents-charter

We also have an independent Residents' Commissioner whose job is to make sure we keep to the promises we make in the Charter and to keep it under constant review. Find reports at: www.gov.uk/government/collections/hs2-ltd-residents-commissioner

You can contact the Commissioner at: residentscommissioner@hs2.org.uk

Construction Commissioner

The Construction Commissioner's role is to mediate and monitor the way in which HS2 Ltd manages and responds to construction complaints. You can contact the Construction Commissioner by emailing:

complaints@hs2-cc.org.uk

Property and compensation

You can find out all about HS2 and properties along the line of route by visiting:

www.gov.uk/government/collections/hs2-property

Find out if you're eligible for compensation at:

www.gov.uk/claim-compensation-if-affected-by-hs2

Holding us to account

If you are unhappy for any reason you can make a complaint by contacting our HS2 Helpdesk team. For more details on our complaints process, please visit our website:

www.hs2.org.uk/how-to-complain

Reference number: 1MC12-EKF-IN-NTE-CS04-000078 HS2-MW-EK-Ph1-Ar-Ce-C2-Traf-02-09/01/2024

High Speed Two (HS2) Limited, registered in England and Wales.

Registered office: Two Snowhill, Snow Hill Queensway, Birmingham B4 6GA.

Company registration number: 06791686. VAT registration number: 888 8512 56.

Contact Us

Contact our HS2 Helpdesk team all day, every day of the year on:

 Freephone **08081 434 434**

 Minicom **08081 456 472**

 Email **hs2enquiries@hs2.org.uk**

Write to:

FREEPOST

HS2 Community Engagement

Website **www.hs2.org.uk**

To keep up to date with what is happening in your local area, visit: **www.hs2inyourarea.co.uk**

Please contact us if you'd like a free copy of this document in large print, Braille, audio or easy read. You can also contact us for help and information in a different language.

HS2 Ltd is committed to protecting personal information. If you wish to know more about how we use your personal information please see our Privacy Notice <https://www.gov.uk/government/publications/high-speed-two-ltd-privacy-notice>