

Update notice of abnormal load deliveries

November 2023 | www.hs2.org.uk

High Speed Two (HS2) is the new high speed railway for Britain, if you have any questions or enquiries about our work, please contact our Helpdesk to find out more. You can sign up for regular updates in your local area at www.hs2inyourarea.co.uk.

What are we doing?

As we move into the main construction phases for the bridges and viaducts in the areas of Great Missenden, Wendover, and Stoke Mandeville, we need to start bringing in precast steel and concrete.

To reduce our impact on the local area, many aspects of these bridges and viaducts are being manufactured offsite.

Some of these beams are up to 30m in length (similar in length to three buses). Deliveries of this size are classed as abnormal loads.

How have we prepared for these deliveries?

To ensure safe delivery, our hauliers have carried out successful trial runs for the routes used which has enabled us to develop the best possible method of delivery.

How was the route decided?

Through discussions between the hauliers and the police, it has been agreed that the safest option is for delivery vehicles to exit the M40 at Junction 1. This is a slight deviation from our usual HGV routes from Junction 2 of the M40. The reason for the deviation is so that the longer vehicles can manoeuvre safely around the roundabout at the junction of the A355 and A413 from this direction.

Is there any contingency in place?

Should the loads arrive too early or there be an incident on the planned route prior to the abnormal load leaving the M40 we will also be closing the northbound and southbound laybys on the A355 by Junction 2 of the M40. The abnormal loads will wait in this location until it can safely resume its journey to site.

Where will the deliveries come into?

There are three main sites where deliveries can be received.

- Great Missenden compound;
- A413 Small Dean compound;
- Wendover Bypass, Wendover Green Tunnel compound.

Notification



Duration of works

Abnormal load deliveries will take place through December 2023 and throughout 2024

What to expect

Off-peak traffic management for the delivery of steel beams and precast concrete.

We expect to begin receiving the delivery of steel beams and precast concrete for several of our structures throughout 2023 and 2024 to our Great Missenden and Wendover Green Tunnel compounds.

Once construction of the Wendover Green Tunnel commences, we will receive deliveries of precast segments through 2024 directly to the North Portal compound on the Wendover Bypass.

The number of deliveries each week will vary depending on the programme of works.

Update notice of abnormal load deliveries



How will this affect me?

For the safety of road users and our staff, these abnormal loads will require temporary traffic management at specific locations to complete their journey to our sites. This traffic management will only be operational for a short period of time while the vehicles pass through. We will also have escort vehicles in operation to support the load movement to site.

When will these works take place?

The steel deliveries will take place out of hours in the evenings. To reduce the impact on road users these deliveries will take place outside of peak traffic periods.

There may be some instances where these deliveries are brought to site during the day and traffic management will be closely monitored and only operational when required.

The deliveries will follow an irregular pattern. The number of deliveries each week and each night will vary depending on the programme of works on site.



Image above is an example of an abnormal load of steel being delivered to a HS2 site.

If you have a question about HS2 or our works, please contact our HS2 Helpdesk team on 08081 434 434 or email hs2enquiries@hs2.org.uk

What we will do

Minimise disruption as much as possible for the community by careful timing of deliveries.

Provide updates for communities and maintain regular contact with emergency services.

Update notice of abnormal load deliveries



What route will be taken for Great Missenden?

The vehicles will leave the M40 at Junction 1, then follow the A40 towards Amersham and the A413 to our site in Great Missenden. The full route is highlighted in blue on the map below. For the safety of all road users, there will be four areas where we have temporary traffic lights in place while the deliveries take place.

You can see where these will be on the below map. The traffic lights will only be active for a few minutes while the abnormal load delivery makes its way to our site. The locations of the traffic lights are in the following locations where all traffic will be stopped for a short time while the abnormal load passes through:

- The Gore Hill/A413 roundabout in Amersham
- The A413/A404 roundabout in Amersham
- The railway bridge near Little Missenden
- Both roundabout on the A413 between Link Road and Frith Hill.

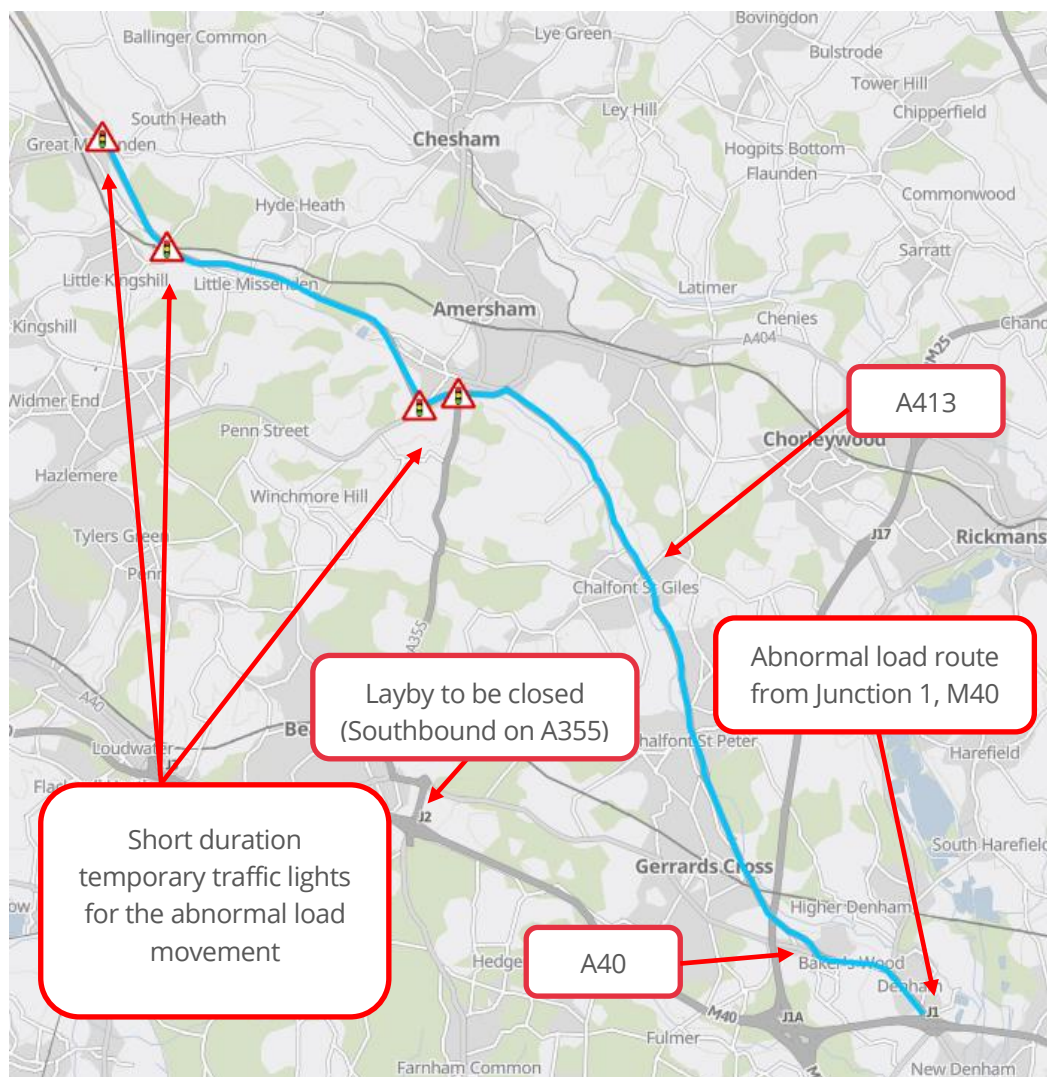

Update notice of abnormal load deliveries



What route will be taken for the Wendover Bypass?

The vehicles will leave the M40 at Junction 1, then follow the A40 towards Amersham and the A413 towards Great Missenden and on towards Wendover. The full route is highlighted in blue on the map below. For the safety of all road users, there will be five areas where we have temporary traffic lights in place while the deliveries take place.

You can see where these will be on the below map. The traffic lights will only be active for a few minutes while the abnormal load delivery makes its way to our site. The locations of the traffic lights are in the following locations where all traffic will be stopped for a short time while the abnormal load passes through:

- The Gore Hill/A413 roundabout in Amersham
- The A413/A404 roundabout in Amersham
- The railway bridge near Little Missenden
- Both roundabout on the A413 between Link Road and Frith Hill
- Small Dean roundabout.

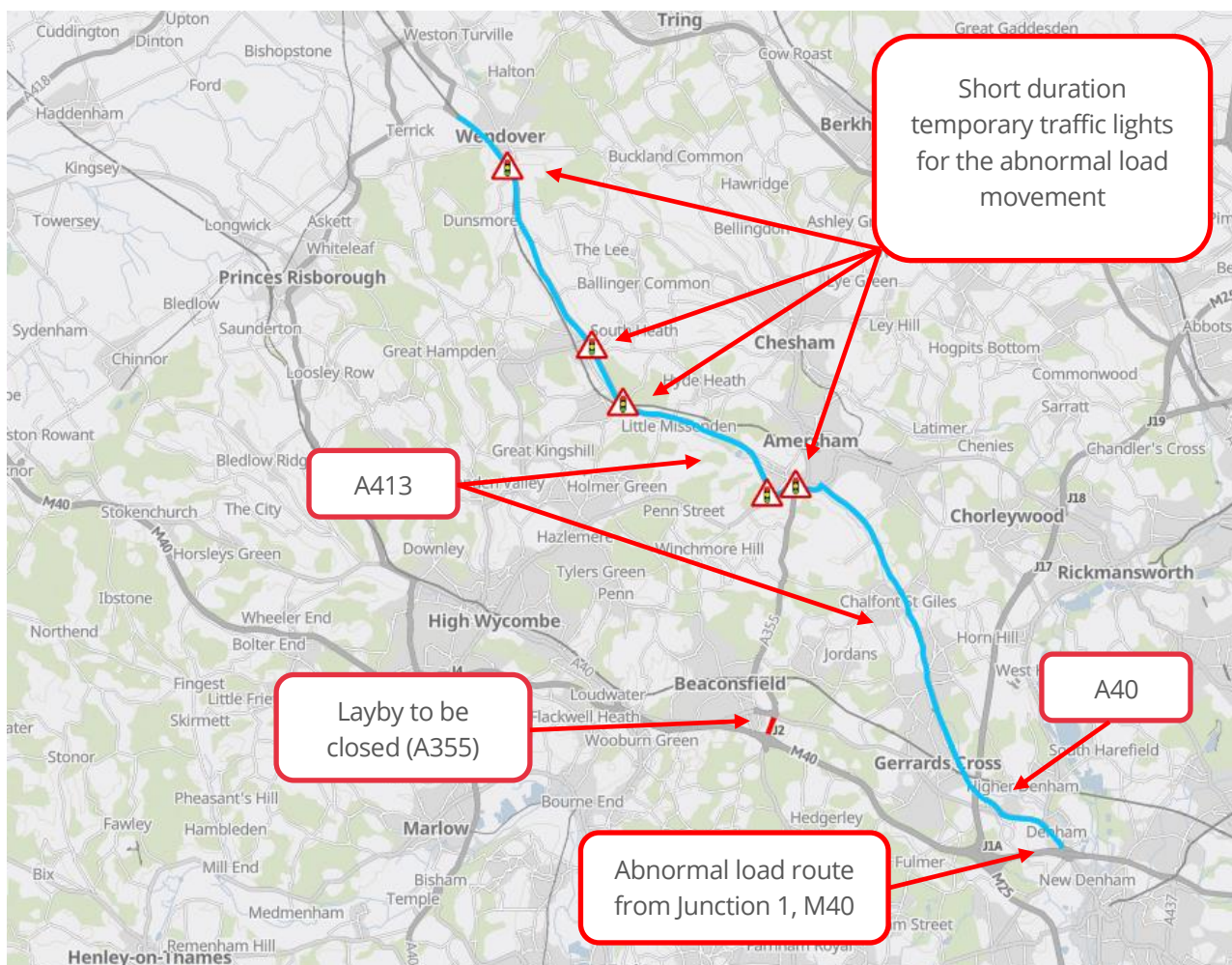

Keeping you informed

We are committed to keeping you informed about work on HS2. This includes ensuring you know what to expect and when to expect it, as well as how we can help.

Residents' Charter and Commissioner

The Residents' Charter is our promise to communicate as clearly as we possibly can with people who live along or near the HS2 route.
www.gov.uk/government/publications/hs2-residents-charter

We also have an independent Residents' Commissioner whose job is to make sure we keep to the promises we make in the Charter and to keep it under constant review. Find reports at:
www.gov.uk/government/collections/hs2-ltd-residents-commissioner

You can contact the Commissioner at:
residentscommissioner@hs2.org.uk

Construction Commissioner

The Construction Commissioner's role is to mediate and monitor the way in which HS2 Ltd manages and responds to construction complaints. You can contact the Construction Commissioner by emailing:
complaints@hs2-cc.org.uk

Property and compensation

You can find out all about HS2 and properties along the line of route by visiting:
www.gov.uk/government/collections/hs2-property
Find out if you're eligible for compensation at:
www.gov.uk/claim-compensation-if-affected-by-hs2

Holding us to account

If you are unhappy for any reason you can make a complaint by contacting our HS2 Helpdesk team. For more details on our complaints process, please visit our website:
www.hs2.org.uk/how-to-complain

Contact Us

Contact our HS2 Helpdesk team all day, every day of the year on:

 Freephone **08081 434 434**

 Minicom **08081 456 472**

 Email **hs2enquiries@hs2.org.uk**

Write to:

FREEPOST

HS2 Community Engagement

Website **www.hs2.org.uk**

To keep up to date with what is happening in your local area, visit:
www.hs2inyourarea.co.uk

Please contact us if you'd like a free copy of this document in large print, Braille, audio or easy read. You can also contact us for help and information in a different language.

HS2 Ltd is committed to protecting personal information. If you wish to know more about how we use your personal information please see our Privacy Notice
<https://www.gov.uk/government/publications/high-speed-two-ltd-privacy-notice>

Reference number: HS2-23-102924-E | 1MC12-EKF-IN-NTE-CS03-000066

High Speed Two (HS2) Limited, registered in England and Wales.

Registered office: Two Snowhill, Snow Hill Queensway, Birmingham B4 6GA.

Company registration number: 06791686. VAT registration number: 888 8512 56.

Contact our HS2 Helpdesk team on **08081 434 434**