

Ground investigations in the Camden area

November 2023 | www.hs2.org.uk

High Speed Two (HS2) is the new high speed railway for Britain.

Ground investigations in your area

On **16 and 20 November 2023** we will be carrying out a series of surveys on Loudoun Road and Eton Avenue.

We will use scanning equipment to create a map of the utility services below the road. They will be marked using biodegradable spray paint. Once the survey of the site is complete, we will take photos of the paint marks to record the location of the utilities.

We will use noise reducing barriers where possible to help minimise any noise disruption to the local community, and work as efficiently as possible whilst keeping our work areas safe and tidy.

How will this affect you

To ensure the safety of the public and our staff, temporary changes will be in place on Loudoun Road and Alexandra Road and will include lane closures, footpath closures and parking suspension.

These temporary changes are shown on the following pages.

Speak with our local engagement team

Our local engagement team is happy to arrange a time to speak with you over the phone if you have any questions about the surveys.

Please contact the HS2 Helpdesk using the contact details below to arrange this.

If you have a question about HS2 or our works, please contact our HS2 Helpdesk team on 08081 434 434 or email hs2enquiries@hs2.org.uk

Notification



Duration of works

16 and 20 November 2023

Working Hours

8am to 6pm

We may be on site for an hour before the start and/or end of the shift

What to expect

Surveying equipment including tripods and trolley mounted or vehicle mounted equipment

Temporary markings on the footway that will wash away

Temporary lane and footpath closures and parking suspensions

What we will do

Monitor our working methods to reduce disruption.

Provide updates at HS2 works in Old Oak Common and North Acton

Ground investigations in the Camden area

Notification



www.hs2.org.uk

Loudoun Road : 16 November (one day)

We will be carrying out a surveys on Loudoun Road on 16 November 2023. These works will include a lane closure and partial footpath closure which can be seen on the map below.

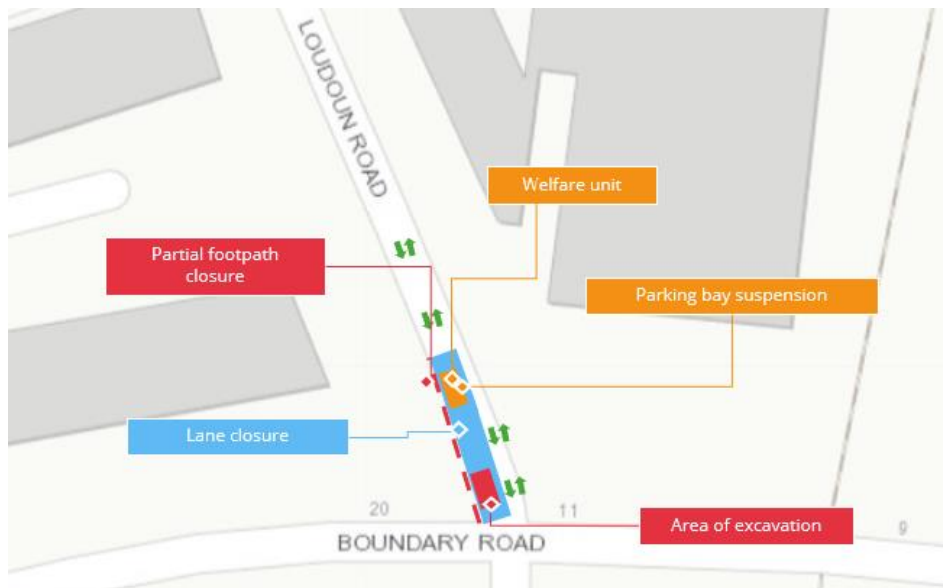

Eton Avenue: 20 November (one day)

We will be carrying out a surveys on Eton Avenue on 20 November 2023. These works will include a lane closure, partial footpath closure and parking bay suspensions which can be seen on the map



Contact our HS2 Helpdesk team on **08081 434 434**

What else is happening in your area?

www.hs2.org.uk

Contact our HS2 Helpdesk team

Our team is here to listen and respond to your enquiry, complaint or feedback to help us be a good neighbour.

You can contact our Helpdesk team all day, every day of the year on:

Freephone: **08081 434 434**

Minicom: **08081 456 472**

Email: hs2enquiries@hs2.org.uk

Keep up to date with your local community website

To find out more about what's happening in your area and receive regular email updates, you can sign up to our local community websites at: www.hs2inyourarea.co.uk.

About our Community and Business Funds

We are offering two funds that are available to local communities and businesses between the West Midlands and London, to help with the disruption caused by our construction work. These are the Community and Environment Fund (CEF) and the Business and Local Economy Fund (BLEF).

The CEF is designed to give communities the opportunity to share in the benefits of HS2. It is an allocated fund that communities are able to apply for, to help to support local projects that aim to improve their local area.

The BLEF is designed to support local economies that may be disrupted by the construction of HS2. BLEF grants are for local business support organisations and local authorities to help maintain business activity in local communities.

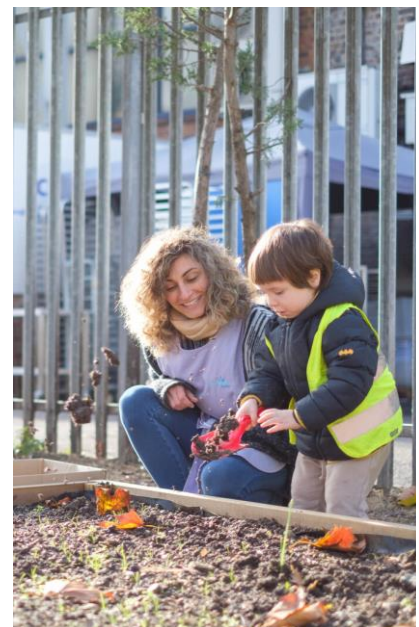

Contact our HS2 Helpdesk team on **08081 434 434**

Keeping you informed

We are committed to keeping you informed about work on HS2. This includes ensuring you know what to expect and when to expect it, as well as how we can help you.

The Residents' Commissioner

The independent Residents' Commissioner oversees and monitors our commitments to you.

The commissioner's reports and our responses can be found at www.gov.uk/government/collections/hs2-ltd-residents-commissioner

The Residents' Commissioner makes sure we fulfil the commitments in the HS2 Community Engagement Strategy (<https://bit.ly/3oOA25j>).

The Residents' Commissioner can be contacted on: residentscommissioner@hs2.org.uk

Construction Commissioner

The independent Construction Commissioner regularly meets our Chief Executive Officer to raise any concerns or emerging trends across HS2.

The Construction Commissioner's role has been developed to monitor the way we manage and respond to construction complaints.

The commissioner mediates on disputes about construction, involving individuals and organisations, that we can't resolve. The commissioner advises members of the public about how to make a complaint about construction.

The Construction Commissioner can be contacted on: complaints@hs2-cc.org.uk

Property and compensation

You can find out about HS2 and properties along the route by visiting:

www.gov.uk/government/collections/hs2-property

Find out if you can claim compensation at:

www.gov.uk/claim-compensation-if-affected-by-hs2

Holding us to account

If you are unhappy for any reason you can make a complaint by contacting the HS2 Helpdesk. For more details on our complaints process, please visit:

www.hs2.org.uk/in-your-area/contact-us/how-to-complain/

Reference number: HS2-EW-SCS-Ph1-Ar-So-S2-UT-1-31/10/23

High Speed Two (HS2) Limited, registered in England and Wales.

Registered office: Two Snowhill, Snow Hill Queensway, Birmingham B4 6GA.

Company registration number: 06791686. VAT registration number: 888 8512 56

Contact us

Contact our HS2 Helpdesk team all day, every day of the year on:

 Freephone **08081 434 434**

 Minicom **08081 456 472**

 Email **HS2enquiries@hs2.org.uk**

Write to:

FREEPOST

HS2 Community Engagement

Website **www.hs2.org.uk**

To keep up to date with what is happening in your local area, visit:
www.HS2inyourarea.co.uk

Please contact us if you'd like a free copy of this document in large print, Braille, audio or 'easy read' format. You can also contact us for help and information in a different language.

HS2 Ltd is committed to protecting personal information. If you wish to know more about how we use your personal information please see our Privacy Notice: <https://www.gov.uk/government/publications/high-speed-two-ltd-privacy-notice>