



## Notice to extend closure of the A38 southbound slip road and temporary re-opening of Fradley and Streethay 6 PRow

October 2023 | [www.hs2.org.uk](http://www.hs2.org.uk)

High Speed Two (HS2) is the new high speed railway for Britain. Balfour Beatty VINCI (BBV) is working in partnership with HS2 Ltd to build the new high-speed railway in your area.

### Extending the temporary A38 southbound slip road closure at Streethay

In August 2022 we communicated that we would close the A38 southbound slip road to undertake works on the southbound slip road overbridge. In March 2023 the Government updated Parliament on their transport capital investment programme including an update on the HS2 project. As a result of this announcement, we have reviewed our programme with HS2 to agree which key construction work will continue and which works will be paused for two years.

As a result of the programme review and additional utility and design requirements we will need to extend the temporary closure of the A38 southbound slip road closure, at Streethay, until Spring 2024.

We will share further updates, in early 2024, on the temporary diversion of the A38 and closure of the northbound slip road.

### Two HS2 railway bridges installed at Streethay, Lichfield.

We recently completed the construction and installation of two railway bridges, that form part of Streethay Cutting, in Lichfield. To find out more on these please click the link below:

Fulfen Wood Overbridge which was installed on the West Coast main line railway: <https://mediacentre.hs2.org.uk/news/hs2-celebrates-uks-heaviest-bridge-drive-near-lichfield>

Streethay Overbridge which was installed on the South Staffordshire railway line: <https://mediacentre.hs2.org.uk/news/hs2-marathon-bridge-construction-completed-near-lichfield>

**If you have a question about HS2 or our works, please contact our HS2 Helpdesk team on 08081 434 434 or email [hs2enquiries@hs2.org.uk](mailto:hs2enquiries@hs2.org.uk)**

### A38 Update

The temporary closure of the A38 southbound slip-road, at Streethay, will be extended until Spring 2024.

The Fradley and Streethay 6 Public Right of Way (PRow) temporary diversion will open while works are paused at this location.

### What to expect

We may need to extend our working hours as we complete works on the A38.

Some noise and vibration from the work we are completing, including piling.

Clearly signed diversion route. Please do not follow Sat Navs.

**Please register at [www.hs2.org.uk/staffordshire](http://www.hs2.org.uk/staffordshire) for updates.**

# Notice to extend closure of the A38 southbound slip road and temporary re-opening of Fradley and Streethay 6 PRow

Notification



[www.hs2.org.uk](http://www.hs2.org.uk)

## Map of southbound slip road closure at Streethay and diversion route

The map below details the A38 southbound slip road closure and diversion route.

During the closure, clear signage will be in place along the diversion route for road users.

This diversion will affect road users travelling into Streethay and parts of north Lichfield who would usually use the A38 southbound slip road to the A5127. The diversion will take road users to the next exit at Swinfen Island. Please do not use Sat Navs but instead follow the signed diversion.

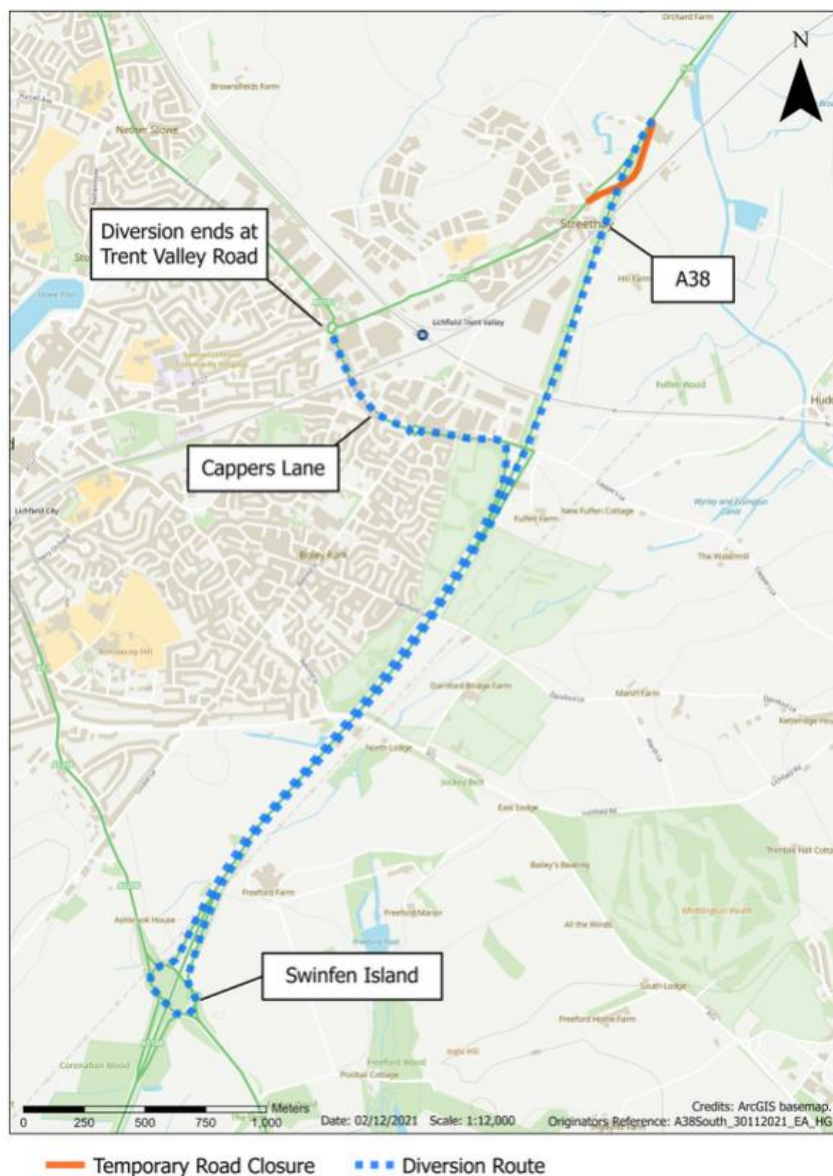

Contact our HS2 Helpdesk team on **08081 434 434**

# Notice to extend closure of the A38 southbound slip road and temporary re-opening of Fradley and Streethay 6 PRow

[www.hs2.org.uk](http://www.hs2.org.uk)

Notification



## Temporary re-opening of Fradley and Streethay 6 Public Right of Way (PRow)

In April 2022 we communicated that we had commenced work on Streethay Cutting. To ensure the safety of the public we closed Public Right of Way Fradley and Streethay 6 for the duration of our construction period.

Over this period, we received feedback from the local community that this footpath enabled walkers to access Streethay, the canal and Whittington. Local residents asked us to review the closure of the footpath, as our works progressed, to assess if it could be diverted and temporarily re-opened in advance of the new Streethay Footpath Overbridge being constructed. We have undertaken a review following the Government announcement in March 2023 and have temporarily paused works on Streethay Cutting. This will enable us to create a temporary path through our site to enable the footpath to re-open. We will share an update once the new diverted footpath is created and safe to open.

Please note: We will continue to review this footpath diversion, as and when works are planned to continue on Streethay Cutting. We will keep you updated on this via [www.hs2.org.uk/staffordshire](http://www.hs2.org.uk/staffordshire)

## Map of Fradley and Streethay 6 Public Right of Way (PRow) temporary diversion.

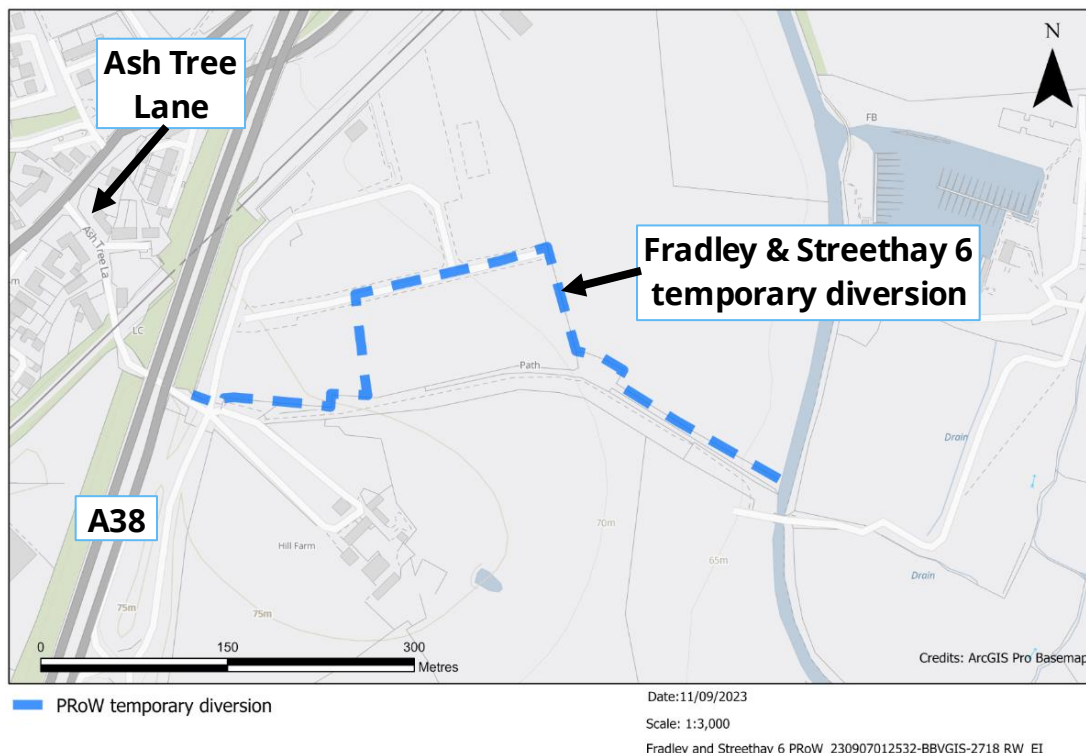

Contact our HS2 Helpdesk team on **08081 434 434**

# Keeping you informed

We are committed to keeping you informed about work on HS2. This includes ensuring you know what to expect and when to expect it, as well as how we can help you.

## The Residents' Commissioner

The independent Residents' Commissioner oversees and monitors our commitments to you.

The commissioner's reports and our responses can be found at [www.gov.uk/government/collections/hs2-ltd-residents-commissioner](http://www.gov.uk/government/collections/hs2-ltd-residents-commissioner)

The Residents' Commissioner makes sure we fulfil the commitments in the HS2 Community Engagement Strategy (<https://bit.ly/3oOA25j>).

The Residents' Commissioner can be contacted on: [residentscommissioner@hs2.org.uk](mailto:residentscommissioner@hs2.org.uk)

## Construction Commissioner

The independent Construction Commissioner regularly meets our Chief Executive Officer to raise any concerns or emerging trends across HS2.

The Construction Commissioner's role has been developed to monitor the way we manage and respond to construction complaints.

The commissioner mediates on disputes about construction, involving individuals and organisations, that we can't resolve. The commissioner advises members of the public about how to make a complaint about construction.

The Construction Commissioner can be contacted on: [complaints@hs2-cc.org.uk](mailto:complaints@hs2-cc.org.uk)

## Property and compensation

You can find out about HS2 and properties along the route by visiting:

[www.gov.uk/government/collections/hs2-property](http://www.gov.uk/government/collections/hs2-property)

Find out if you can claim compensation at:

[www.gov.uk/claim-compensation-if-affected-by-hs2](http://www.gov.uk/claim-compensation-if-affected-by-hs2)

## Holding us to account

If you are unhappy for any reason you can make a complaint by contacting the HS2 Helpdesk. For more details on our complaints process, please visit: [www.hs2.org.uk/in-your-area/contact-us/how-to-complain/](http://www.hs2.org.uk/in-your-area/contact-us/how-to-complain/)

## Contact us

Contact our HS2 Helpdesk team all day, every day of the year on:

 Freephone **08081 434 434**

 Minicom **08081 456 472**

 Email **[HS2enquiries@hs2.org.uk](mailto:HS2enquiries@hs2.org.uk)**

Write to:

**FREEPOST**

**HS2 Community Engagement**

Website **[www.hs2.org.uk](http://www.hs2.org.uk)**

To keep up to date with what is happening in your local area, visit: **[www.HS2inyourarea.co.uk](http://www.HS2inyourarea.co.uk)**

**Please contact us if you'd like a free copy of this document in large print, Braille, audio or 'easy read' format. You can also contact us for help and information in a different language.**

HS2 Ltd is committed to protecting personal information. If you wish to know more about how we use your personal information please see our Privacy Notice: <https://www.gov.uk/government/publications/high-speed-two-ltd-privacy-notice>

**Reference number: HS2-MW-BBV-Ph1-Ar-No-N2-Traf-9-10/05/2022**

High Speed Two (HS2) Limited, registered in England and Wales.

Registered office: Two Snowhill, Snow Hill Queensway, Birmingham B4 6GA.

Company registration number: 06791686. VAT registration number: 888 8512 56