

# Notice of Wendover bypass lane and layby closures

August 2023 | [www.hs2.org.uk](http://www.hs2.org.uk)

High Speed Two (HS2) is the new high speed railway for Britain, if you have any questions or enquiries about our work, please contact our Helpdesk to find out more. You can sign up for regular updates in your local area at [www.hs2inyourarea.co.uk](http://www.hs2inyourarea.co.uk).

## What are we doing?

We will be implementing lane closures on the A413 Wendover bypass from Monday 14 August to Friday 18 August to finalise the installation of a power connection to our site off the bypass.

To complete these works safely we will be using traffic lights on a section of the bypass along with temporarily closing the layby on the Eastern side of the road as shown in the map below.

## Why are you doing these works?

To reduce the number of deliveries to our sites and to maintain a readily available source of concrete for our works, we have set up our own concrete batching plant at our Wendover Green Tunnel site.

We have been using generators since the plant became operational last year, but for us to gain a more sustainable power source with less emission production, we will be connecting the plant to the power grid.

We began these works in February and will use this closure for the final completion stage for this connection. The works will involve excavating part of the Wendover bypass to insert a high voltage cable across the road.

## When will these works take place?

- Monday 14 to Friday 18 August, this lane closure will be in place 24 hours a day.

Please note, these dates may be subject to change due to circumstances outside of our control. Please see the HS2 website for any further updates.

**If you have a question about HS2 or our works, please contact our HS2 Helpdesk team on 08081 434 434 or email [hs2enquiries@hs2.org.uk](mailto:hs2enquiries@hs2.org.uk)**

## Notification



### Duration of works

Monday 14 to Friday 18 August.

The closure will be in place 24 hours a day due to presence of open excavation.

### What to expect

Various activities around the perimeter of the Wendover bypass.

Layby and lane closure of a section of the Wendover bypass.

### What we will do

Respond promptly to any complaints we may receive and action accordingly.

Provide fully signposted diversion.

Manage any noise or traffic impacts.

# Notice Wendover bypass lane and layby closures



## How will this affect me?

Access to the bypass will be maintained for road users. We will introduce temporary traffic lights to manage the lane closure which will be in place 24 hours a day for the duration of the works.

The layby will also temporarily be closed while we are working in this location but will re-open as soon as we have completed our works.

## Where will you be working?

The map below, shows the area that we will be working in and where the traffic lights will be located on the A413 from Monday 14 to Friday 18 August.

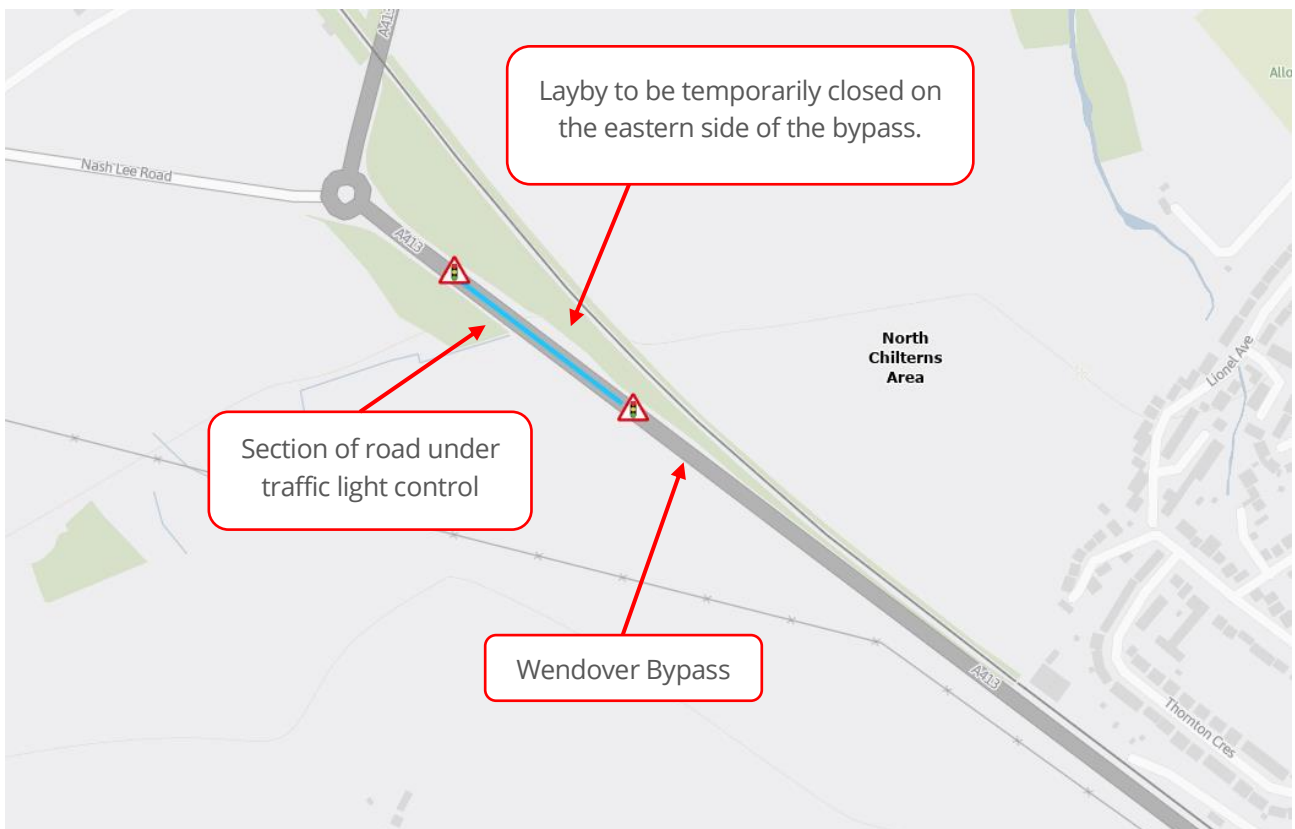

# Keeping you informed

We are committed to keeping you informed about work on HS2. This includes ensuring you know what to expect and when to expect it, as well as how we can help.

## Residents' Charter and Commissioner

The Residents' Charter is our promise to communicate as clearly as we possibly can with people who live along or near the HS2 route.

[www.gov.uk/government/publications/hs2-residents-charter](http://www.gov.uk/government/publications/hs2-residents-charter)

We also have an independent Residents' Commissioner whose job is to make sure we keep to the promises we make in the Charter and to keep it under constant review. Find reports at: [www.gov.uk/government/collections/hs2-ltd-residents-commissioner](http://www.gov.uk/government/collections/hs2-ltd-residents-commissioner)

You can contact the Commissioner at: [residentscommissioner@hs2.org.uk](mailto:residentscommissioner@hs2.org.uk)

## Construction Commissioner

The Construction Commissioner's role is to mediate and monitor the way in which HS2 Ltd manages and responds to construction complaints. You can contact the Construction Commissioner by emailing:

[complaints@hs2-cc.org.uk](mailto:complaints@hs2-cc.org.uk)

## Property and compensation

You can find out all about HS2 and properties along the line of route by visiting:

[www.gov.uk/government/collections/hs2-property](http://www.gov.uk/government/collections/hs2-property)

Find out if you're eligible for compensation at:

[www.gov.uk/claim-compensation-if-affected-by-hs2](http://www.gov.uk/claim-compensation-if-affected-by-hs2)

## Holding us to account

If you are unhappy for any reason you can make a complaint by contacting our HS2 Helpdesk team.

For more details on our complaints process, please visit our website:

[www.hs2.org.uk/how-to-complain](http://www.hs2.org.uk/how-to-complain)

## Contact Us

Contact our HS2 Helpdesk team all day, every day of the year on:

 Freephone **08081 434 434**

 Minicom **08081 456 472**

 Email **[hs2enquiries@hs2.org.uk](mailto:hs2enquiries@hs2.org.uk)**

Write to:

**FREEPOST**

**HS2 Community Engagement**

Website **[www.hs2.org.uk](http://www.hs2.org.uk)**

To keep up to date with what is happening in your local area, visit: **[www.hs2inyourarea.co.uk](http://www.hs2inyourarea.co.uk)**

**Please contact us if you'd like a free copy of this document in large print, Braille, audio or easy read. You can also contact us for help and information in a different language.**

HS2 Ltd is committed to protecting personal information. If you wish to know more about how we use your personal information please see our Privacy Notice <https://www.gov.uk/government/publications/high-speed-two-ltd-privacy-notice>

**Reference number: HS2-MW-EK-Ph1-Ar-Ce-C2-Traf-5-01/09/2023** 1MC12-EKF-IN-NTE-CS03-000086

High Speed Two (HS2) Limited, registered in England and Wales.

Registered office: Two Snowhill, Snow Hill Queensway, Birmingham B4 6GA.

Company registration number: 06791686. VAT registration number: 888 8512 56.

Contact our HS2 Helpdesk team on **08081 434 434**