

# Notice of road closure A413 London Road, Wendover

June 2023 | [www.hs2.org.uk](http://www.hs2.org.uk)

High Speed Two (HS2) is the new high speed railway for Britain, if you have any questions or enquiries about our work, please contact our Helpdesk to find out more. You can sign up for regular updates in your local area at [www.hs2inyourarea.co.uk](http://www.hs2inyourarea.co.uk).

## What are we doing?

We have some upcoming works along the A413 London Road that support the construction of the A413 re-alignment and the Small Dean viaduct.

We have three phases of construction coming up that will have short duration impacts on the road from June into July;

- Overnight closures for ground investigations
- A weekend closure for utility diversions
- Traffic lights for a lane closure to continue utility diversions

## When will these works take place?

- Monday 19 June to Friday 24 June overnight road closures 8.30 pm to 5.30am
- Friday 30 June to Monday 3 July weekend closure 8.30pm on Friday night to 5.30am on Monday morning
- Friday 7 July to Monday 10 July traffic lights and lane closure 8.30 pm on Friday night to 5.30am on Monday morning.

To minimise disruption, we will provide a signposted diversion route and have chosen to work outside of peak traffic hours.

These dates may be subject to change due to circumstances outside of our control.

**If you have a question about HS2 or our works, please contact our HS2 Helpdesk team on 08081 434 434 or email [hs2enquiries@hs2.org.uk](mailto:hs2enquiries@hs2.org.uk)**

## Notification



### Duration of works

Full road closures

- Monday 19 June to Friday 24 June
- Friday 30 June to Monday 3 July

Closure hours will be:

8.30pm to 5.30am

Lane closure and traffic lights

- Friday 7 July to Monday 10 July

### What to expect

Full closure of part of the A413 overnight.

Various activities around the perimeter of the A413.

A full diversion route to be signposted.

### What we will do

Respond promptly to any complaints we may receive and action accordingly.

Manage any noise or traffic impacts

# Notice of road closure A413 London Road, Wendover



## What is the ground investigation?

In order to build the Small Dean Viaduct, we need to temporarily realign a small section of the A413 London Road.

To prepare for the main utility diversions we need to investigate below the surface of the tarmac covering the road around the utility services.

This work will involve excavating into the road to investigate the subbase, which sits below the tarmac surface, therefore will require a road closure on the area being investigated.

These works require the carriageway to be empty, therefore the road will be closed overnight only between Monday 19 June to Friday 24 June.

## What is the weekend closure for?

In preparation for this realignment we have to permanently divert existing utility services next to the carriageway. We will need to work over one full weekend on the A413 to complete this.

This will involve digging trenches diagonally across the road to insert connecting pipework and cable ducts and backfilling to return the road to its original condition. To complete these works as quickly as possible we will be working 24 hours a day throughout the weekend.

## How long is the lane closure for?

We will also need to introduce a lane closure in the same area for the weekend commencing Friday 7 July, this is to allow us to continue these utility diversion works following on from the weekend closure.

Access will be maintained to and from Wendover, controlled by two-way traffic lights which will be in operation throughout this lane closure.

The temporary diversion of the A413 is expected to be operational for road users from late summer 2023 with the Small Dean Viaduct construction being completed in 2026.

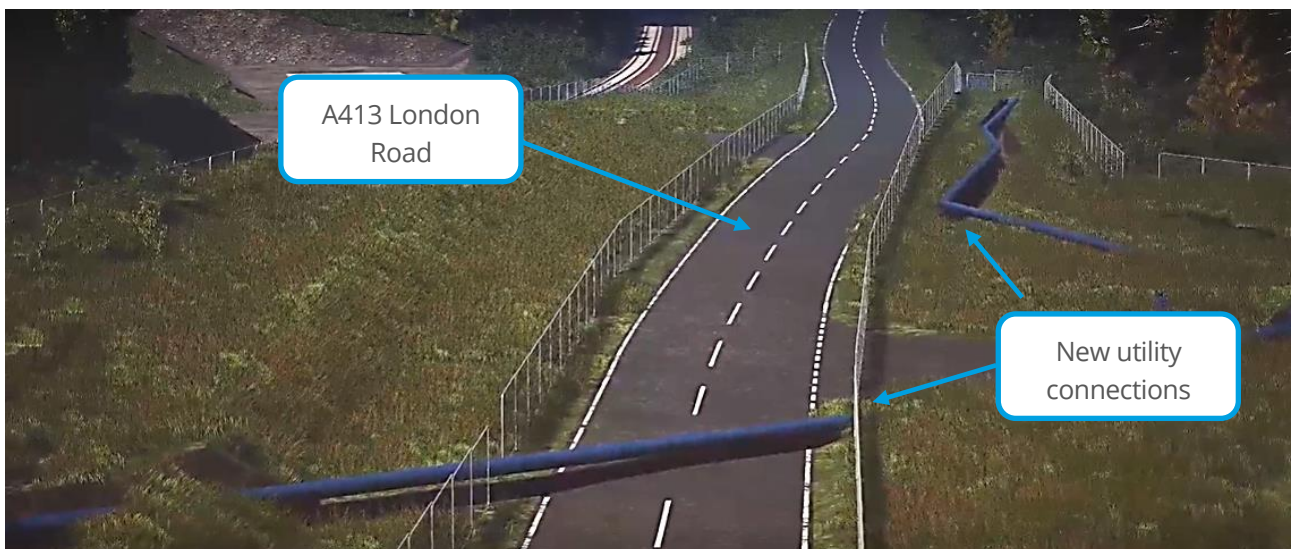

The above illustration shows an indicative location for the utility diversions which cross the carriageway to be carried out over the weekend closure.

# Notice of road closure A413 London Road



## Where will the road closure be?

The map below, shows the area of road that will be closed on the A413 overnight from Monday 19 to Friday 24 June and over one full weekend from Friday 30 June to Monday 3 July, a fully signposted diversion route will be provided.

The map below also shows the area for lane closure and two-way traffic lights over one full weekend from Friday 7 July to Monday 10 July.

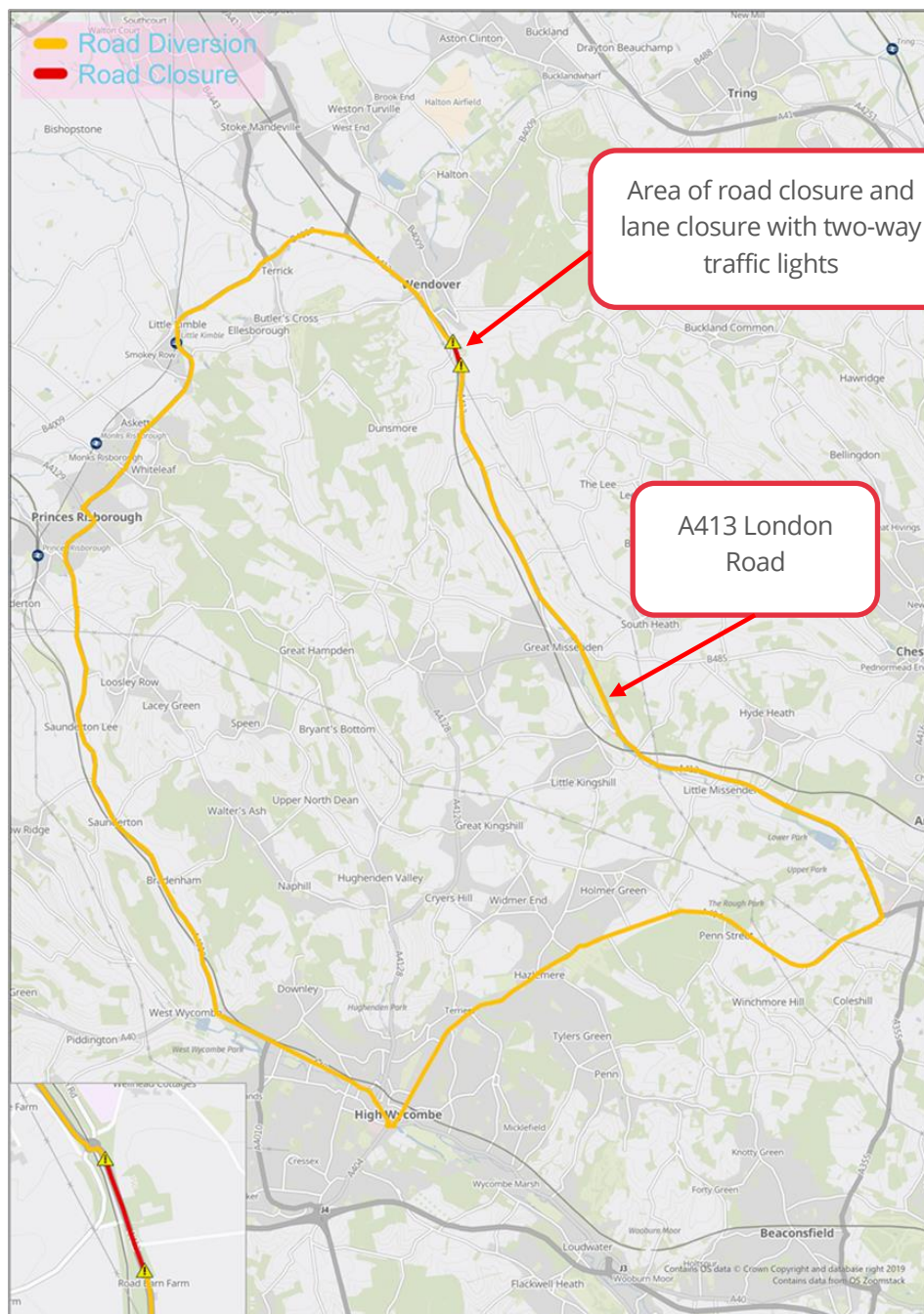

Contact our HS2 Helpdesk team on **08081 434 434**

# Keeping you informed

We are committed to keeping you informed about work on HS2. This includes ensuring you know what to expect and when to expect it, as well as how we can help.

## Residents' Charter and Commissioner

The Residents' Charter is our promise to communicate as clearly as we possibly can with people who live along or near the HS2 route.

[www.gov.uk/government/publications/hs2-residents-charter](http://www.gov.uk/government/publications/hs2-residents-charter)

We also have an independent Residents' Commissioner whose job is to make sure we keep to the promises we make in the Charter and to keep it under constant review. Find reports at: [www.gov.uk/government/collections/hs2-ltd-residents-commissioner](http://www.gov.uk/government/collections/hs2-ltd-residents-commissioner)

You can contact the Commissioner at: [residentscommissioner@hs2.org.uk](mailto:residentscommissioner@hs2.org.uk)

## Construction Commissioner

The Construction Commissioner's role is to mediate and monitor the way in which HS2 Ltd manages and responds to construction complaints. You can contact the Construction Commissioner by emailing:

[complaints@hs2-cc.org.uk](mailto:complaints@hs2-cc.org.uk)

## Property and compensation

You can find out all about HS2 and properties along the line of route by visiting:

[www.gov.uk/government/collections/hs2-property](http://www.gov.uk/government/collections/hs2-property)

Find out if you're eligible for compensation at:

[www.gov.uk/claim-compensation-if-affected-by-hs2](http://www.gov.uk/claim-compensation-if-affected-by-hs2)

## Holding us to account

If you are unhappy for any reason you can make a complaint by contacting our HS2 Helpdesk team.

For more details on our complaints process, please visit our website:

[www.hs2.org.uk/how-to-complain](http://www.hs2.org.uk/how-to-complain)

**Reference number:** HS2-MW-EK-Ph1-Ar-Ce-C1-Traf-03-01/06/2023 1MC12-EKF-IN-NTE-CS03-000084

High Speed Two (HS2) Limited, registered in England and Wales.

Registered office: Two Snowhill, Snow Hill Queensway, Birmingham B4 6GA.

Company registration number: 06791686. VAT registration number: 888 8512 56.

## Contact Us

Contact our HS2 Helpdesk team all day, every day of the year on:

 Freephone **08081 434 434**

 Minicom **08081 456 472**

 Email **[hs2enquiries@hs2.org.uk](mailto:hs2enquiries@hs2.org.uk)**

Write to:

**FREEPOST**

**HS2 Community Engagement**

Website **[www.hs2.org.uk](http://www.hs2.org.uk)**

To keep up to date with what is happening in your local area, visit: **[www.hs2inyourarea.co.uk](http://www.hs2inyourarea.co.uk)**

**Please contact us if you'd like a free copy of this document in large print, Braille, audio or easy read. You can also contact us for help and information in a different language.**

HS2 Ltd is committed to protecting personal information. If you wish to know more about how we use your personal information please see our Privacy Notice <https://www.gov.uk/government/publications/high-speed-two-ltd-privacy-notice>

Contact our HS2 Helpdesk team on **08081 434 434**