



Working on
behalf of

HS2

Thames Water & HS2 work at Gloucester
Avenue

Introduction

What our work involves

- The Middle Level Two (ML2) sewer is an important part of the capital's infrastructure for more than one hundred years
- We need to install a protective liner in the sewer, to protect it from the tunnel boring machine that HS2 will be using to build the new railway.
- Sewer access to install the liner will be provided by two shafts. There is already one shaft in place and the second one will need to be built
- The ML2 sewer carries third party cables and so additional measures have been put in place to ensure they are not disturbed

Project timescales

- Work will begin late May 2023 and will be completed early 2024
- There will be a lane closure and diversion route in place for the duration of our work

Work site setup

1. We will be working outside Darwin Court and in the eastern lane on Gloucester Avenue
2. There will be a diversion in place
3. The work will be carried out in one single phase

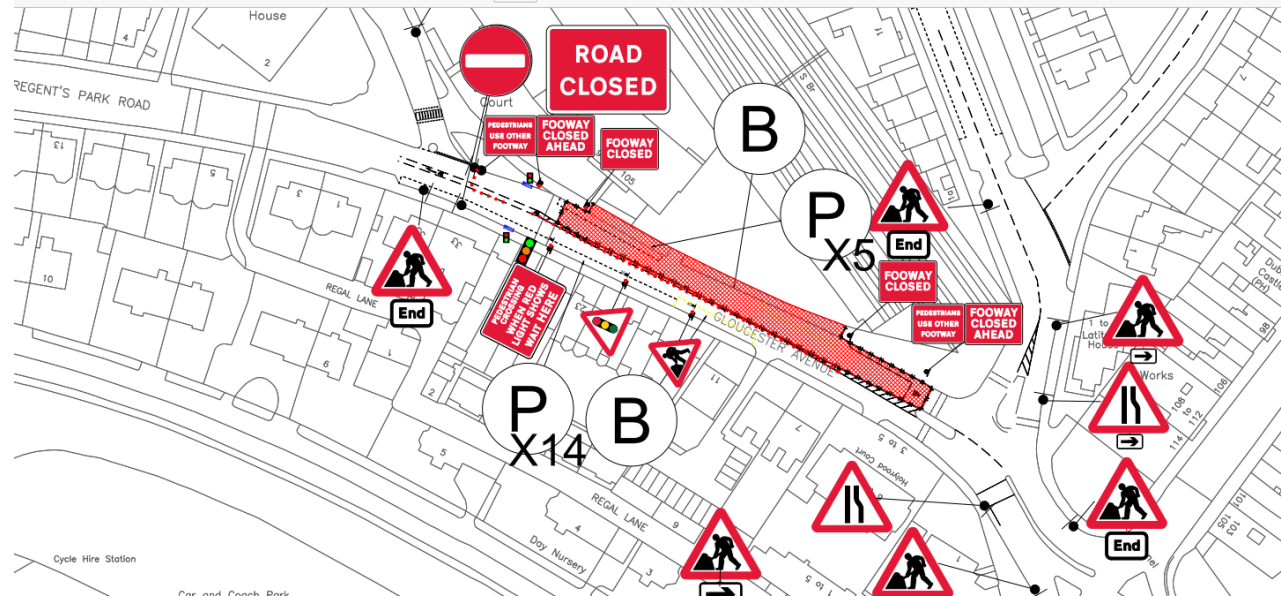
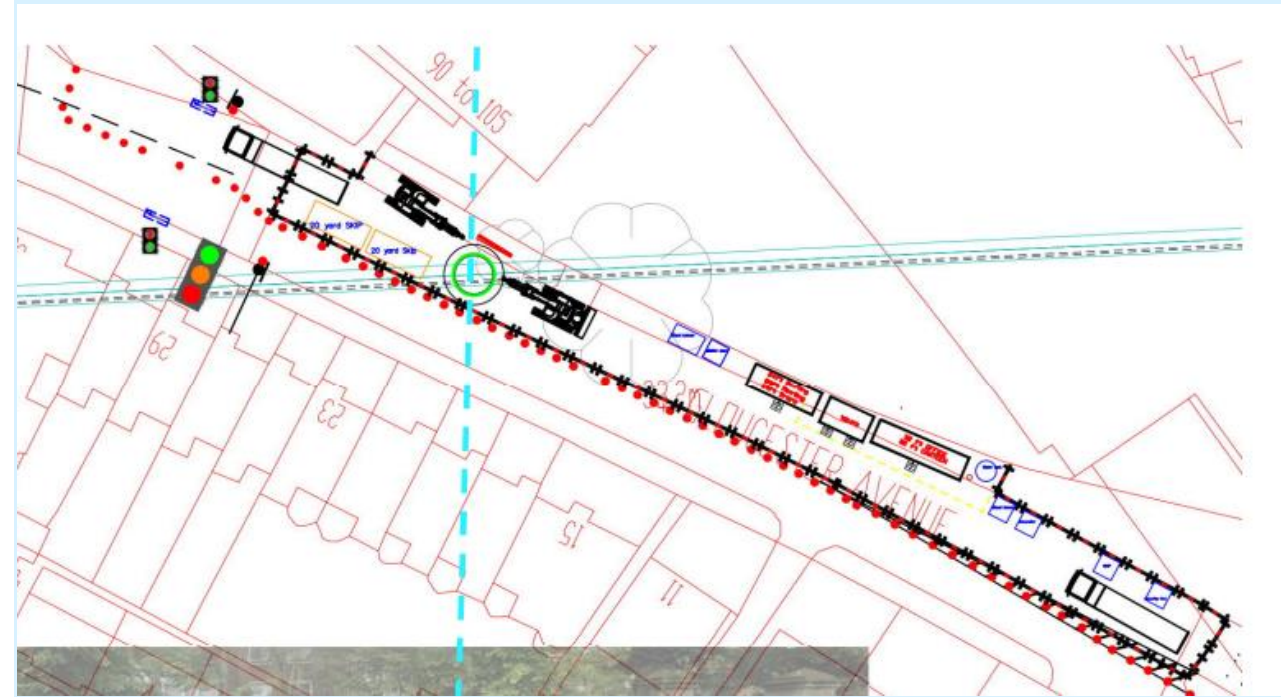

Diversion Route

The diversion route is:

Gloucester Avenue Junction



Regent's Park Road



St. Mark's Square



Prince Albert Road

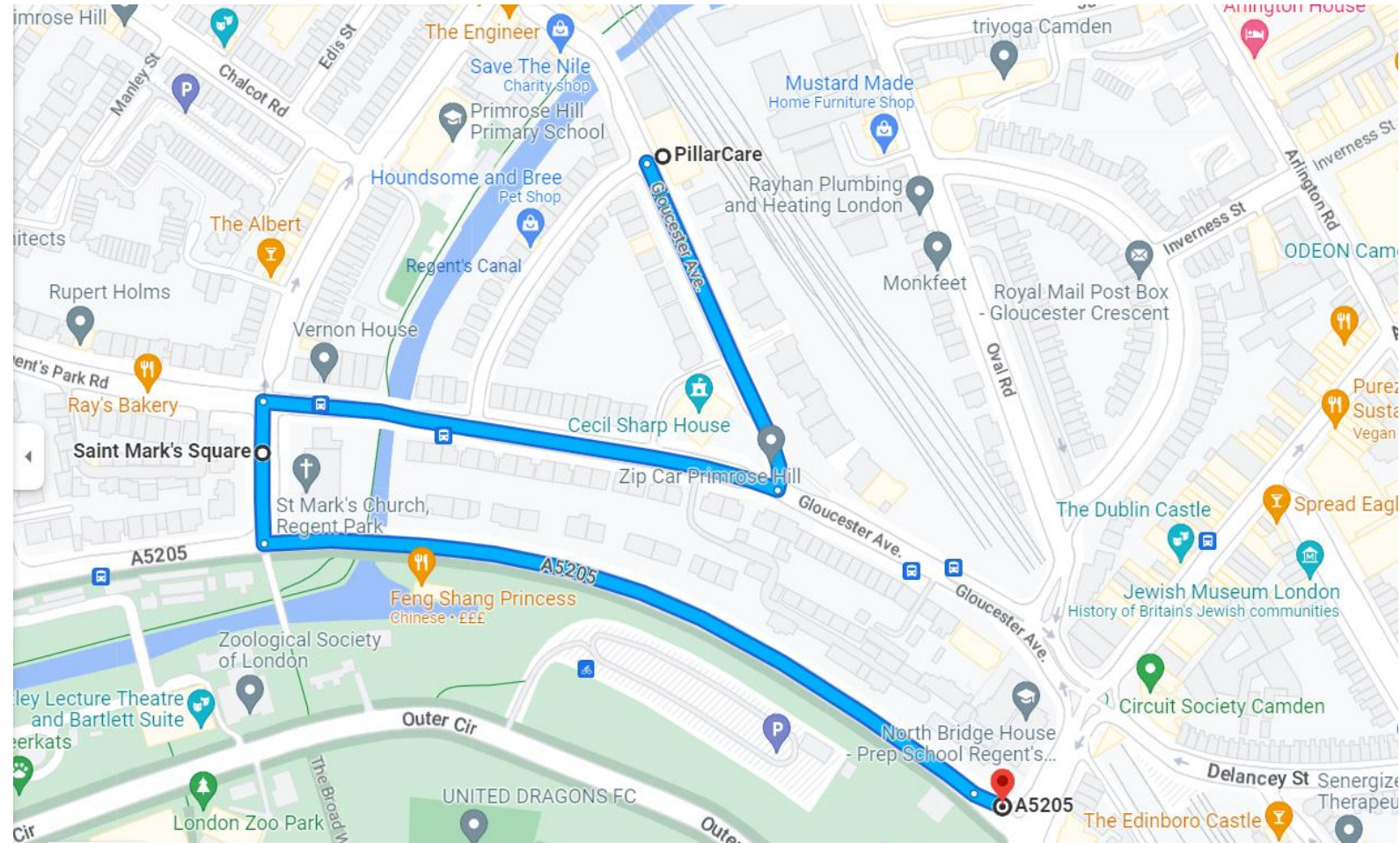

Parking bays and bus stops

- Parking bays – 17 parking bays need to be suspended for our work to take place
- The Eastern bound bus stop will be suspended. TfL will put in and confirm the diversion route. TfL have confirmed it will not be possible to put a temporary bus stop in place



Footpaths and cycle routes

- Footpaths and cycle routes - the footpath next to our site compound will be closed and a diversion in place. Cyclists will be asked to dismount and follow the footpath diversion

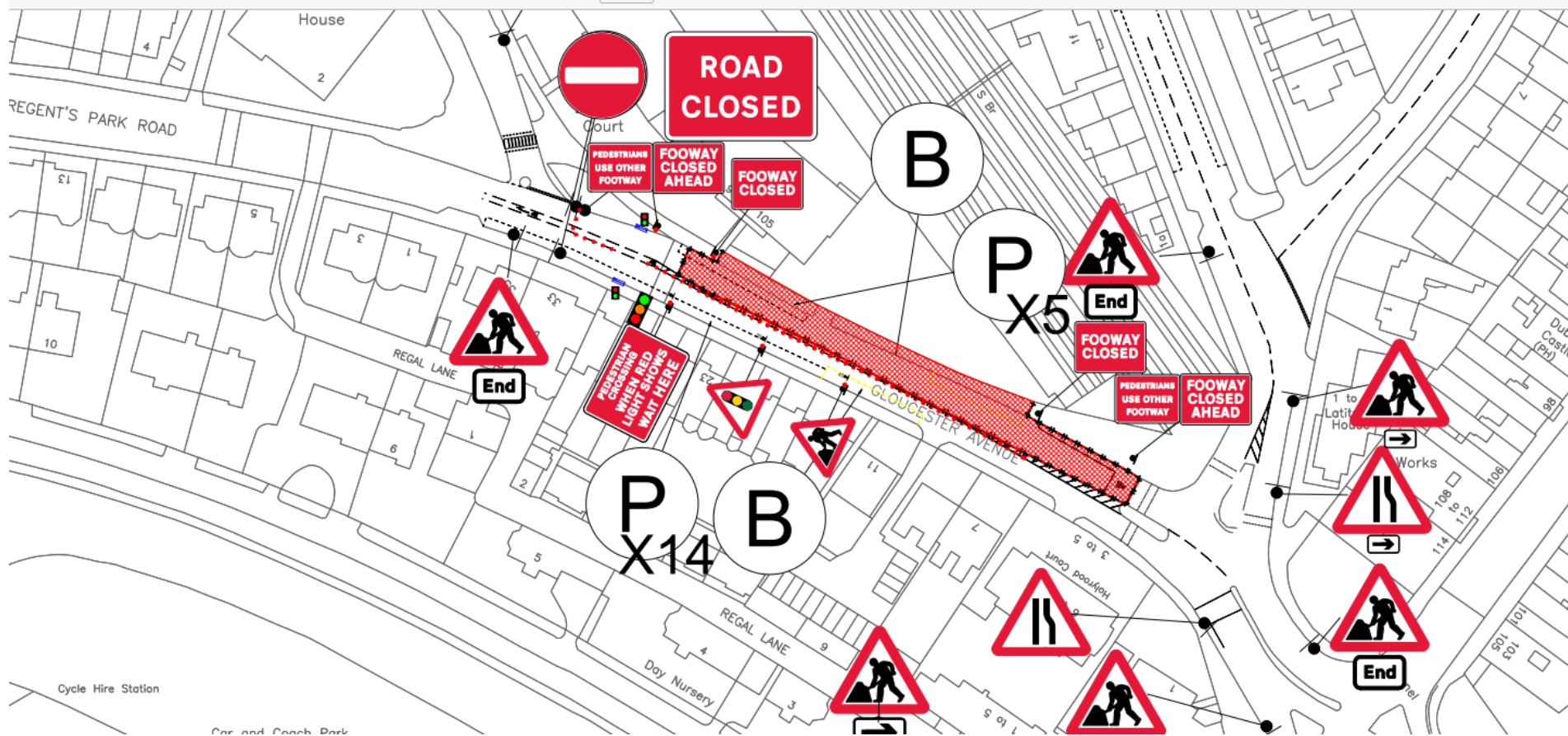

Next steps

- We will write to you before we start work
- We will contact property owners where we need to carry out an external survey
- Work updates will be sent out throughout the duration of our work
- We will carry out a full reinstatement when we finish in early 2024
- You can contact us on **0800 316 9800** – lines are open 24/7 and quote the reference number: **00346914**

Questions



Thank you