



## Notice of road closures, Banbury Road and Warwick Road, Boddington

April 2023 | [www.hs2.org.uk](http://www.hs2.org.uk)

High Speed Two (HS2) is the new high speed railway for Britain. If you have any questions or enquiries about our work, please contact our Helpdesk to find out more. You can sign up for regular updates in your local area at [www.hs2inwarwickshire.co.uk](http://www.hs2inwarwickshire.co.uk).

### What are we doing?

This spring we will be carrying out highway work near the junction of Banbury Road and Warwick Road near Boddington. This is one of first stages of joining the existing highway to the Banbury Road Overbridge. Road closures will be required initially, but to reduce highway impacts, much of this work will be completed using traffic lights.

The work will involve the installation of drainage systems and a vehicle safety barrier. It will require the full closure of Banbury Road for 4 days in early May followed by the closure of Warwick Road for approximately 2 weeks. The safety barrier is required for the safety of road users and our staff as the construction area will be near to the road.

Once the drainage and safety barrier are installed, Banbury Road will then have two-way traffic lights for approximately ten weeks while we continue to construct the new permanent highway realignment next to the current road. We are working on construction methods to reduce the impact on highway users, and so these traffic lights may be removed earlier if possible.

### When will these works take place?

A section of the Banbury Road will be fully closed, 24-hours a day, from **Tuesday 2 May to Friday 5 May**. This section of road will also have traffic management from Friday 5 May to the middle of July 2023.

A section of the Warwick Road will be fully closed, **24-hours a day, from Tuesday 9 May to Wednesday 24 May 2023**.

These dates may be subject to change due to circumstances outside of our control, such as weather and local authority consent.

**If you have a question about HS2 or our works, please contact our HS2 Helpdesk team on 08081 434 434 or email [hs2enquiries@hs2.org.uk](mailto:hs2enquiries@hs2.org.uk)**

### Duration of works

A section of Banbury Road will be fully closed from Tuesday 2 May 2023 for 4 days. Followed by traffic lights from 5 May to the middle of July.

A section of Warwick Road will be fully closed from Sunday 9 May to Monday 24 May 2023.

Our contractors may be on site for one hour's start-up and shutdown either side of these times.

### What to expect

A section of Banbury Road will be closed 24-hours a day for 4 days in May.

A section of Warwick Road will be closed 24-hours a day for 16 days in May.

Two-way traffic lights along a section of Banbury Road for into the Summer.

### What we will do

Respond promptly to any complaints and take appropriate action.

Take care to respect the community.

# Notice of road closures, Banbury Road and Warwick Road, Boddington

Notification



[www.hs2.org.uk](http://www.hs2.org.uk)

## Where will the works take place?

The image below, shows the section of road that will be that will be fully closed 24-hours a day in May:

**Banbury Road from 2 May to 5 May.**

**Warwick Road from 9 May to 24 May.**

To reduce disruption, these roads will not be closed at the same time.

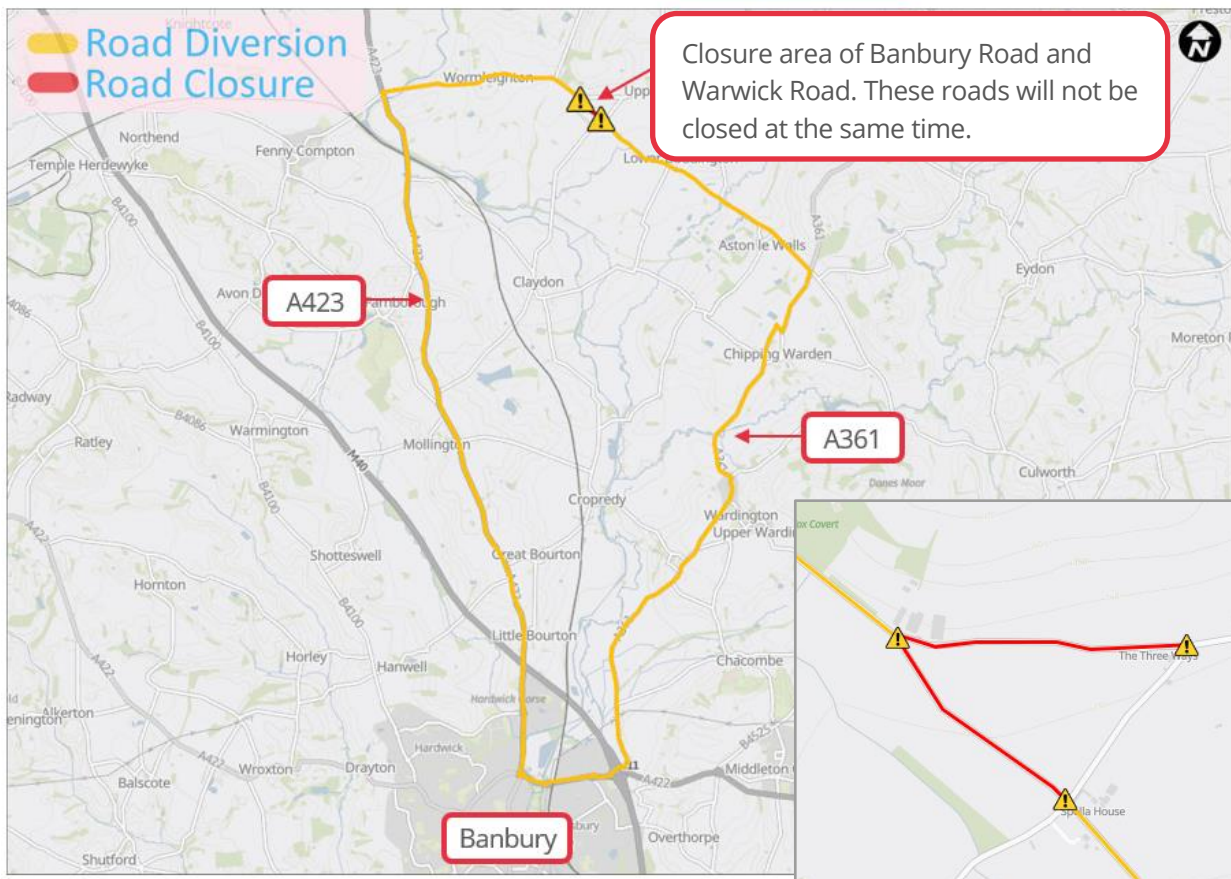

Contact our HS2 Helpdesk team on **08081 434 434**



# Keeping you informed

We are committed to keeping you informed about work on HS2. This includes ensuring you know what to expect and when to expect it, as well as how we can help.

## Residents' Charter and Commissioner

The Residents' Charter is our promise to communicate as clearly as we possibly can with people who live along or near the HS2 route.  
[www.gov.uk/government/publications/hs2-residents-charter](http://www.gov.uk/government/publications/hs2-residents-charter)

We also have an independent Residents' Commissioner whose job is to make sure we keep to the promises we make in the Charter and to keep it under constant review. Find reports at:  
[www.gov.uk/government/collections/hs2-ltd-residents-commissioner](http://www.gov.uk/government/collections/hs2-ltd-residents-commissioner)

You can contact the Commissioner at:  
[residentscommissioner@hs2.org.uk](mailto:residentscommissioner@hs2.org.uk)

## Construction Commissioner

The Construction Commissioner's role is to mediate and monitor the way in which HS2 Ltd manages and responds to construction complaints. You can contact the Construction Commissioner by emailing:  
[complaints@hs2-cc.org.uk](mailto:complaints@hs2-cc.org.uk)

## Property and compensation

You can find out all about HS2 and properties along the line of route by visiting:  
[www.gov.uk/government/collections/hs2-property](http://www.gov.uk/government/collections/hs2-property)  
Find out if you're eligible for compensation at:  
[www.gov.uk/claim-compensation-if-affected-by-hs2](http://www.gov.uk/claim-compensation-if-affected-by-hs2)

## Holding us to account

If you are unhappy for any reason you can make a complaint by contacting our HS2 Helpdesk team. For more details on our complaints process, please visit our website:  
[www.hs2.org.uk/how-to-complain](http://www.hs2.org.uk/how-to-complain)

## Contact Us

Contact our HS2 Helpdesk team all day, every day of the year on:



Freephone **08081 434 434**



Minicom **08081 456 472**



Email **[hs2enquiries@hs2.org.uk](mailto:hs2enquiries@hs2.org.uk)**

Write to:

**FREEPOST**

**HS2 Community Engagement**

Website **[www.hs2.org.uk](http://www.hs2.org.uk)**

To keep up to date with what is happening in your local area, visit:  
**[www.hs2inyourarea.co.uk](http://www.hs2inyourarea.co.uk)**

**Please contact us if you'd like a free copy of this document in large print, Braille, audio or easy read. You can also contact us for help and information in a different language.**

HS2 Ltd is committed to protecting personal information. If you wish to know more about how we use your personal information please see our Privacy Notice  
<https://www.gov.uk/government/publications/high-speed-two-ltd-privacy-notice>

**Reference number:** HS2-MW-EK-PH1-Ar-Ce-C2-Traf-22-22/03/2023

High Speed Two (HS2) Limited, registered in England and Wales.  
Registered office: Two Snowhill, Snow Hill Queensway, Birmingham B4 6GA.  
Company registration number: 06791686. VAT registration number: 888 8512 56.