



## Notice of road closure, Rocky Lane

February 2023 | [www.hs2.org.uk](http://www.hs2.org.uk)

High Speed Two (HS2) is the new high speed railway for Britain. If you have any questions or enquiries about our work, please contact our Helpdesk to find out more. You can sign up for regular updates in your local area at [www.hs2inyourarea.co.uk](http://www.hs2inyourarea.co.uk).

### What are we doing?

To allow us to provide a water supply to our Rocky Lane Compound, we need to carry out connection works to the existing Thames Water main that is buried below Rocky Lane carriageway. This will supply the compound and help to reduce the number of vehicles delivering to the site.

Our utilities subcontractor, Clancy, has identified existing cables and pipes already in the ground. The water pipe identified is in the centre of the carriageway therefore to ensure these works are completed safely we will need to implement a full 24-hour road closure for 5 days.

The water connection process involves excavating at the location of the water main and tapping into the main. The water supply to adjacent properties will not be affected during these works. Once complete, the excavations will be backfilled and carriageway resurfaced.

Please note, as we are unsure of the condition the underground pipes may be in, if they require further repair which we cannot undertake on the day, we will need to backfill the excavation and return to complete the works at a later date when we have the necessary mitigation in place.

### When will these works take place?

The road will be closed 24 hours a day between 27 February and 3 March.

These dates are subject to change due to circumstances beyond our control. Should we finish the works early, the closure will be removed.

**If you have a question about HS2 or our works, please contact our HS2 Helpdesk team on 08081 434 434 or email [hs2enquiries@hs2.org.uk](mailto:hs2enquiries@hs2.org.uk)**

### Duration of works

Works will take place on the following days:

- Monday 27 February – Friday 3 March

The road closure will be in place for 24 hours a day.

### What to expect

Varied activities with both quiet and busier periods.

A fully signposted diversion route.

### What we will do

Manage any environmental impacts, such as traffic and noise.

Respond promptly to any complaints and take appropriate action.

# Notice of road closure, Rocky Lane

Notification



## Where will the road closure be?

The map below shows the road closure in place 24 hours day between Monday 13 February and Friday 17 February.

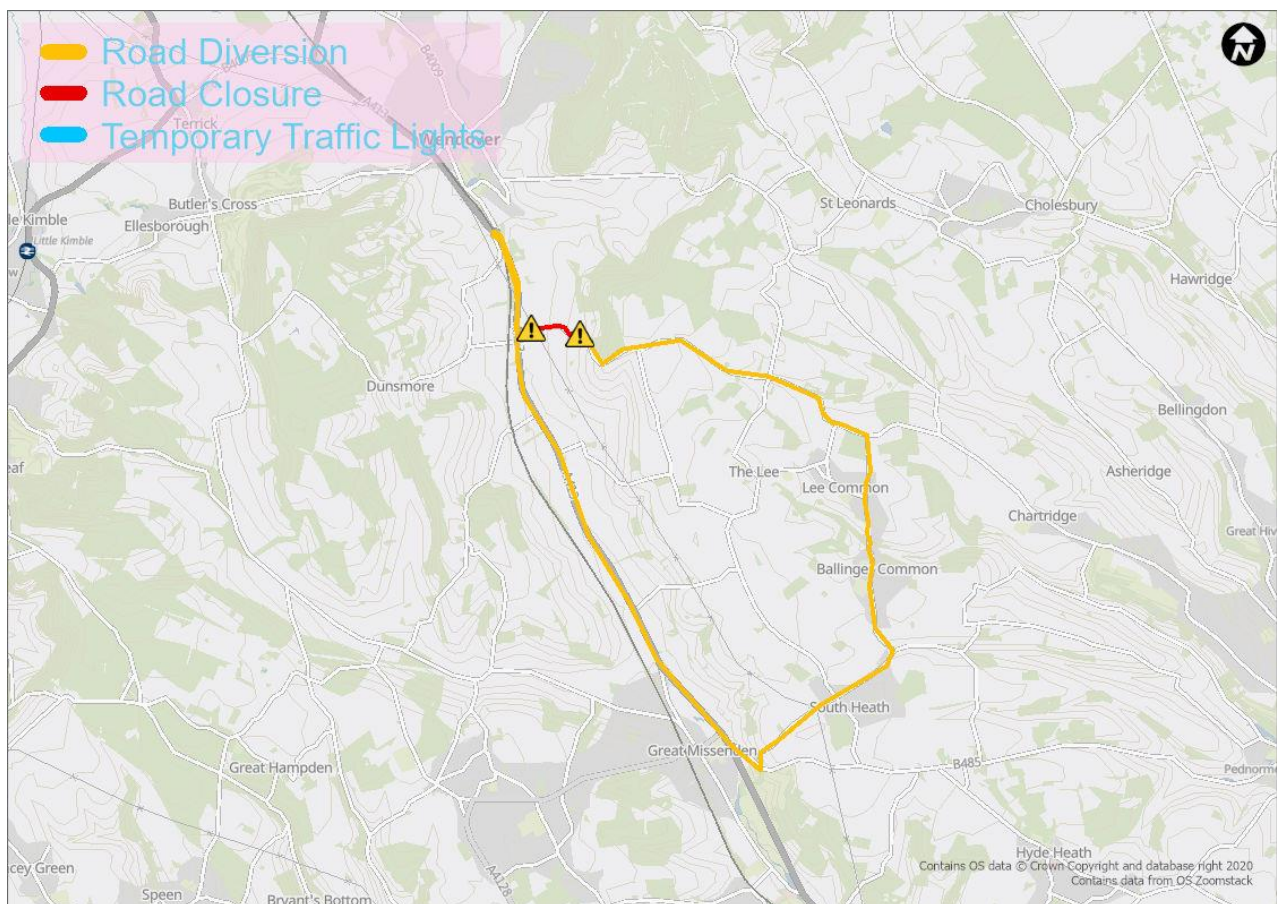

# Notice of road closure, Rocky Lane



## How will this affect me?

Road users will need to follow the suggested diversion route for access around the closure. We would suggest allowing for additional journey time during this period. Emergency access will still be maintained throughout this period.

## What will you be working on next?

In early 2023 we commenced works on the Rocky Lane bridge, in January we began sheet piling adjacent to Rocky Lane, this will enable us to begin the earthworks phase of construction and protect the earth while the bridge is constructed.

The Rocky Lane diversion and bridge are planned to be operational in 2024 and will eventually carry traffic over the HS2 trace.

## Will there be any more closures?

There may be further closures needed in this area to complete these particular works due to circumstances outside of our control and future closures for other works in this area will be necessary, we will communicate any further information on this in due course.





# Keeping you informed

We are committed to keeping you informed about work on HS2. This includes ensuring you know what to expect and when to expect it, as well as how we can help.

## Residents' Charter and Commissioner

The Residents' Charter is our promise to communicate as clearly as we possibly can with people who live along or near the HS2 route.  
[www.gov.uk/government/publications/hs2-residents-charter](http://www.gov.uk/government/publications/hs2-residents-charter)

We also have an independent Residents' Commissioner whose job is to make sure we keep to the promises we make in the Charter and to keep it under constant review. Find reports at:  
[www.gov.uk/government/collections/hs2-ltd-residents-commissioner](http://www.gov.uk/government/collections/hs2-ltd-residents-commissioner)

You can contact the Commissioner at:  
[residentscommissioner@hs2.org.uk](mailto:residentscommissioner@hs2.org.uk)

## Construction Commissioner

The Construction Commissioner's role is to mediate and monitor the way in which HS2 Ltd manages and responds to construction complaints. You can contact the Construction Commissioner by emailing:  
[complaints@hs2-cc.org.uk](mailto:complaints@hs2-cc.org.uk)

## Property and compensation

You can find out all about HS2 and properties along the line of route by visiting:  
[www.gov.uk/government/collections/hs2-property](http://www.gov.uk/government/collections/hs2-property)  
Find out if you're eligible for compensation at:  
[www.gov.uk/claim-compensation-if-affected-by-hs2](http://www.gov.uk/claim-compensation-if-affected-by-hs2)

## Holding us to account

If you are unhappy for any reason you can make a complaint by contacting our HS2 Helpdesk team. For more details on our complaints process, please visit our website:  
[www.hs2.org.uk/how-to-complain](http://www.hs2.org.uk/how-to-complain)

## Contact Us

Contact our HS2 Helpdesk team all day, every day of the year on:

 Freephone **08081 434 434**

 Minicom **08081 456 472**

 Email **[hs2enquiries@hs2.org.uk](mailto:hs2enquiries@hs2.org.uk)**

Write to:

**FREEPOST**

**HS2 Community Engagement**

Website **[www.hs2.org.uk](http://www.hs2.org.uk)**

To keep up to date with what is happening in your local area, visit:  
**[www.hs2inyourarea.co.uk](http://www.hs2inyourarea.co.uk)**

**Please contact us if you'd like a free copy of this document in large print, Braille, audio or easy read. You can also contact us for help and information in a different language.**

HS2 Ltd is committed to protecting personal information. If you wish to know more about how we use your personal information please see our Privacy Notice  
<https://www.gov.uk/government/publications/high-speed-two-ltd-privacy-notice>

**Reference number: HS2-MW-EK-Ph1-Ar-Ce-C2-Prog-works-6-01/09/2023** 1MC12-EKF-IN-NTE-CS03-000063

High Speed Two (HS2) Limited, registered in England and Wales.  
Registered office: Two Snowhill, Snow Hill Queensway, Birmingham B4 6GA.  
Company registration number: 06791686. VAT registration number: 888 8512 56.