



Road closure and construction update, near Wormleighton and Boddington

November 2022 | www.hs2.org.uk

High Speed Two (HS2) is the new high speed railway for Britain. We are following Government and Public Health England (PHE) advice on working safely during the pandemic. You can sign up for regular updates in your local area at www.hs2inyourarea.co.uk.

What are we doing?

We are entering the main phase of construction in the Wormleighton and Boddington area where we will be building the Banbury Road and Claydon Road overbridges. As part of these works, there will be a phased series of road closures commencing Autumn 2022. We have programmed these works to avoid, wherever possible, overlapping road closures.

During the **first phase** we will be carrying out utility surveys along Wormleighton Road and these works will require a daytime closure of a section of Wormleighton Road for approximately 1 week.

Our **second phase** will involve the creation of a crossing point on Banbury Road. To carry out this work safely, a full road closure will be required for approximately 2 weeks.

During **phase three** we will be constructing an overbridge on Claydon Road in Lower Boddington. These works will take approximately 18 to 24 months to complete and will require a full road closure for the duration of the construction period. Our construction progress this winter may be affected by the weather and ground conditions. Some local Public Rights of Way (PROWs) changes may also be required and further information will be published when these details are confirmed.

In addition to the work listed above, in October will be installing a temporary bridge across the A361, next to our compound in Chipping Warden. Further updates on this will be published when the bridge installation programme has been finalised.

When will these works take place?

A section of the Wormleighton Road will be closed 9.30am to 3.30pm, Thursday 20 October to Friday 28 October 2022.

A section of Banbury Road will be closed 24-7 from 8am Monday 31 October to 6pm Saturday 12 November 2022.

A section of Claydon Road will be closed 24-7 from Monday 14 November 2022 for approximately 18-24 months.

Duration of works

Works will commence

Wormleighton Road-

Thursday 20 October to Friday 28 October 2022.

Banbury Road- 24-7 full road closure from Monday 31 October to Saturday 12 November 2022.

Claydon Road- full closure from Monday 14 November 2022 until 2024.

Works will be carried out within normal working hours, however some additional evening or weekend working may be required when necessary.

What to expect

Daytime road closures of Wormleighton Road for 1 week.

Full 24-7 closure of Banbury Road for 2 weeks.

Full 24-7 closure of Claydon Road for 18-24 months.

What we will do

Manage any environmental impacts, such as traffic and noise.

Respond promptly to any complaints and take appropriate action.

Road closure and construction update, near Wormleighton and Boddington

www.hs2.org.uk

Notification



Where will the works take place - Wormleighton Road

On Wormleighton Road, to accurately identify utilities in the highway, we will be carrying out trial hole surveys and using ground penetrating radar. This work was postponed in August due to urgent water utility work. It will require a daytime closure of the Wormleighton Road for just over 1 week during off-peak hours.

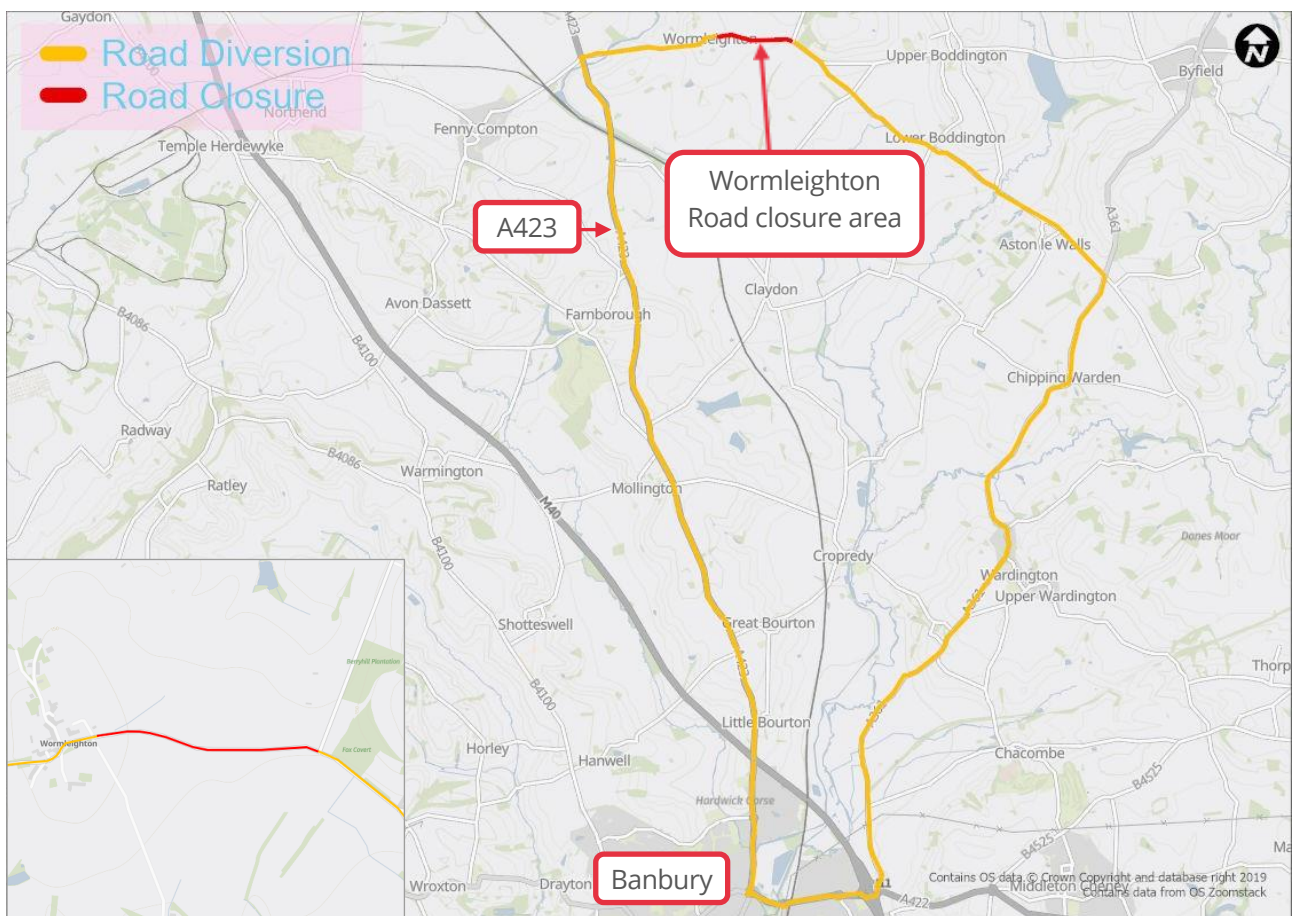

Road closure and construction update, near Wormleighton and Boddington

www.hs2.org.uk

Notification



Banbury Road

On Banbury Road, we will be creating a reinforced crossing area for our construction equipment to cross the highway. This is required in order to access an area between Banbury Road and Warwick Road where earthworks activities are taking place as part of the Banbury Road Overbridge. In order to carry out this work safely, a full road closure will be required for approximately 2 weeks.

The closure times for these works may be affected by the installation of a temporary bridge over the A361 Byfield Road near Chipping Warden. Therefore, depending on the progress of the installation of the A361 temporary bridge, some weekend closures may be lifted to accommodate diverted traffic.

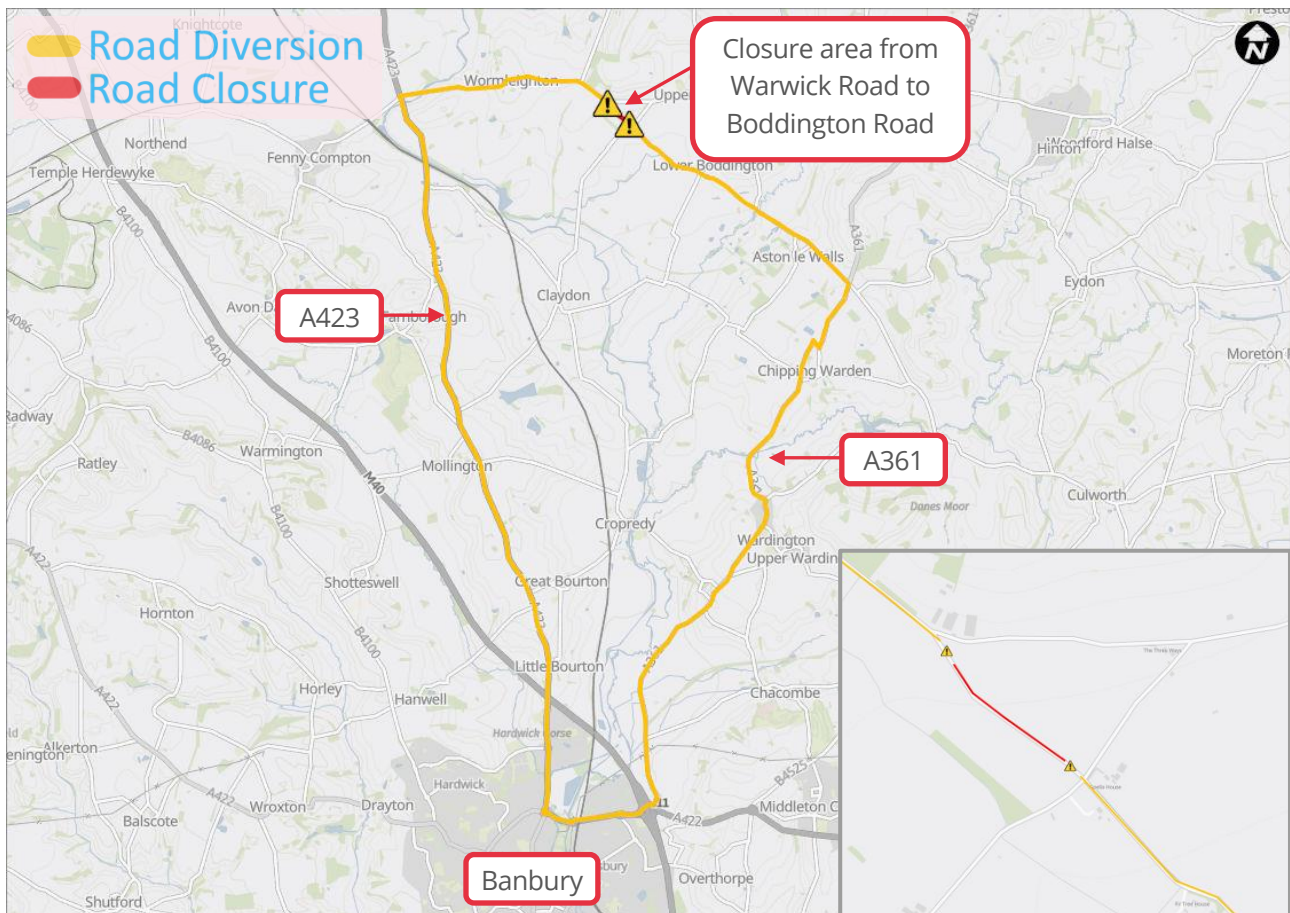

Road closure and construction update, near Wormleighton and Boddington

www.hs2.org.uk

Notification



Claydon Road

An overbridge is being constructed on Claydon Road in Lower Boddington to allow the Claydon Road to pass over the HS2 line. The construction of this bridge will take approximately 18 to 24 months to complete and will commence this November. A full road closure will be required for the duration of the construction period, until approximately 2024.

PRoWs known as AC1 and AC2, which form part of the Millennium Way, may be affected by this closure. We will publish a PRoW update when details are finalised.

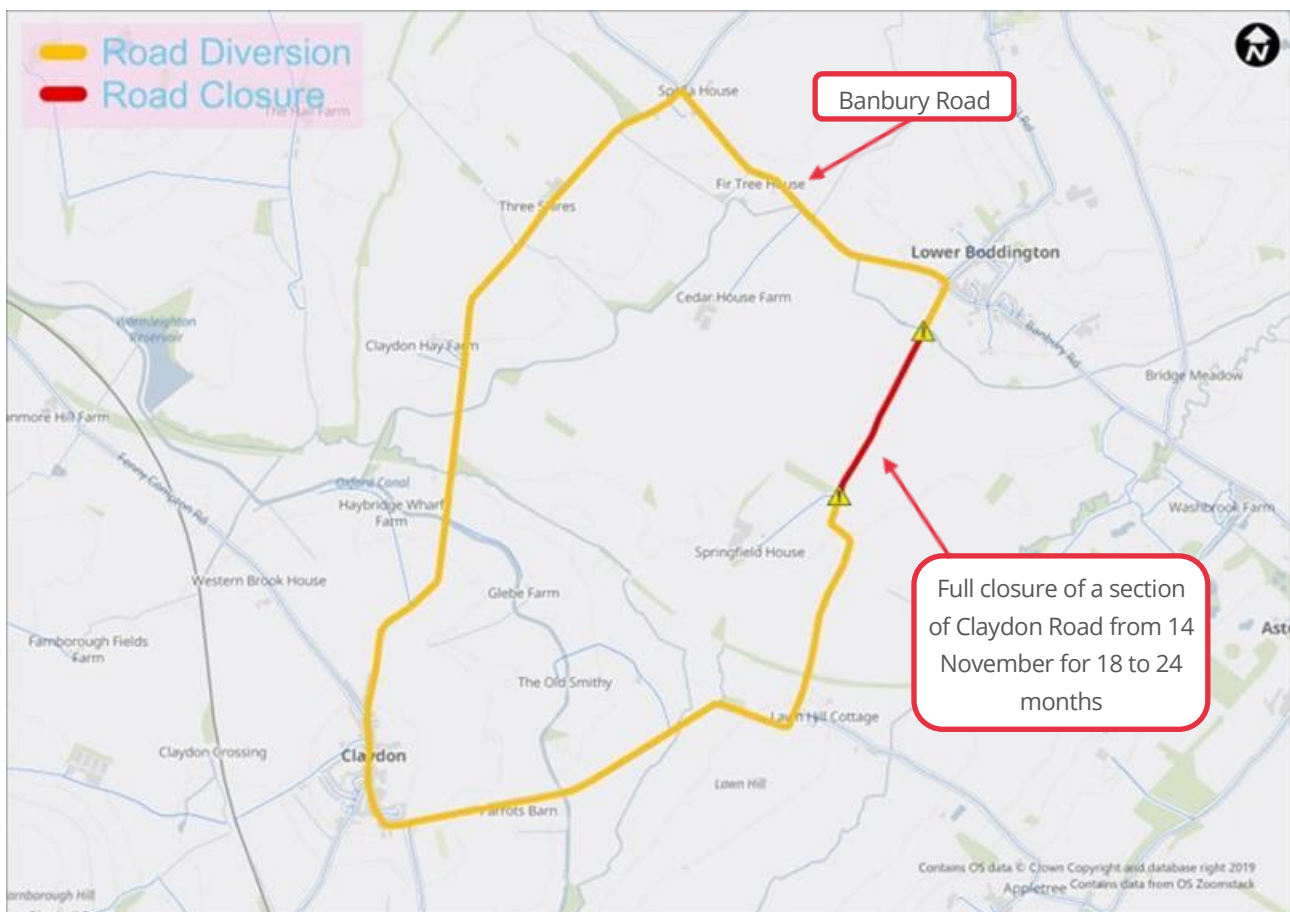

Banbury Road Overbridge

Road users travelling towards Wormleighton from Boddington will pass over the HS2 line on a new road bridge, located near to the junction with Warwick Road. Banbury Road will also be realigned with the construction of new sections of highway on the south side of the HS2 line.

As much of the new highway and bridge construction will take place on land next to the existing highway, road users will be able to travel along Banbury Road for the majority of the construction period. There will be temporary closures required when we connect the new road to the existing highway.

We have already started constructing the bridge foundations and over the next few months more of the structure will become visible to passing traffic.

Banbury Road Overbridge is expected to be operational in 2024.

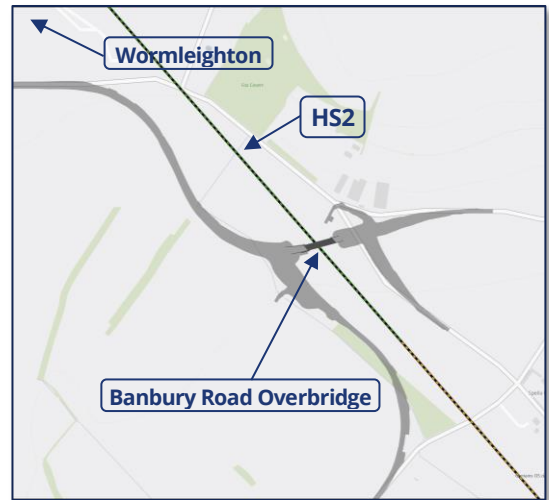

Figure 1: The above image shows the location of the Banbury Road Overbridge and where it will cross over HS2, the areas shaded in dark grey show the areas in which we will be working while we construct the realignment of Banbury Road.

Claydon Road Overbridge

To ensure that Claydon and Boddington remain connected when HS2 is in operation, a road bridge will be constructed for Claydon Road to pass over the HS2 line.

The construction of the bridge will take approximately 18 to 24 months to build, with work commencing later this year.

Prior to constructing the bridge we will first need to divert some utilities, as well as carry out piling work to prepare the foundations.

The bridge will be built at the same location as the existing highway, so a full closure of Claydon Road is required for 18 to 24 months commencing in November 2022.

Claydon Road Overbridge is expected to be operational in 2024.

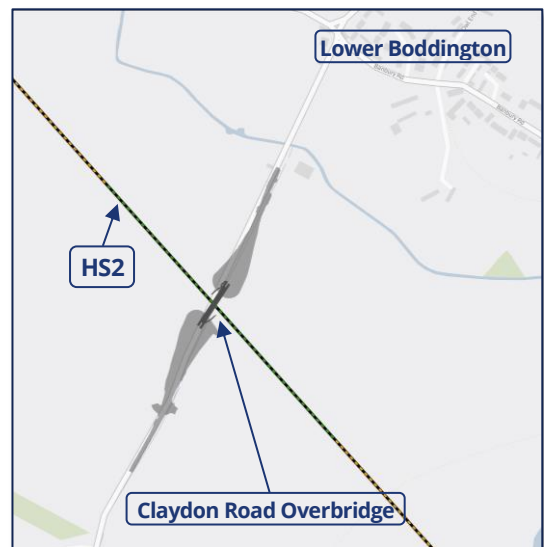

Figure 2: The above image shows the Claydon Road Overbridge where it will cross over HS2 the areas shaded in dark grey show the areas in which we will be working while we reconstruct this section of Claydon Road.

Keeping you informed

We are committed to keeping you informed about work on HS2. This includes ensuring you know what to expect and when to expect it, as well as how we can help.

Residents' Charter and Commissioner

The Residents' Charter is our promise to communicate as clearly as we possibly can with people who live along or near the HS2 route.
www.gov.uk/government/publications/hs2-residents-charter

We also have an independent Residents' Commissioner whose job is to make sure we keep to the promises we make in the Charter and to keep it under constant review. Find reports at:
www.gov.uk/government/collections/hs2-ltd-residents-commissioner

You can contact the Commissioner at:
residentscommissioner@hs2.org.uk

Construction Commissioner

The Construction Commissioner's role is to mediate and monitor the way in which HS2 Ltd manages and responds to construction complaints. You can contact the Construction Commissioner by emailing:
complaints@hs2-cc.org.uk

Property and compensation

You can find out all about HS2 and properties along the line of route by visiting:
www.gov.uk/government/collections/hs2-property

Find out if you're eligible for compensation at:
www.gov.uk/claim-compensation-if-affected-by-hs2

Holding us to account

If you are unhappy for any reason you can make a complaint by contacting our HS2 Helpdesk team. For more details on our complaints process, please visit our website:
www.hs2.org.uk/how-to-complain

Contact Us

Contact our HS2 Helpdesk team all day, every day of the year on:

 Freephone **08081 434 434**

 Minicom **08081 456 472**

@ Email **hs2enquiries@hs2.org.uk**

Write to:

FREEPOST

HS2 Community Engagement

Website **www.hs2.org.uk**

To keep up to date with what is happening in your local area, visit:
www.hs2inyourarea.co.uk

Please contact us if you'd like a free copy of this document in large print, Braille, audio or easy read. You can also contact us for help and information in a different language.

HS2 Ltd is committed to protecting personal information. If you wish to know more about how we use your personal information please see our Privacy Notice
<https://www.gov.uk/government/publications/high-speed-two-ltd-privacy-notice>

Reference number HS2-MW-EK-Ph1-Ar-Ce-C2-Prog-works-25-11/10/2022

High Speed Two (HS2) Limited, registered in England and Wales.

Registered office: Two Snowhill, Snow Hill Queensway, Birmingham B4 6GA.

Company registration number: 06791686. VAT registration number: 888 8512 56.