



Update - Notice of short lane closure on Harvil Road

June 2022 | www.hs2.org.uk

High Speed Two (HS2) is the new high speed railway for Britain.

As we reintroduce face to face engagement, which is in addition to the ongoing virtual engagement, we will continue to follow government guidance on reducing the spread of Covid-19. The health and safety of our workforce and the communities we work within is our priority. Please contact the Helpdesk if you have any further questions relating to our response to the Covid-19 pandemic.

You can sign up for regular updates in your local area at www.hs2inHillingdon.co.uk

What we are doing

We wrote you recently to let you know that we would be carrying out remedial works on Harvil Road from the junction of Skip Lane, down to our Gate 1 site entrance gate. The works were due for completion 25 June between 8am and 1pm however, we need to extend the duration of the lane closure to allow us to relocate the fence line in the same area. These works will now take place between 8am and 5pm. The location of the work is shown on the map below:

We would like to apologise in advance for any disruption or inconvenience this may cause. Every effort is being taken to ensure that these works are carried out in the least impactful way. We will ensure that disruption is kept to a minimum.

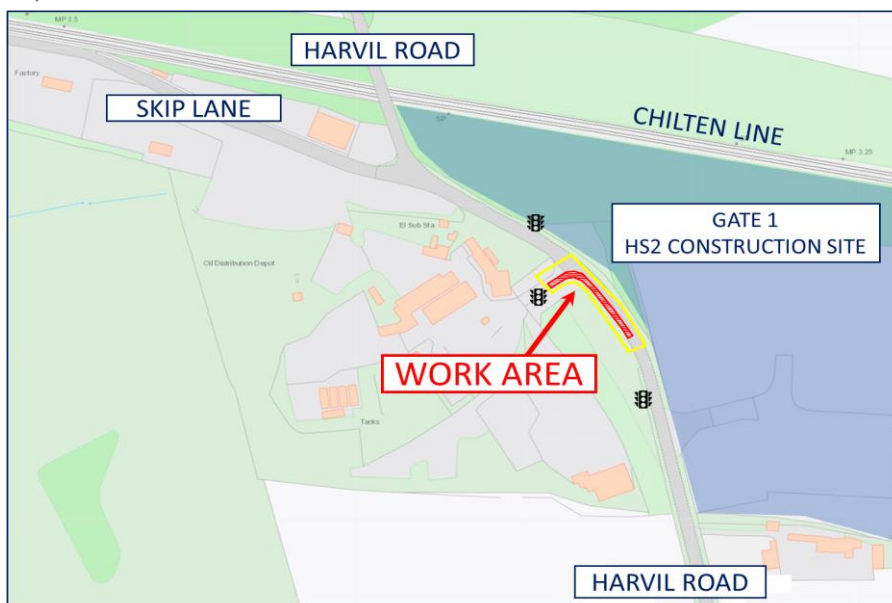

If you have a question about HS2 or our works, please contact our HS2 Helpdesk team on 08081 434 434 or email hs2enquiries@hs2.org.uk

Duration of works

25 June from 8am to 5pm

We may be on site for an hour before the start and/or end of the shift

Lane closure will be in place until works are completed

What to expect

Temporary traffic management and lane closure in place

Operatives in the work area, as well as barriers and asphalt equipment

What we will do

Maintain access to your property at all times

Keep disruption to a minimum

Provide updates at HS2inHillingdon.co.uk

Keeping you informed

We are committed to keeping you informed about work on HS2. This includes ensuring you know what to expect and when to expect it, as well as how we can help.

Residents' Charter and Commissioner

The Residents' Charter is our promise to communicate as clearly as we possibly can with people who live along or near the HS2 route.
www.gov.uk/government/publications/hs2-residents-charter

We also have an independent Residents' Commissioner whose job is to make sure we keep to the promises we make in the Charter and to keep it under constant review. Find reports at:
www.gov.uk/government/collections/hs2-ltd-residents-commissioner

You can contact the Commissioner at:
residentscommissioner@hs2.org.uk

Construction Commissioner

The Construction Commissioner's role is to mediate and monitor the way in which HS2 Ltd manages and responds to construction complaints. You can contact the Construction Commissioner by emailing:
complaints@hs2-cc.org.uk

Property and compensation

You can find out all about HS2 and properties along the line of route by visiting:
www.gov.uk/government/collections/hs2-property
Find out if you're eligible for compensation at:
www.gov.uk/claim-compensation-if-affected-by-hs2

Holding us to account

If you are unhappy for any reason you can make a complaint by contacting our HS2 Helpdesk team. For more details on our complaints process, please visit our website:
www.hs2.org.uk/how-to-complain

Contact Us

Contact our HS2 Helpdesk team all day, every day of the year on:

 Freephone **08081 434 434**

 Minicom **08081 456 472**

 Email **hs2enquiries@hs2.org.uk**

Write to:

FREEPOST

HS2 Community Engagement

Website **www.hs2.org.uk**

To keep up to date with what is happening in your local area, visit:
www.hs2inyourarea.co.uk

Please contact us if you'd like a free copy of this document in large print, Braille, audio or easy read. You can also contact us for help and information in a different language.

HS2 Ltd is committed to protecting personal information. If you wish to know more about how we use your personal information please see our Privacy Notice
<https://www.gov.uk/government/publications/high-speed-two-ltd-privacy-notice>

Reference number: HS2-EW-SCS-Ph1-Ar-So-S2-UT-1-27/05/22_02

High Speed Two (HS2) Limited, registered in England and Wales.
Registered office: Two Snowhill, Snow Hill Queensway, Birmingham B4 6GA.
Company registration number: 06791686. VAT registration number: 888 8512 56.

Call our HS2 Helpdesk team on **08081 434 434**