

Notice of works to the East of Euston Station

June 2022 | www.hs2.org.uk

High Speed Two (HS2) is the new high speed railway for Britain.

As we reintroduce face to face engagement, which is in addition to the ongoing virtual engagement, we will continue to follow government guidance on reducing the spread of Covid-19. The health and safety of our workforce and the communities we work within is our priority. Please contact Helpdesk if you have any further questions relating to our response to the Covid-19 pandemic. You can sign up for regular updates in your local area at: **HS2inCamden.co.uk**

Below is a summary of areas of work covered in this notice. Please continue to read the rest of this notification for further information about each part.

Works on Eversholt Street

We previously wrote to you regarding enabling works on Eversholt Street (HS2-MW-MD-Ph1-Eu-St-S3-Site-11-28/01/2022). **From Mid July 2022** we will begin the sewer upgrade works, trial holes and telecoms diversions. These works are necessary as we prepare for the HS2 Euston station. **These works include lane closures – please see next page for details. To minimise disruption, we are undertaking works concurrently and in phases. These works are planned to continue until early 2023.**

Interim taxi rank construction

We wrote to you in November 2021 regarding our enabling works at the above location (HS2-MW-MD-Ph1-Eu-St-S3-Prog-works-32-23/11/2021). We will now begin the main construction and we expect works to continue **until early 2023.**

Ground Investigation and Trial Holes in Euston Road

We previously wrote to you regarding ground investigation and trial holes surveys to the East of Euston Station (HS2-MW-MD-Ph1-Eu-St-S3-Site-11-28/01/2022), as we progress with the station enabling works, we will carry out further surveys on **Euston Road from Mid-July until mid-September 2022.** This helps us to plan works around the Metropolitan line.

If you have a question about HS2 or our works, please contact our HS2 Helpdesk team on 08081 434 434 or email HS2enquiries@hs2.org.uk.

Notification



Working hours:

- 8am to 6pm weekdays (excluding bank holidays)
- Weekends 8am to 6pm
- Night-time work (9pm to 5am) will be required for works that cannot take place during the day
- We will start-up and close-down activities up to one hour before and up to one hour after normal working hours above

What to expect:

- Alterations to public walkways;
- Bus stop suspensions;
- Partial road closures;

What we will do:

- Create temporary work sites and signage where surveys and investigations are taking place;
- We will add measures to reduce noise and dust
- Please note that changes to the programme may occur, and if these changes are likely to cause any disturbance, we will write to you again

Works on Eversholt Street from early July 2022 until early 2023

From early July we will begin works on Eversholt Street and these will be undertaken in phases through to early 2023. The first phase involves undertaking a series of trial hole surveys in the locations below. The surveys will help us to understand the condition of the sewer ahead of the main sewer works and also determine the location of other services in the area.

The first trial holes (indicated in **blue** below) will take place from **4th July to 18th July**. No traffic management measures will be in place other than the occasional use of 'Stop and Go' boards for deliveries. **Bus Stop 'A'** (indicated in **green** below) **will be temporarily suspended** and relocated to the north as close as possible by Transport for London. The footpath remains open and pedestrian access and egress to businesses will be maintained at all times.

The second set of trial holes (indicated in **red** below) will take place from **18th July to early August**. This is in the location of the temporary drop-off bay on Eversholt Street by the stairs next to Network Rail station, which will be suspended during these works. To facilitate these works there will be a **southbound lane closure of Eversholt Street** between Grafton Place and Doric Way (with access to all side streets remaining open.) **There will be no through route southbound to Euston Road. Buses travelling south on Eversholt Street (routes 168 and 253 towards Euston Road) will be on local diversion via Lidlington Place and Hampstead Road.** Bus Stop 'A' will remain suspended and relocated to the north on Eversholt Street. The footpath remains open and pedestrian access and egress to businesses will be maintained at all times.

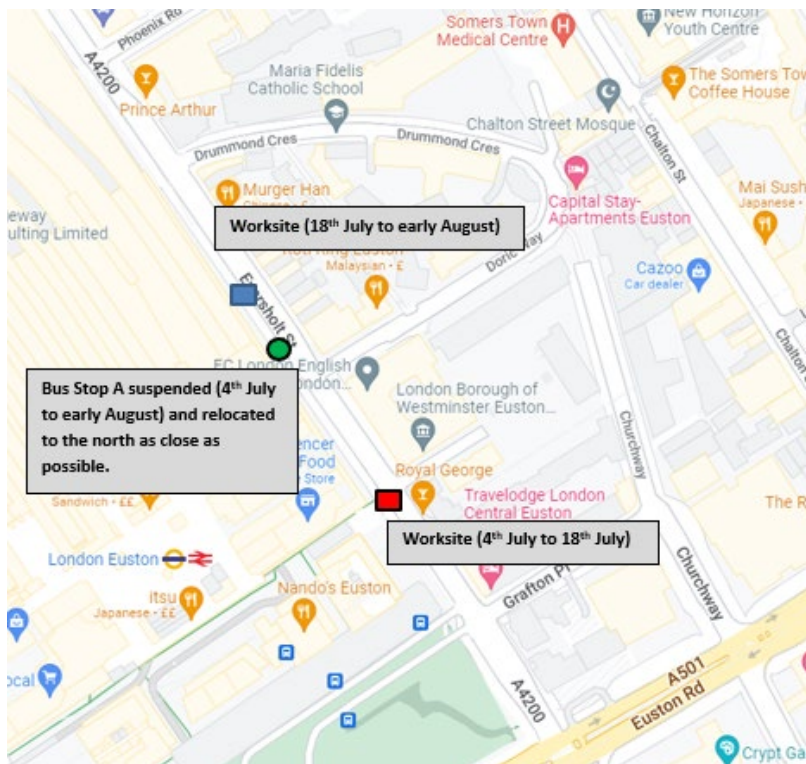

Location of trial holes

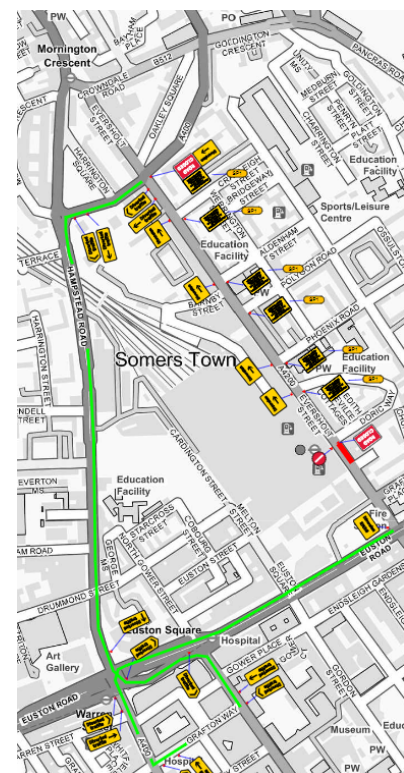

Bus / traffic diversion

What to expect

We recognise that construction work can be disruptive to those living or working nearby. The nature of our work often means some disturbance is unavoidable, but every effort is made to minimise any unnecessary noise. We will closely monitor all noise, vibration, and dust levels to ensure we do not exceed our agreed limits.

Updates will be sent to you regularly outlining the next stages of works in the area including any alterations to the programme. Please note that changes to the programme may occur, and if these changes are likely to cause any disturbance, we will write to you again.

Works will include:

- Temporary work sites where work is taking place;
- Suspension of Bus Stop A;
- Traffic diversions in place;
- Alterations to public walkways and traffic management will be kept at a minimum. This will keep the worksite safe and manage the flow of traffic;
- There may be some low levels of noise from the machinery being used to drill holes into the ground

Working hours

- 8am to 6pm weekdays (excluding bank holidays);
- 8am to 1pm Saturdays;
- We will start-up and close-down activities up to one hour before and up to one hour after normal working hours above

Interim taxi rank construction

From **July 2022 we will begin the main works for the interim Taxi Rank**. We expect works to **continue until early 2023**. The primary activities include using a piling rig to construct the canopy. We anticipate these works to be noisy, however we will do everything reasonably practicable to minimise noise disruption. The current taxi rank will move from Euston Garden (west) to Euston Gardens (east) once construction is complete. During the construction of the proposed HS2 station the new interim taxi set-down, pick-up and rank facility will serve Euston Train Station.



What to expect

We recognise that construction work can be disruptive to those living or working nearby. The nature of our work often means some disturbance is unavoidable, but every effort is made to minimise any unnecessary noise. We will closely monitor all noise, vibration, and dust levels to ensure we do not exceed our agreed limits. These works will not affect utility connections in the areas. **Updates will be sent to you regularly outlining the next stages of works in the area including any alterations to the programme.** Please note that changes to the programme may occur, and if these changes are likely to cause any disturbance, we will write to you again.

Works will include:

- Use of a rotary bored piling rig;
- Installation of cycle ramp for cyclist to dismount. Widening of Bus station exit to Euston Road;
- Pedestrian walk way configuration
Alterations to public walkways;
- Concrete and tarmac breakout;
- Use of pneumatic picker and a light pneumatic breaker mounted on a mini excavator. Any dust created will be controlled using water;
- Lowering and reinstatement of existing utilities;
- Heras fence panels will be fitted with acoustically rated panels/curtains around the worksite

Working hours

- 8am to 6pm weekdays (excluding bank holidays);
- 8am to 1pm Saturdays;
- On occasions it may be necessary to work 8am – 6pm Saturdays and Sundays during weekdays, night-time work (9pm to 5am) will be required for works that cannot take place during the day. This is to reduce the impact on the public and commuters at Euston Station;
- Intermittent delivery of materials to site before 7am and after 7pm for materials not permitted on London roads during the day and;
- We will start-up and close-down activities up to one hour before and up to one hour after normal working hours shown here.

Contact our HS2 Helpdesk team on **08081 434 434**

Euston Road Trial Hole from Mid-July until Mid-September 2022

From **Mid-July** we will be carrying out trial holes on Euston Road to help validate the diversion route for the new water main. The trial hole on the westbound carriageway will be completed at weekends (Saturday and Sunday) to reduce the impact on traffic and commuters at Euston Station. To facilitate these works, **Bus Stop 'AZ' (indicated in green below) will be suspended and relocated as close as possible by Transport for London.**

We will also be undertaking a trial hole on the eastbound side of Euston Road from late July for approximately four weeks. The works will be in the footway and pedestrian diversions will be in place. To facilitate the works **Bus Stop 'CH' (indicated in green below) will be suspended and relocated as close as possible by Transport for London.** These surveys will help us to understand more about the current ground conditions and inform our plan to upgrade the water main above the Metropolitan line. Pedestrian access will be maintained, and the roads will remain open.

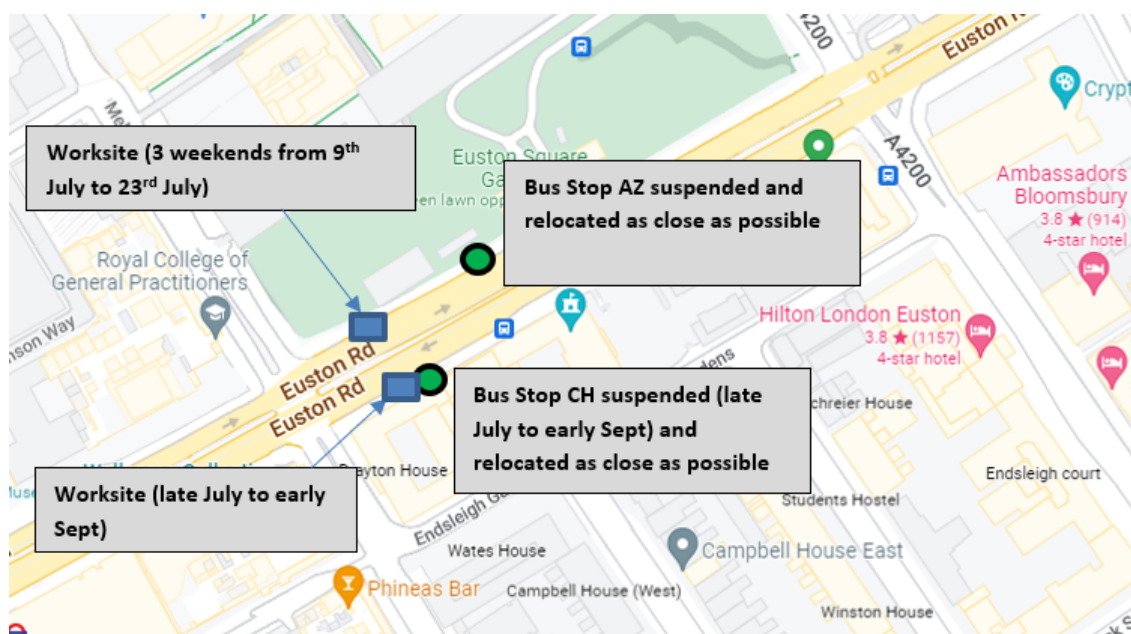

What to expect

We recognise that construction work can be disruptive to those living or working nearby. The nature of our work often means some disturbance is unavoidable, but every effort is made to minimise any unnecessary noise. We will closely monitor all noise, vibration, and dust levels to ensure we do not exceed our agreed limits. Please note that changes to the programme may occur, and if these changes are likely to cause any disturbance, we will write to you again.

Works will include:

- Temporary work sites where work is taking place;
- Alterations to public walkways;
- There may be some low levels of noise from the machinery being used to drill boreholes into the ground;
- Traffic management will be in place and kept to a minimum. This will keep the worksite safe and manage the flow of traffic;
- Intermittent delivery of materials/ machinery

Working hours

- 8am to 6pm weekdays (excluding bank holidays);
- Saturday and Sunday 8am to 6pm
- Night-time work (7pm – 5am) will be required for works that cannot take place during the day. This is to reduce the impact on the public and commuters at Euston Station;
- We will start-up and close-down activities up to one hour before and up to one hour after normal working hours above; and
- Intermittent delivery of materials to site before 7am and after 7pm for materials not permitted on London roads during the day.

Contact our HS2 Helpdesk team on **08081 434 434**

Keeping you informed

We are committed to keeping you informed about work on HS2. This includes ensuring you know what to expect and when to expect it, as well as how we can help.

Residents' Charter and Commissioner

The Residents' Charter is our promise to communicate as clearly as we possibly can with people who live along or near the HS2 route.

www.gov.uk/government/publications/hs2-residents-charter

We also have an independent Residents' Commissioner whose job is to make sure we keep to the promises we make in the Charter and to keep it under constant review. Find reports at:

www.gov.uk/government/collections/hs2-ltd-residents-commissioner

You can contact the Commissioner at:
residentscommissioner@hs2.org.uk

Construction Commissioner

The Construction Commissioner's role is to mediate and monitor the way in which HS2 Ltd manages and responds to construction complaints. You can contact the Construction Commissioner by emailing:
complaints@hs2-cc.org.uk

Property and compensation

You can find out all about HS2 and properties along the line of route by visiting:

www.gov.uk/government/collections/hs2-property

Find out if you're eligible for compensation at:
www.gov.uk/claim-compensation-if-affected-by-hs2

Holding us to account

If you are unhappy for any reason you can make a complaint by contacting our HS2 Helpdesk team. For more details on our complaints process, please visit our website:
www.hs2.org.uk/how-to-complain

Reference Number: HS2-MW-MD-Ph1-Eu-St-S3-CR-32-22/06/2022

Somali

Fadlan nala soo xiriir haddii bug-yarahaan bilaashka ah ku rabtid daabacad far waa-wayn, qoraalka indhoolaha, hab maqal ah ama si fudud loo akhrin karo. Waxaan xittaa macluumaadka ku bixin karnaa luqado kala duwan. Qof ayaad ka codsan kartaa inuu wakiil ka noqdo markaad la hadlayso HS2 Ltd.

Español

Póngase en contacto con nosotros en caso de que desee recibir una copia gratuita de este folleto en caracteres grandes, braille, audio o en formato de lectura fácil. También podemos proporcionar la información en distintos idiomas. No dude en pedirle a alguien que le represente en cualquier conversación con HS2, Ltd.

Français

Merci de nous contacter si vous désirez une copie de cette brochure en grands caractères, en braille, en version audio, ou en lecture simplifiée. Nous pouvons également vous fournir des informations dans différentes langues. Vous pouvez demander d'être représenté(e) par un tiers pour tout échange avec HS2 Ltd.

Bengali

যদি আপনি এই প্রচারপত্রটির বড় অক্ষরে, ব্রেইলে, অডিও বা সহজ পাঠযোগ্য বিনামূল্যের প্রতিলিপি পেতে চান তবে অনুগ্রহ করে আমাদের সাথে যোগাযোগ করুন। এছাড়াও আমরা বিভিন্ন ভাষায় তথ্য প্রদান করতে পারি। এইচএস২ লিমিটেড (HS2 Ltd.)-এর সাথে কোন আলোচনায় আপনাকে প্রতিনিধিত্ব করার জন্য আপনি কাউকে জিজ্ঞাসা করায় আপনাকে স্বাগত জানাই।

Contact Us

Contact our HS2 Helpdesk team all day, every day of the year on:

 Freephone **08081 434 434**

 Minicom **08081 456 472**

 Email **HS2enquiries@hs2.org.uk**

Write to:

FREEPOST

HS2 Community Engagement

Websites: **www.hs2.org.uk**

www.hs2inCamden.co.uk

Please contact us if you'd like a free copy of this document in large print, Braille, audio or easy read. You can also contact us for help and information in a different language.

HS2 Ltd is committed to protecting personal information. If you wish to know more about how we use your personal information please see our Privacy Notice <https://www.gov.uk/government/publications/high-speed-two-ltd-privacy-notice>

High Speed Two (HS2) Limited, registered in England and Wales. Registered office: Two Snowhill, Snow Hill Queensway, Birmingham B4 6GA. Company registration number: 06791686. VAT registration number: 888 8512 56