

Notice of survey work on Pipewood Lane, Dawson Lane, Pipe Lane and the B5014

March 2022 | www.hs2.org.uk

High Speed Two (HS2) is the new high speed railway for Britain. Working on behalf of HS2 Ltd, Kier is carrying out surveys and investigating ground conditions along the Phase 2a route.

What we are doing

We will be carrying out ground penetrating surveys to help us identify the location of buried utility services, such as gas, electric or water. These surveys are non-intrusive, we will use a machine that transmits an electromagnetic pulse into the ground. These pulses reflect off features in the ground, allowing us to collect data and to understand the depth of the buried utility services.

Along with ground penetrating surveys, we will carry out several other surveys. For the safety of both our workforce and motorists, we need to close Pipewood Lane, Dawson Lane and Pipe Lane overnight and install traffic lights on the B5014 during the day.

When the work will take place

Due to unforeseen circumstances, we were unable to complete the all the survey work during our last visit. We will now be returning from **Thursday 7 April to Friday 22 April 2022**. Please note that all our planned roadworks may be subject to change due to weather conditions or unforeseen circumstances.

Covid-19

We are working in line with Government and Public Health England (PHE) advice on working safely during the pandemic. For all events and engagement, we will carry out a risk assessment and put in place control measures to manage the risk of Covid-19 to the public and our staff. If you have any questions about this, please contact our Helpdesk to find out more. The health and safety of our workforce and the communities we affect is our key priority.

If you have a question about HS2 or our works, please contact our HS2 Helpdesk team on 08081 434 434 or email hs2enquiries@hs2.org.uk

Notification



Duration of works

From **Thursday 7 April to Friday 22 April** between 8pm and 6am (excluding weekends)

Please note that the time and date in this notification **may** be subject to change

What to expect

Road closure on Pipewood Lane between **8pm** and **6am**

Road closure on Pipe Lane between **8pm** and **6am**

Road closure on Dawson Lane between **8pm** and **6am**

Temporary traffic lights on the B5014 between **9am** and **4pm**

Diversion routes

Some Delays

Low levels of noise

What we will do

Maintain access to businesses and properties within the closure using interactive communication boards

Notice of survey work on Pipewood Lane, Dawson Lane, Pipe Lane and the B5014

www.hs2.org.uk

Notification



How this will affect your journey

On **Monday 11 April** to **Friday 22 April** (excluding weekends) from **8pm** to **6am** we need to close Pipewood Lane, Dawson Lane, and Pipe Lane. During the closures, we will put a signed diversion route in place. We will also have advance warning signs on display to notify motorists of the upcoming work. Please allow an additional 15 minutes for your journey.

On **Thursday 7 April** to **Friday 8 April** from **9am** to **4pm** we need to install temporary traffic lights on the B5014 Ridware Road. Please allow an additional time for your journey.

How we will minimise disruption

To minimise disruption, we will be undertaking the work overnight and only closing one road at a time. We will also maintain access to all properties within the traffic management set up using the interactive communication boards. The nature of the work is non-intrusive and should not affect nearby properties.

Where we will be working

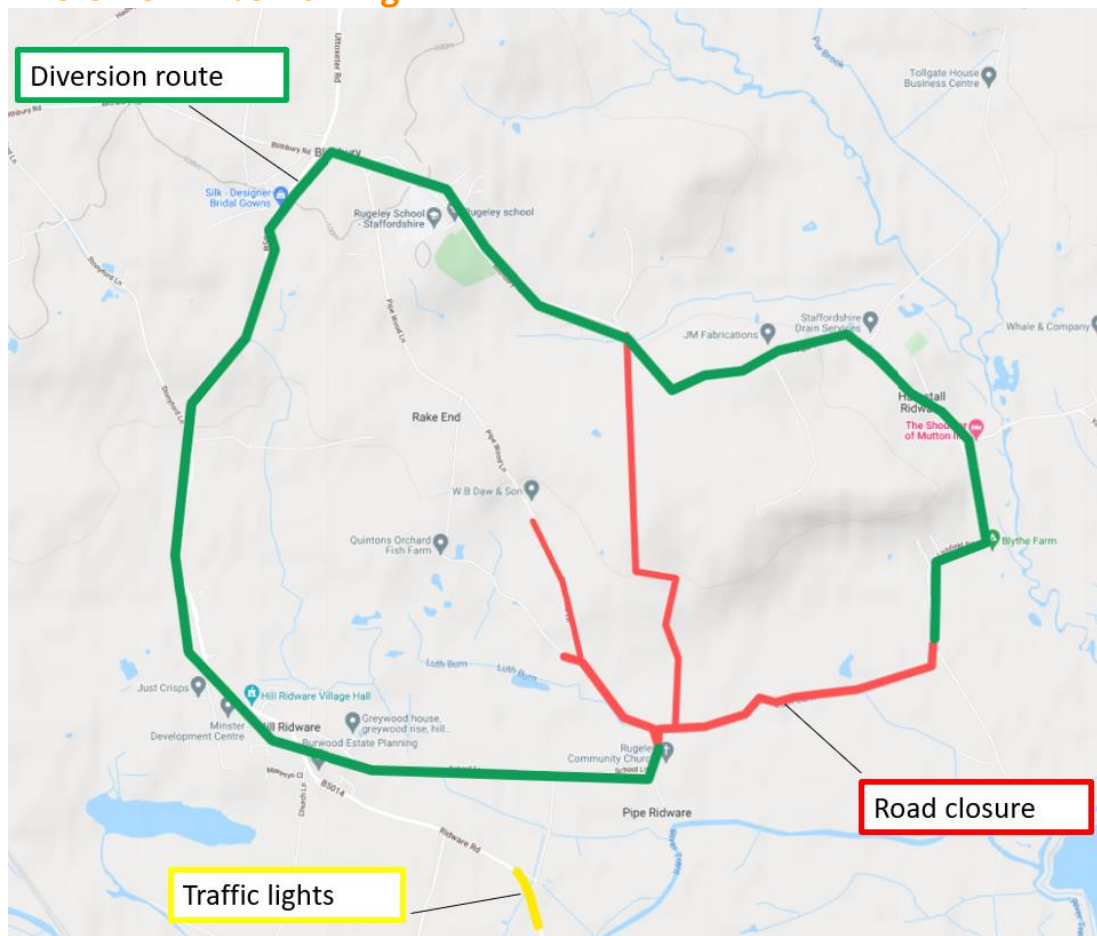

Contact our HS2 Helpdesk team on **08081 434 434**

What else is happening in your area?

www.hs2.org.uk

Contact our HS2 Helpdesk team

Our team is here to listen and respond to your enquiry, complaint or feedback to help us be a good neighbour.

You can contact our Helpdesk team all day, every day of the year on:

Freephone: **08081 434 434**

Minicom: **08081 456 472**

Email: hs2enquiries@hs2.org.uk

Keep up-to-date with your local community website

To find out more about what's happening in your area and receive regular email updates, you can sign up to our local community websites at: www.hs2inyourarea.co.uk.

About our Community and Business Funds

Two funds are now open for applications from local communities and businesses affected by the construction of HS2. They are the Community and Environment Fund (CEF) and the Business and Local Economy Fund (BLEF). £5 million has been allocated to the funds for phase 2a of the railway.

The CEF is designed to give communities the opportunity to share in the benefits of HS2. It is an allocated fund that communities are able to apply for, to help to support local projects that aim to improve their local area.

The BLEF is designed to support local economies that may be disrupted by the construction of HS2. BLEF grants are for local business support organisations and local authorities to help maintain business activity in local communities.

For more information about each of these funds, including how to apply, please visit: <https://www.groundwork.org.uk/hs2funds>



Keeping you informed

We are committed to keeping you informed about work on HS2. This includes ensuring you know what to expect and when to expect it, as well as how we can help you.

The Residents' Commissioner

The independent Residents' Commissioner oversees and monitors our commitments to you.

The commissioner's reports and our responses can be found at www.gov.uk/government/collections/hs2-ltd-residents-commissioner

The Residents' Commissioner makes sure we fulfil the commitments in the HS2 Community Engagement Strategy (<https://bit.ly/3oOA25j>).

The Residents' Commissioner can be contacted on: residentscommissioner@hs2.org.uk

Construction Commissioner

The independent Construction Commissioner regularly meets our Chief Executive Officer to raise any concerns or emerging trends across HS2.

The Construction Commissioner's role has been developed to monitor the way we manage and respond to construction complaints.

The commissioner mediates on disputes about construction, involving individuals and organisations, that we can't resolve. The commissioner advises members of the public about how to make a complaint about construction.

The Construction Commissioner can be contacted on: complaints@hs2-cc.org.uk

Property and compensation

You can find out about HS2 and properties along the route by visiting:

www.gov.uk/government/collections/hs2-property

Find out if you can claim compensation at:

www.gov.uk/claim-compensation-if-affected-by-hs2

Holding us to account

If you are unhappy for any reason you can make a complaint by contacting the HS2 Helpdesk. For more details on our complaints process, please visit:

www.hs2.org.uk/in-your-area/contact-us/how-to-complain/

Contact us

Contact our HS2 Helpdesk team all day, every day of the year on:

 Freephone **08081 434 434**

 Minicom **08081 456 472**

 Email **HS2enquiries@hs2.org.uk**

Write to:

FREEPOST

HS2 Community Engagement

Website **www.hs2.org.uk**

To keep up to date with what is happening in your local area, visit:
www.HS2inyourarea.co.uk

Please contact us if you'd like a free copy of this document in large print, Braille, audio or 'easy read' format. You can also contact us for help and information in a different language.

HS2 Ltd is committed to protecting personal information. If you wish to know more about how we use your personal information please see our Privacy Notice:

<https://www.gov.uk/government/publications/high-speed-two-ltd-privacy-notice>

Reference number: HS2-EW-KIER-Ph2a-Ar-CA01-Surv-10-22/2/2022

High Speed Two (HS2) Limited, registered in England and Wales.

Registered office: Two Snowhill, Snow Hill Queensway, Birmingham B4 6GA.

Company registration number: 06791686. VAT registration number: 888 8512 56.