

**SKANSKA**Working on
behalf of**HS2**

School Road – Sewer Lining 29 November to End of 13 February 2022 | www.hs2.org.uk

High Speed Two (HS2) is the new high speed railway for Britain.

We are continually reviewing the works on our construction sites in line with Government and Public Health England (PHE) advice on dealing with COVID-19. You can sign up for regular updates in your local area at www.hs2.org.uk/stations/old-oak-common

School Road – Monday 29th November to 13 February (Day Works and Night Works)

From Monday 29th November until the end of January CSJV will be carrying out Sewer Lining works in School Road, upgrading the local sewer network. These works will be conducted in phases, beginning to the west of School Road and progressing east before returning in the opposite direction along the opposite side of the road.

No excavations will be required during these works as the access to complete the sewer lining will be via manholes situated within the carriageway. While these works are carried out a closure of the School Road junction with Victoria Road will be in place for through-traffic on nights. School Road businesses will still have access to School Road entrances and be able to use School Road as a two-way road. A diversionary route will be in place via Chase Road and Chandos Road for any through-traffic. School Road will still be open with narrow lanes in place during the day.

Some parking bays will also be suspended along School Road from the 27th November onwards while the closure is in place.

From Monday 29th November to 13th December Night-time works (8pm – 6am) will also be taking place along School Road to minimise disruption to local businesses and the community.

Throughout the duration of our works Thames Water will be in attendance completing commissioning works to the sewer.

If you have a question about HS2 or our works, please contact our HS2 Helpdesk team on 08081 434 434 or email hs2enquiries@hs2.org.uk

Notification



Duration of works

29 November 2021 to 13 February 2022

Working hours

8am to 5pm (Days)

8pm to 6am (Nights)

We may be onsite for one hour either side of the hours above for start-up and shutdown.

What to expect

School Road Junction with Victoria Road to be closed throughout the works

Full road closure of School Road during night-time works

Parking bay suspensions along School Road

Diversion route in place via Bashley Road, Chase Road and Victoria Road.

What we will do

Inform you of any changes to the dates; to sign up for news alerts for updates please visit www.hs2.org.uk/stations/old-oak-common

Location of School Road works and diversion route:

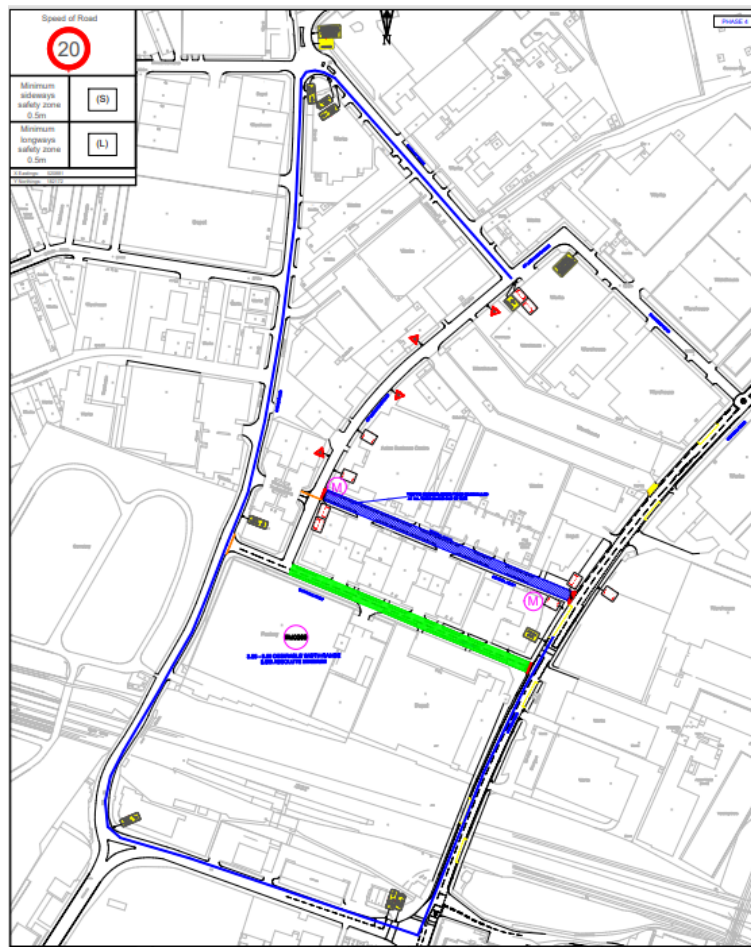
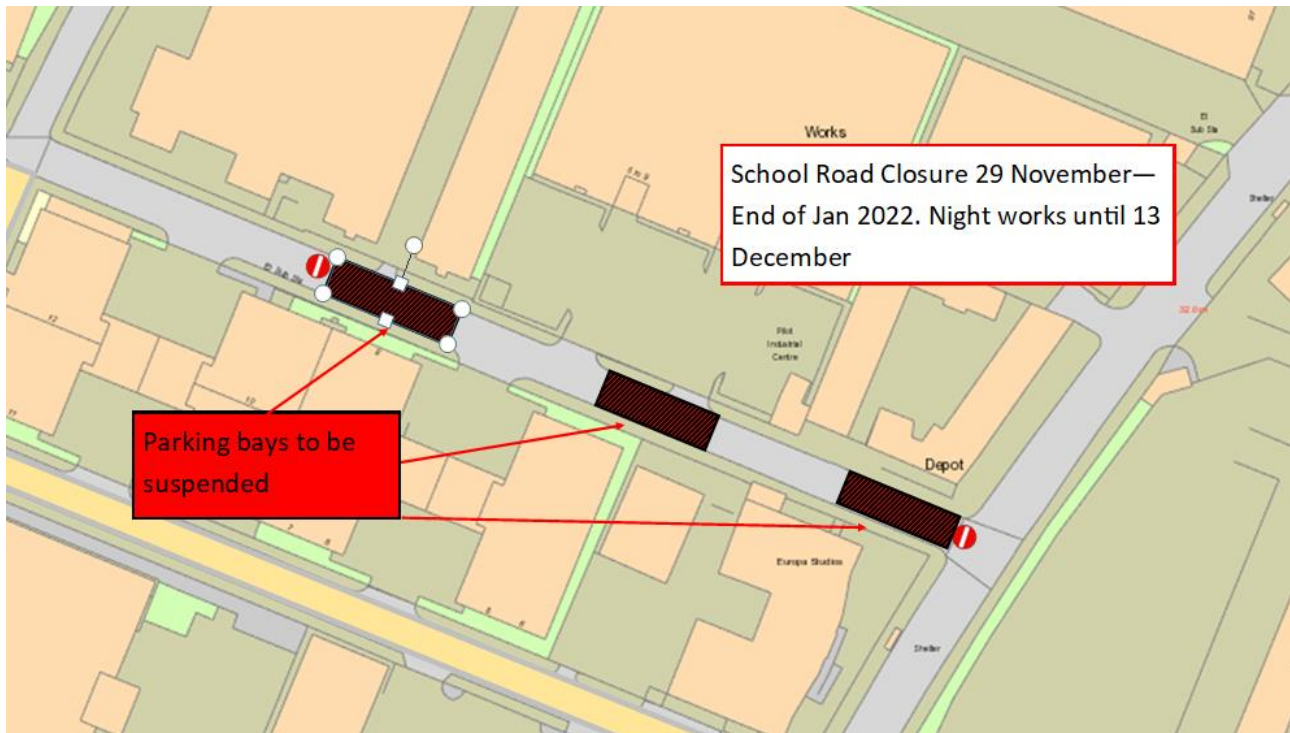

Contact our HS2 Helpdesk team on **08081 434 434**

Keeping you informed

We are committed to keeping you informed about work on HS2. This includes ensuring you know what to expect and when to expect it, as well as how we can help.

Residents' Charter and Commissioner

The Residents' Charter is our promise to communicate as clearly as we possibly can with people who live along or near the HS2 route.
www.gov.uk/government/publications/hs2-residents-charter

We also have an independent Residents' Commissioner whose job is to make sure we keep to the promises we make in the Charter and to keep it under constant review. Find reports at:
www.gov.uk/government/collections/hs2-ltd-residents-commissioner

You can contact the Commissioner at:
residentscommissioner@hs2.org.uk

Construction Commissioner

The Construction Commissioner's role is to mediate and monitor the way in which HS2 Ltd manages and responds to construction complaints. You can contact the Construction Commissioner by emailing:
complaints@hs2-cc.org.uk

Property and compensation

You can find out all about HS2 and properties along the line of route by visiting:
www.gov.uk/government/collections/hs2-property
Find out if you're eligible for compensation at:
www.gov.uk/claim-compensation-if-affected-by-hs2

Holding us to account

If you are unhappy for any reason you can make a complaint by contacting our HS2 Helpdesk team. For more details on our complaints process, please visit our website:
www.hs2.org.uk/how-to-complain

Contact Us

Contact our HS2 Helpdesk team all day, every day of the year on:

 Freephone **08081 434 434**

 Minicom **08081 456 472**

 Email **hs2enquiries@hs2.org.uk**

Write to:

FREEPOST

HS2 Community Engagement

Website **www.hs2.org.uk**

To keep up to date with what is happening in your local area, visit:
www.hs2inyourarea.co.uk

Please contact us if you'd like a free copy of this document in large print, Braille, audio or easy read. You can also contact us for help and information in a different language.

HS2 Ltd is committed to protecting personal information. If you wish to know more about how we use your personal information please see our Privacy Notice
<https://www.gov.uk/government/publications/high-speed-two-ltd-privacy-notice>

Reference number: HS2-MW-SCS-Ph1-Ar-So-S2-Traf-33-11/08/2021

High Speed Two (HS2) Limited, registered in England and Wales.
Registered office: Two Snowhill, Snow Hill Queensway, Birmingham B4 6GA.
Company registration number: 06791686. VAT registration number: 888 8512 56.