

SKANSKA



STRABAG

Working in
partnership with

HS2

Adelaide Road site

Online community update meeting - 8 November 2021

Agenda

Item	Topic
1.	Introduction to SCSJV and the Adelaide Road site
2.	Current and upcoming works
3.	Upcoming sheet piling
4.	Measures in place to reduce disruption
5.	Changes to Adelaide Road
6.	Upcoming ground anchors
7.	Keeping you informed
8.	Q&A



Location

The Adelaide Road site is located in the London Borough of Camden, between Chalk Farm Road and Primrose Hill Road. The site sits in the Network Rail embankment area. Our site does not include the Adelaide Nature Reserve.



Adelaide Road ventilation shaft and headhouse

We are preparing to build a ventilation shaft and head house at the Adelaide Road site, which will connect to the HS2 tunnels.



Key

- 1 Ventilation Stack
- 2 Headhouse
- 3 Shaft
- 4 Running tunnels

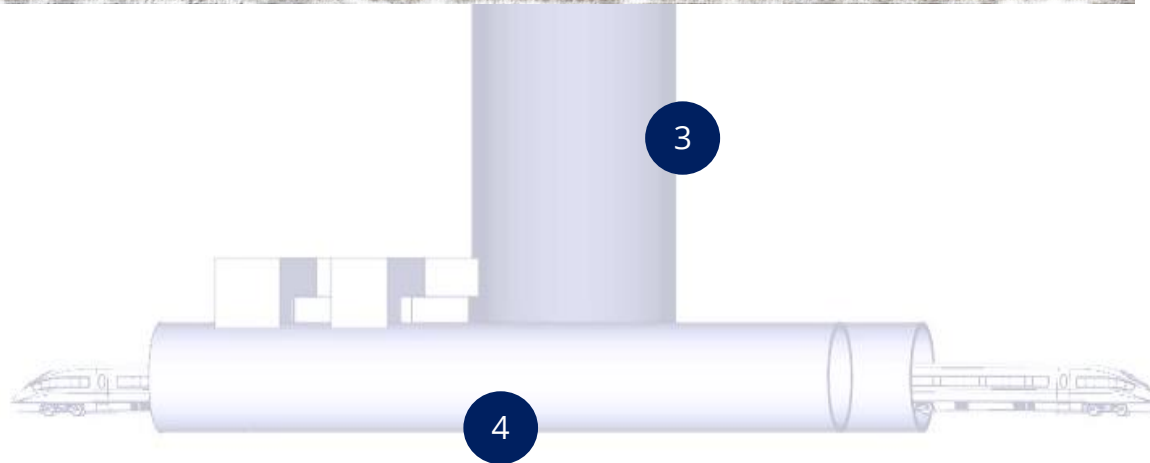

What is a vent shaft?

A vent shaft, or ventilation shaft, is a vertical opening that connects the tunnels to the surface and open air. It uses fans situated in the fan house to regulate air quality and temperature in the tunnels, provides access for emergency services and allows smoke to be extracted in the event of a fire.

What is a head house?

The head house is the building on top of the vent shaft which contains the fire control and ventilation systems for the railway tunnels below. The headhouse will include a fan room.

We plan to start building the ventilation shaft and at this site from 2023 and the headhouse from 2024, but these dates may change. We'll provide updates at [HS2.org.uk](https://www.hs2.org.uk)

Current and upcoming works at Adelaide Road site in 2021/22*

Adelaide Road Vent Shaft programme	2020	2021				2022			
	Q4	Q1	Q2	Q3	Q4	Q1	Q2	Q3	Q4
Site Mobilisation									
Hoarding	■								
Traffic management	■								
Vegetation clearance	■	■			■				
Site office & welfare: phase 3					■				
Design									
Temporary Works design: retaining wall & piling platform	■	■	■						
Permanent civils design	■	■	■	■	■				
Adelaide Road Retaining Wall									
Piling platform					■				
Sheet piling					■	■			
Excavation & ground anchors: phase 1						■	■		
Continue bulk excavation & ground anchors to headhouse							■	■	
Traffic management					■	■	■	■	
Headhouse									
Headhouse piling									■
Utility Diversion Works									
Phase 1 utility diversion works							■	■	
Phase 2 diversion works to release shaft excavation							■	■	
Traffic management									

We may need traffic management during this period. We will provide updates at [HS2.org.uk](https://www.hs2.org.uk)

*the dates for these phases might change. We'll provide updates at [hs2.org.uk/in-your-area/](https://www.hs2.org.uk/in-your-area/)

Upcoming works – sheet piling

We are planning to carry out piling works at our Adelaide Road site in Camden from 29 November until 30 April 2022*. These works are needed to stabilise the ground and protect the Network Rail tracks while we build a ventilation shaft at this site.

What are sheet piles?

Sheet piles are commonly used for retaining walls and underground structures to provide stability and support during excavation works. These are sections of sheet metal with interlocking edges that are pushed into the ground along an area where future excavation work will take place. When arranged side by side, the sheet piles form a wall to provide permanent or temporary earth support.

How will they be installed?

To minimise disruption to local residents during these works, we are planning to use a silent piling method, called Silent Giken, to push the sheet piles into position. This means that the sheet piles can be installed with reduced noise and vibration. This is often called press piling or vibration-free piling, which uses the reaction from previously installed piles to install the adjacent sheet piles.

We will install 275 piles to form a 200 metre wall within our Adelaide Road site boundary. The sheet piles will be up to 16 metres deep and up to 700mm wide.

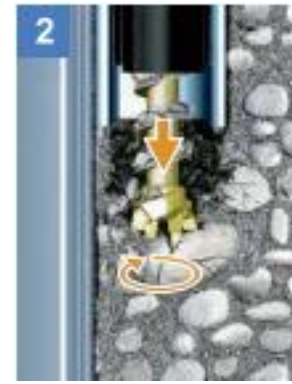

Measures to minimise disruption

We will continue to assess our working methods during our works to ensure we maintain good working practices and keep disruption to a minimum.

Type of disruption	Measures in place
Noise	Noise monitors located around site and vicinity to ensure that we keep to agreed levels Acoustic barriers used where possible
Dust	Dust monitors located around site and vicinity to ensure that we keep to agreed levels
Vibration	We are planning to install vibration monitors within our Adelaide Road site. These will be installed before piling works start to ensure we keep to agreed levels.
Site lighting	Lighting is required on site for security and safety reasons. During the winter months, we will require more lighting on site to ensure our works are carried out safely. We will keep residents informed about our future lighting plans.
Core working hours	Monday to Friday from 8.00am to 6.00pm and Saturdays 8.00am to 1.00pm (If needed) Extended working will be required. We'll notify residents in advance.

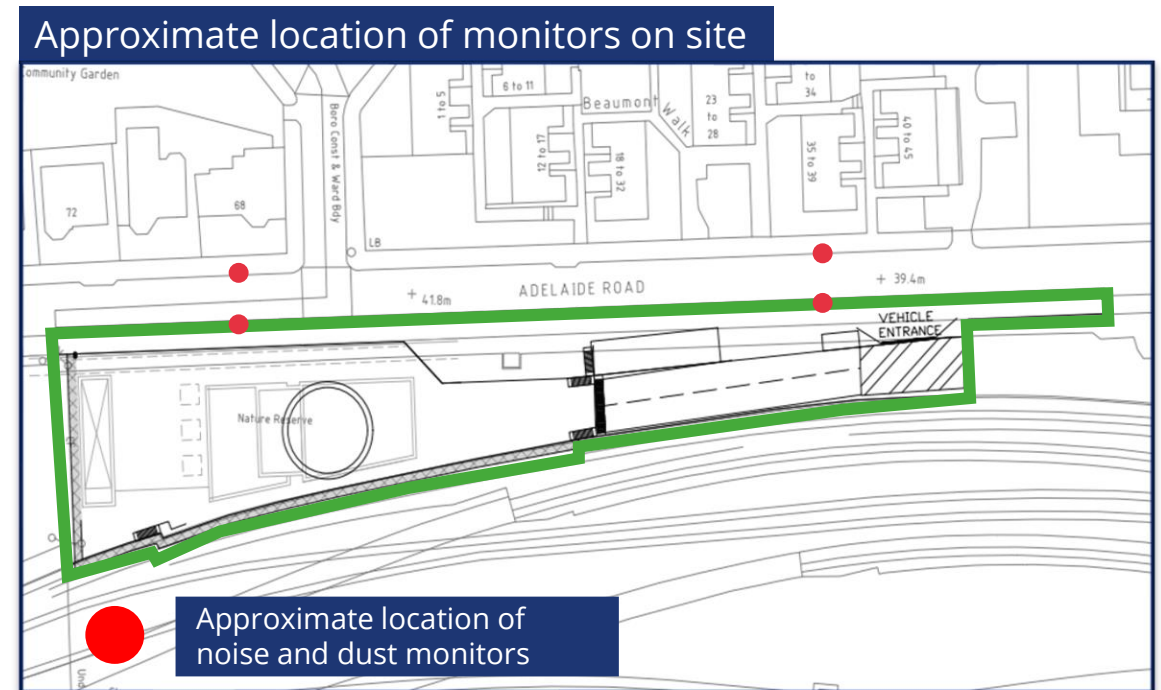

Temporary changes on Adelaide Road

While we carry out sheet piling works within our site, we will need to install a temporary lane closure on Adelaide Road. Temporary three-way traffic lights will be in place on Adelaide Road and the junction of Eton Road. The lane closure will be in place along our site boundary.

Bus stop R (Eton Road Chalk Farm) will be suspended. This is to allow the safe delivery of sheet piles when they arrive at site and to reduce the impact on the road network.

Transport for London are looking at ways to place a temporary bus stop while these works take place. We will keep residents updated.

Phase one – 24 November 2021 to 19 January 2022*

We will have three-way temporary traffic lights in place on Adelaide Road and the junction of Eton Road. The lane closure will be in place along our site boundary. Bus stop R (Eton Road Chalk Farm) will be temporarily suspended during these works. Bus stop P (Primrose Hill Road Adelaide Medical Centre) is the nearest available bus stop for route 31 and N31.

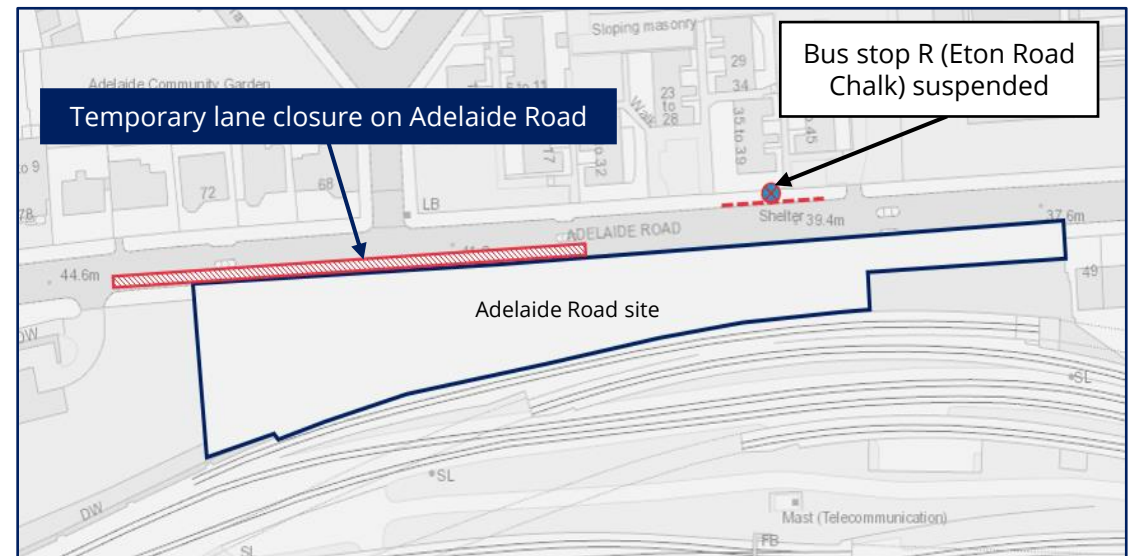

Temporary changes on Adelaide Road

Phase two – 20 January 2022 to 15 March 2022*

We will have three-way temporary traffic lights in place on Adelaide Road and the junction of Eton Road. The lane closure will be in place along our site boundary. Bus stop R (Eton Road Chalk Farm) will be suspended. Bus stop P (Primrose Hill Road Adelaide Medical Centre) is the nearest available bus stop for route 31 and N31.

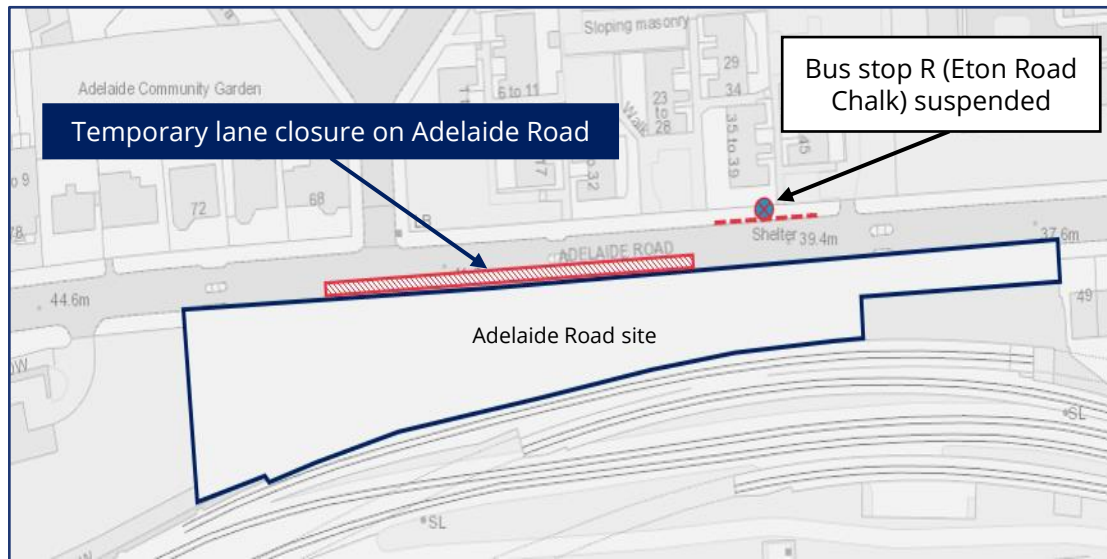

Phase three – 16 March 2022 to 30 April 2022*

We will have three-way temporary traffic lights in place on Adelaide Road and on the entrance of Beaumont Walk. The lane closure will be in place along our site boundary. Bus stop R (Eton Road Chalk Farm) will be suspended. Bus stop P (Primrose Hill Road Adelaide Medical Centre) is the nearest available bus stop for route 31 and N31. Access for residents will not be affected.

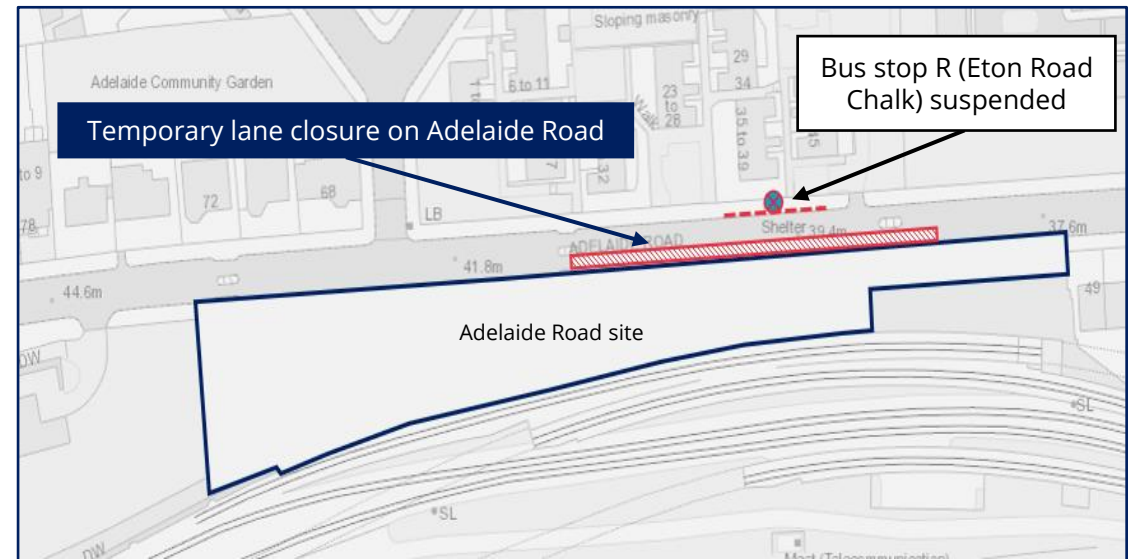

*the dates for these phases might change. We'll provide updates at hs2.org.uk/in-your-area/

Upcoming works – ground anchors

From Spring 2022* we will start installing ground anchors at the Adelaide Road.

What are ground anchors?

Ground anchors are lightweight, corrosive resistant rods or cables installed into the ground to hold, restrain and support building, civil engineering works and other structures, either permanently or temporarily.

Anchors will be carefully designed to avoid underground structures and services



How will they be installed?

The ground anchors at our Adelaide Road will pass beneath the footway, road and properties from Network Rail embankment area to the northern side of Adelaide Road and eastern side of the Nature Reserve. We will drill a hole from track-side to pass through the retaining wall and beneath the street and properties. Then we will install a liner and steel reinforcement, followed by grout.

We will install 235 anchors which will be up to 35 metres long and one to three metres apart.

Upcoming works – location of sheet piling and ground anchors

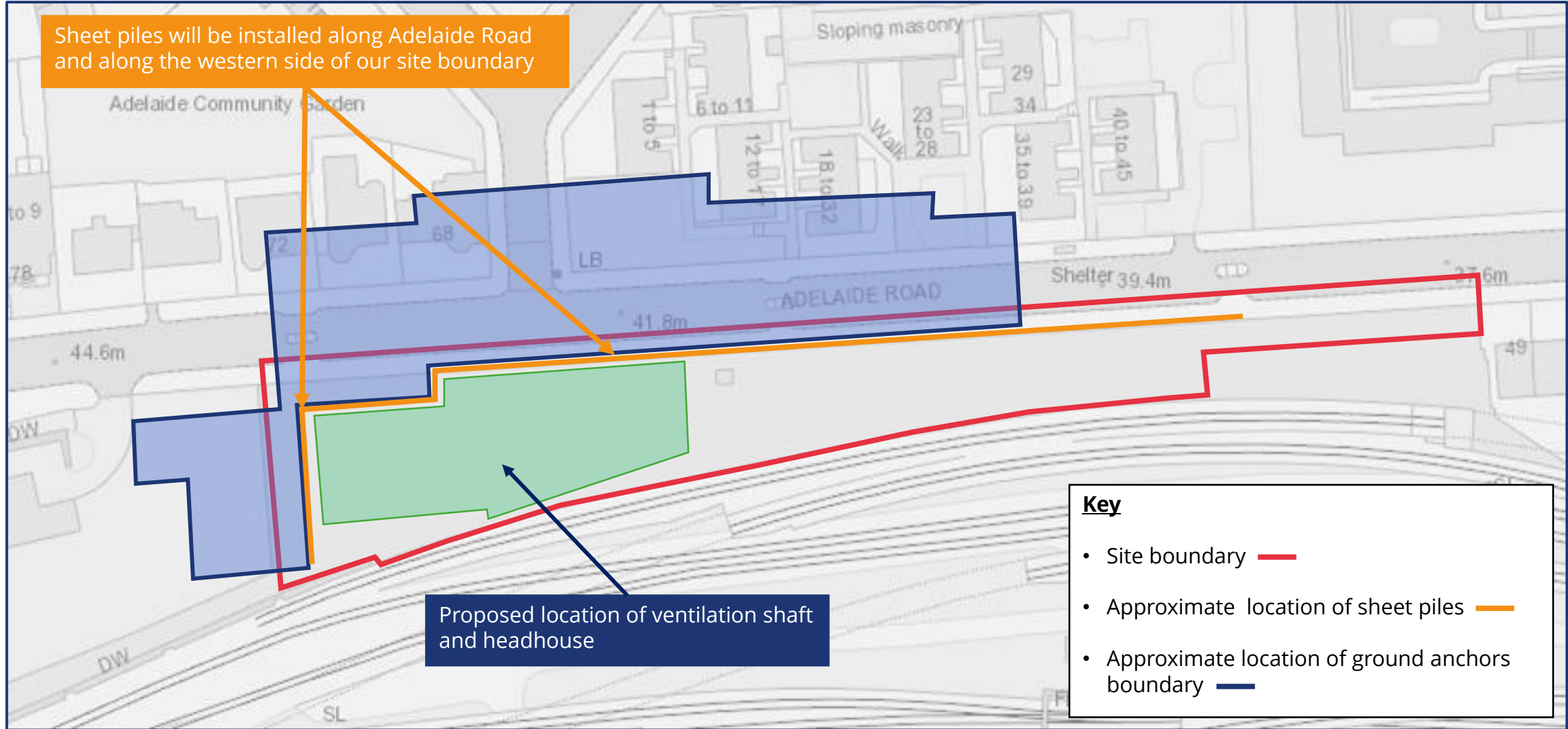

Keeping you informed

Planned engagement activity	Planned engagement date*
Adelaide Road Design Engagement – You Said, We Did	We will be holding online information events on: Thursday 25 November, 6:30pm to 8pm Monday 29 November, 12:30pm to 2pm Registration will open from Thursday 11 November at 8am. Please visit HS2.org.uk/events
Notification about works in your area	Throughout 2021/22
Monthly virtual drop-ins each month	Book a 20-minute slot to speak with the community engagement team from HS2 and SCSJV on: Wednesday 17 November, 3pm to 6pm Wednesday 15 December, 3pm to 6pm To register your attendance for one of our virtual drop-ins, please visit HS2.org.uk/events

If you have a question or a concern about any of works in your local area, please contact the Helpdesk on 08081 434 434 or email HS2enquiries@hs2.org.uk. Our local engagement team will contact you via phone or email to discuss your question or concerns.