

# Update Notice: Ground Investigation works on Old Oak Common Lane

September 2021 | [www.hs2.org.uk](http://www.hs2.org.uk)

High Speed Two (HS2) is the new high speed railway for Britain.

We are continually reviewing the works on our construction sites in line with Government and Public Health England (PHE) advice on dealing with COVID-19.

## Ground investigation works on Old Oak Common Lane from 4- 15 October 2021

We previously notified the community about ground investigation works taking place on Old Oak Common Lane. You can find that notification here: <https://assets.hs2.org.uk/wp-content/uploads/2021/08/Joint-BBVS-and-CSJV-survey-and-TBM-cable-works.pdf>

These works have been delayed, and will now take place from 4-15 October 2021. Our working hours will be 8am to 6pm Monday to Friday, and 8am to 1pm on Saturdays. No work will take place on Sundays or bank holidays.

## We will be setting up temporary traffic management

The ground investigation work is being carried out on the boundary of the Old Oak Common Station site. To work safely in this location, we will need to set up temporary traffic management systems including closing the footpath on the eastern side and the southbound lane of Old Oak Common Lane for the duration of the works. A temporary pedestrian diversion route will be put in place so that we can carry out the works as safely as possible. There will be temporary traffic light controls put in place on the carriageway to direct the flow of traffic. We will also need to suspend bus stops in this location. Further details of this traffic management are included in the maps on the following pages.

**If you have a question about HS2 or our works, please contact our HS2 Helpdesk team on 08081 434 434 or email [hs2enquiries@hs2.org.uk](mailto:hs2enquiries@hs2.org.uk)**

## Notification



### Duration of works

Ground investigation work and associated traffic management on Old Oak Common Lane from 4- 15 October 2021

### What to expect

Ground investigation work involving drilling machines on Old Oak Common Lane

Additional traffic management including closure of the eastern pavement and southbound lane on Old Oak Common Lane and diversion of bus stops

### What we will do

Use acoustic barriers to reduce the noise from our works

# Update Notice: Ground Investigation works on Old Oak Common Lane

[www.hs2.org.uk](http://www.hs2.org.uk)

Notification



## **We are drilling boreholes and digging pits into the ground**

We will use a drilling machine to take core samples of the earth and record the ground conditions. We will also dig small pits in the ground.

## **You may experience a slight increase in noise during ground investigation works**

The drilling machines have a small engine which will be in operation during the works and will produce some low level noise. Some intermittent noise may also be experienced when we undertake soil tests and core drilling however, this won't usually last for more than an hour at a time. We will use acoustic barriers around our work sites to help reduce the noise.

## **We will install a temporary work site around the land that we are surveying**

This will consist of temporary fencing. We'll build this temporary site to make sure that we are working as safely as possible. Once we have completed the work, we will ensure that the land is left in the same condition as when we found it.

## **We will need to deliver the drilling machines and equipment to the works site**

We will deliver our equipment to the ground investigation working areas and store it securely in the worksite. This may cause some minor delays to traffic when we are towing the drilling rig to and from the site at the beginning and end of the works and accessing the worksite at the beginning and end of each shift with our van(s).

# Update Notice: Ground Investigation works on Old Oak Common Lane

[www.hs2.org.uk](http://www.hs2.org.uk)

Notification



## Location of Ground Investigation Surveys

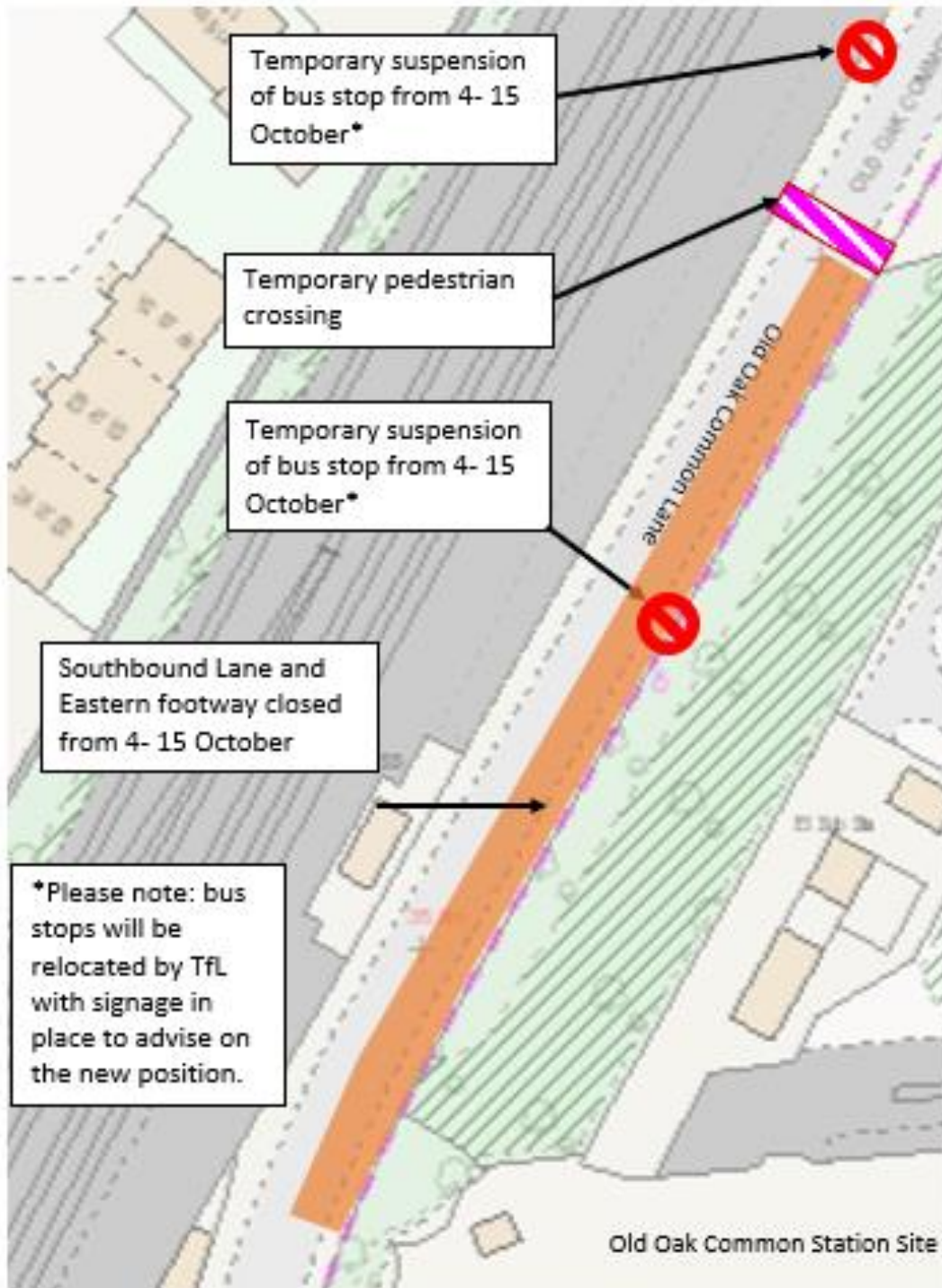

Contact our HS2 Helpdesk team on **08081 434 434**

# Keeping you informed

We are committed to keeping you informed about work on HS2. This includes ensuring you know what to expect and when to expect it, as well as how we can help.

## Residents' Charter and Commissioner

The Residents' Charter is our promise to communicate as clearly as we possibly can with people who live along or near the HS2 route.  
[www.gov.uk/government/publications/hs2-residents-charter](http://www.gov.uk/government/publications/hs2-residents-charter)

We also have an independent Residents' Commissioner whose job is to make sure we keep to the promises we make in the Charter and to keep it under constant review. Find reports at:  
[www.gov.uk/government/collections/hs2-ltd-residents-commissioner](http://www.gov.uk/government/collections/hs2-ltd-residents-commissioner)

You can contact the Commissioner at:  
[residentscommissioner@hs2.org.uk](mailto:residentscommissioner@hs2.org.uk)

## Construction Commissioner

The Construction Commissioner's role is to mediate and monitor the way in which HS2 Ltd manages and responds to construction complaints. You can contact the Construction Commissioner by emailing:  
[complaints@hs2-cc.org.uk](mailto:complaints@hs2-cc.org.uk)

## Property and compensation

You can find out all about HS2 and properties along the line of route by visiting:  
[www.gov.uk/government/collections/hs2-property](http://www.gov.uk/government/collections/hs2-property)  
Find out if you're eligible for compensation at:  
[www.gov.uk/claim-compensation-if-affected-by-hs2](http://www.gov.uk/claim-compensation-if-affected-by-hs2)

## Holding us to account

If you are unhappy for any reason you can make a complaint by contacting our HS2 Helpdesk team. For more details on our complaints process, please visit our website:  
[www.hs2.org.uk/how-to-complain](http://www.hs2.org.uk/how-to-complain)

## Contact Us

Contact our HS2 Helpdesk team all day, every day of the year on:

 Freephone **08081 434 434**

 Minicom **08081 456 472**

 Email **[hs2enquiries@hs2.org.uk](mailto:hs2enquiries@hs2.org.uk)**

Write to:

**FREEPOST**

**HS2 Community Engagement**

Website **[www.hs2.org.uk](http://www.hs2.org.uk)**

To keep up to date with what is happening in your local area, visit:  
**[www.hs2inyourarea.co.uk](http://www.hs2inyourarea.co.uk)**

**Please contact us if you'd like a free copy of this document in large print, Braille, audio or easy read. You can also contact us for help and information in a different language.**

HS2 Ltd is committed to protecting personal information. If you wish to know more about how we use your personal information please see our Privacy Notice  
<https://www.gov.uk/government/publications/high-speed-two-ltd-privacy-notice>

**Reference number: HS2-MW-BBVS-Ph1-OOC-St-S4-Gr-Set-28-10/04/2021**

High Speed Two (HS2) Limited, registered in England and Wales.  
Registered office: Two Snowhill, Snow Hill Queensway, Birmingham B4 6GA.  
Company registration number: 06791686. VAT registration number: 888 8512 56.