



## Notice of works, sheet piling, Small Dean Lane

October 2021 | [www.hs2.org.uk](http://www.hs2.org.uk)

High Speed Two (HS2) is the new high speed railway for Britain. We continually reviewing the works on our construction sites in line with Government and Public Health England (PHE) advice on dealing with COVID-19. The Government's current strategy makes it clear that construction activity can continue as long as it complies with this guidance. Please be assured that only sites that can operate within the guidelines are operational. All sites will remain under constant review. You can sign up for regular updates in your local area at [www.hs2inbucksandox.co.uk](http://www.hs2inbucksandox.co.uk).

### What are we doing?

As part of our continued preparatory works for the construction of the Small Dean Viaduct, we need to install sheet piles adjacent to the existing rail line near Small Dean Lane. These works are vital to protect and secure the network rail line during the construction of the viaduct over the A413.

We are planning to carry out these works over three weekends.

During the works, a section of Small Dean Lane will be closed, with local diversion in place. There will also be a lane closure on the northbound carriageway of the A413 London Road.

### When will these works take place?

These works can only be done under Network Rail possession of the rail line. We will work Friday night to Sunday night, for 24 hours, over three weekends to get the work completed as quickly as possible.

A section of Small Dean Lane will be closed during the weekends these works take place. The temporary lane closure on the A413 London Road will have two-way traffic lights, 24 hours a day during these works.

The weekends these works are scheduled to take place are the following: **29<sup>th</sup>-31<sup>st</sup> October, 5<sup>th</sup>-7<sup>th</sup> November and 12<sup>th</sup>-14<sup>th</sup> November.**

**If you have a question about HS2 or our works, please contact our HS2 Helpdesk team on 08081 434 434 or email [hs2enquiries@hs2.org.uk](mailto:hs2enquiries@hs2.org.uk)**

### Duration of works

Works will commence  
Friday 29 October 2021

Works are expected to take  
place 24 hours a day.

### What to expect

Varied activities with both  
quiet and busier periods.

Installation of sheet piles.

Road closures and some  
additional traffic.

Traffic management.

Noise from plant and  
equipment used for the  
works.

### What we will do

Manage any environmental  
impacts, such as traffic and  
noise.

Respond promptly to any  
complaints and take  
appropriate action.

Take care to respect the  
community.

Conduct noise and vibration  
monitoring to ensure works  
are within approved limits.

# Notice of works, sheet piling, Small Dean Lane

## Notification



### What is sheet piling?

Sheet piles are commonly used for retaining walls and underground structures to provide stability and support to the ground prior to future works taking place, in this case the construction of the viaduct. We will be using sections of sheet metal between nine and sixteen metres long with interlocking edges that will be pushed into the ground, side by side to form a wall to provide a permanent earth retaining barrier. The retaining wall will protect the Chiltern Rail line and the viaduct during construction. We are also preparing the area with some site clearance and construction of an access ramp down to the track as well as track monitoring.

### Will there be noise?

Due to the nature of the works, there will be some construction noise associated with this activity. We will be constantly monitoring all noise at several noise receptor points close to the works areas.

We do not anticipate levels of noise exceeding the allowed limits for working outside of core hours.

We also have a section 61 approval in place from Buckinghamshire Council which permits us to carry out the work.

### Where will the road closure be?

The map below, shows the closure on Small Dean Lane and local diversion via Dunsmore Lane and the A413 London Road. The A413 London Road will also have a temporary lane closure with two-way traffic lights.

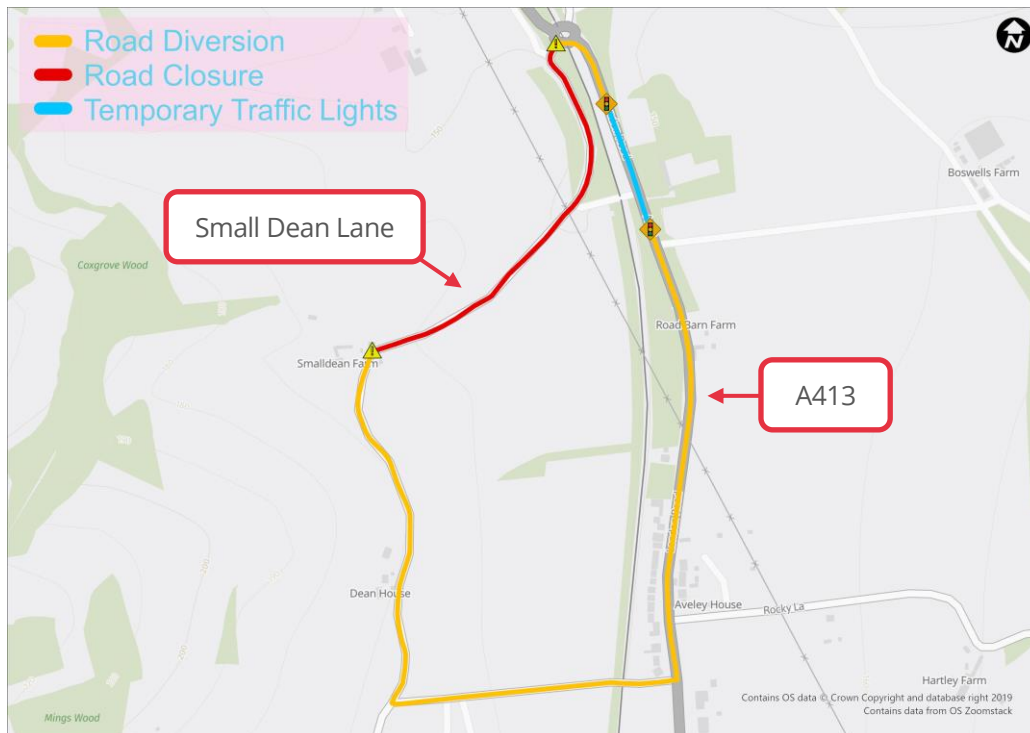

# Notice of works, sheet piling, Small Dean Lane

Notification



## Where will the piling works take place?

The map below, shows the approximate area of works for the installation of sheet piles near Small Dean Lane.

We are planning to use a pre-auger drill to loosen the ground and then push the piles into place using a vibration method. In the event that we find hard ground or obstacles, a vibro-hammer may be used for short periods of time to disturb the ground and drive the sheets through the hard areas.



Contact our HS2 Helpdesk team on **08081 434 434**

# Keeping you informed

We are committed to keeping you informed about work on HS2. This includes ensuring you know what to expect and when to expect it, as well as how we can help.

## Residents' Charter and Commissioner

The Residents' Charter is our promise to communicate as clearly as we possibly can with people who live along or near the HS2 route.  
[www.gov.uk/government/publications/hs2-residents-charter](http://www.gov.uk/government/publications/hs2-residents-charter)

We also have an independent Residents' Commissioner whose job is to make sure we keep to the promises we make in the Charter and to keep it under constant review. Find reports at:  
[www.gov.uk/government/collections/hs2-ltd-residents-commissioner](http://www.gov.uk/government/collections/hs2-ltd-residents-commissioner)

You can contact the Commissioner at:  
[residentscommissioner@hs2.org.uk](mailto:residentscommissioner@hs2.org.uk)

## Construction Commissioner

The Construction Commissioner's role is to mediate and monitor the way in which HS2 Ltd manages and responds to construction complaints. You can contact the Construction Commissioner by emailing:  
[complaints@hs2-cc.org.uk](mailto:complaints@hs2-cc.org.uk)

## Property and compensation

You can find out all about HS2 and properties along the line of route by visiting:  
[www.gov.uk/government/collections/hs2-property](http://www.gov.uk/government/collections/hs2-property)  
Find out if you're eligible for compensation at:  
[www.gov.uk/claim-compensation-if-affected-by-hs2](http://www.gov.uk/claim-compensation-if-affected-by-hs2)

## Holding us to account

If you are unhappy for any reason you can make a complaint by contacting our HS2 Helpdesk team. For more details on our complaints process, please visit our website:  
[www.hs2.org.uk/how-to-complain](http://www.hs2.org.uk/how-to-complain)

## Contact Us

Contact our HS2 Helpdesk team all day, every day of the year on:

 Freephone **08081 434 434**

 Minicom **08081 456 472**

 Email **[hs2enquiries@hs2.org.uk](mailto:hs2enquiries@hs2.org.uk)**

Write to:

**FREEPOST**

**HS2 Community Engagement**

Website **[www.hs2.org.uk](http://www.hs2.org.uk)**

To keep up to date with what is happening in your local area, visit:  
**[www.hs2inyourarea.co.uk](http://www.hs2inyourarea.co.uk)**

**Please contact us if you'd like a free copy of this document in large print, Braille, audio or easy read. You can also contact us for help and information in a different language.**

HS2 Ltd is committed to protecting personal information. If you wish to know more about how we use your personal information please see our Privacy Notice  
<https://www.gov.uk/government/publications/high-speed-two-ltd-privacy-notice>

**Reference number:** HS2-MW-EK-Ph1-Ar-Ce-C2-Prog-works-07-21/10/2021

High Speed Two (HS2) Limited, registered in England and Wales.  
Registered office: Two Snowhill, Snow Hill Queensway, Birmingham B4 6GA.  
Company registration number: 06791686. VAT registration number: 888 8512 56.