

# HS2

## Traffic management update

Community representatives meeting – 24 May 2021



# ARLT Utilities Protection – Atlas Road Roundabout

We will be carrying out utilities works in and around the Atlas Road Roundabout, to provide protection to assets from the expected ground movement cause by the construction of the Atlas Road Logistics Tunnel (ARLT). This work will involve digging temporary trenches to lay new water and gas mains in and around the Atlas Road Roundabout.

**Atlas Road Roundabout** – Works are still under development but are planned to be carried out in multiple phases between August 2021 and August 2022.

Each phase is anticipated to last 2-8wks. Dates and detailed regarding each phase will be released in due course.

Where possible we will look to reduce or minimise the traffic management, and relocate suspended bus stops to a temporary location close by.

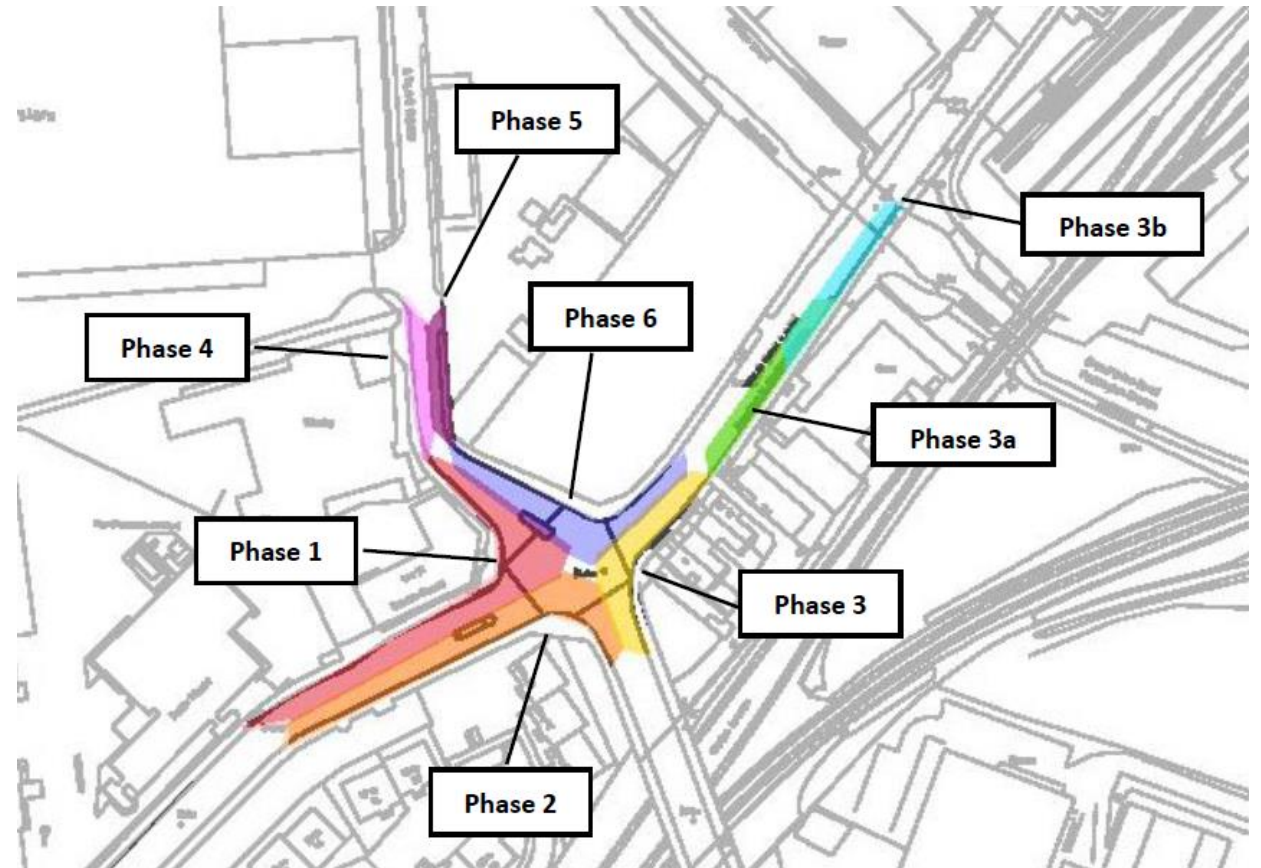

# HS2

## Traffic management across Old Oak





# Old Oak Common Current and Planned works impacting the Highway

- CSJV**
  1. Victoria Road (Southbound phases)
  2. Victoria Rd, jct Victoria Rd
  3. Chandos Road
  4. School Road
  5. SCSJV Vehicle Holding Area
  6. Bethune Road
  7. Chase Road
  8. Atlas Road Roundabout

- SCSVJ**
  7. Chase Road

- BBVS**
  9. Boundary Wall, Old Oak Common Lane
  10. Scrubs, Old Oak Common Lane
  11. Old Oak Common Lane GI

**Note - circles with border are current works, circles without border are proposed works**

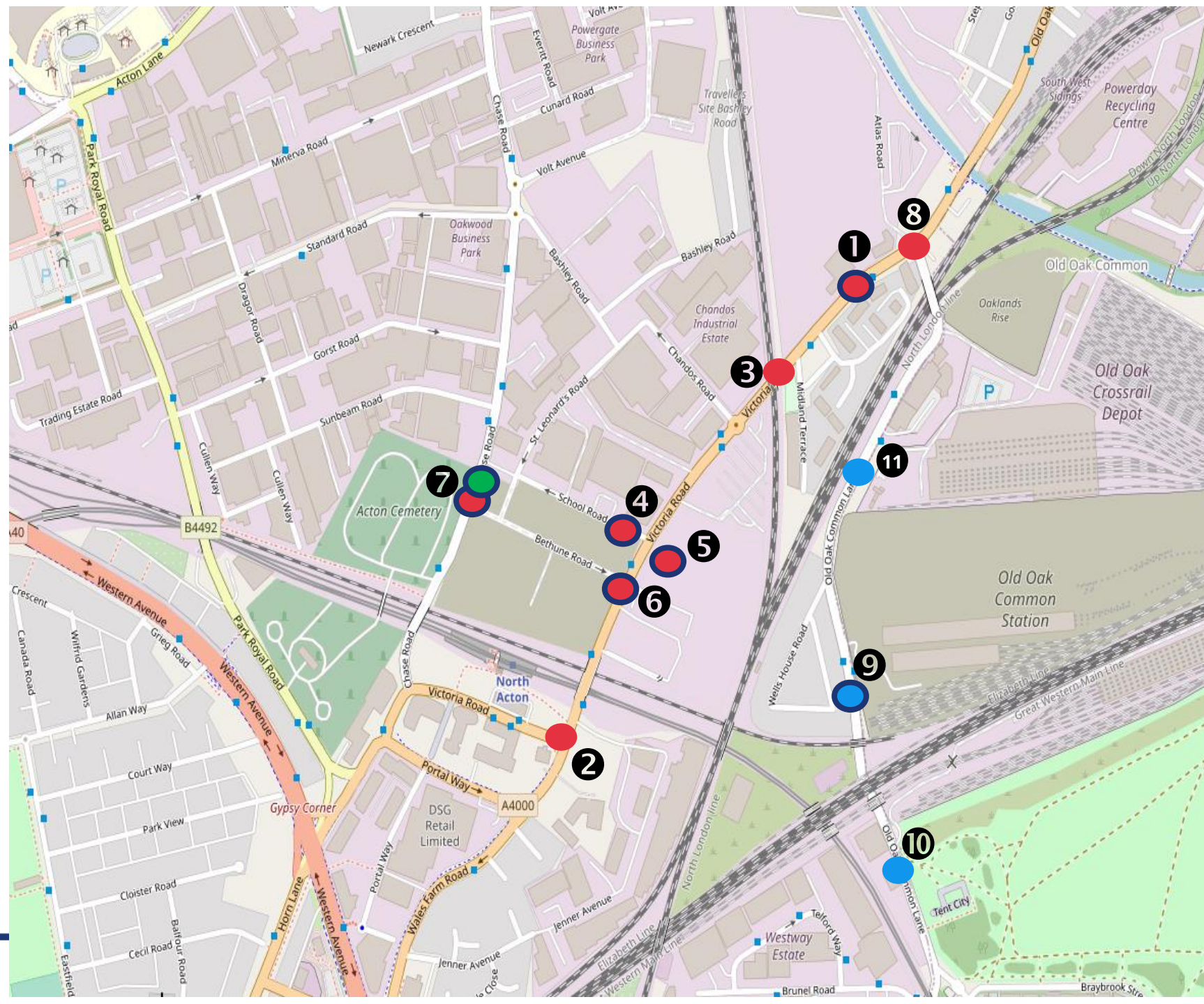

# CSjv works

## ① Victoria Road (Southbound phases)

- 4 way lights have been removed from Atlas Road Roundabout to ease traffic, works will be completed later in the year in collaboration with the ATRL utility protection works
- The TBM power supply works will continue southbound ⑧ in phases

## Victoria Rd, jct Victoria Rd

- ② The permanent lights will be replaced by temporary lights which will synchronise with other temporary lights on Victoria Road to improve the overall flow of traffic

## Chandos Road

- ③ To eliminate drivers overtaking queuing traffic on Victoria Road, traffic measures will be placed in the carriageway

## School Road

- ④ Has now been closed to increase safety for all road users following a series of incidents and driver behaviour



# CSjv works (cont)

## 5 SCS Vehicle Holding Area

- A temporary traffic light head has been installed to synchronise construction traffic ingress and egress with Victoria Road traffic management arrangements

## Bethune Road

- 6 Utility diversion works in and around Victoria Road continue, collaborating with TBM power supply works in phases northbound to meet up with

## Chase Road

- 7 Working in collaboration with SCSJV

## Atlas Road Roundabout

- 8 Planned works for ARLT utility protection





# SCSJV update – ground investigations on Chase Road

Until July, we are carrying out further ground investigations on Chase Road. This will involve digging temporary trenches to confirm the location of utilities under the road surface.

## Phase one – late April to late May

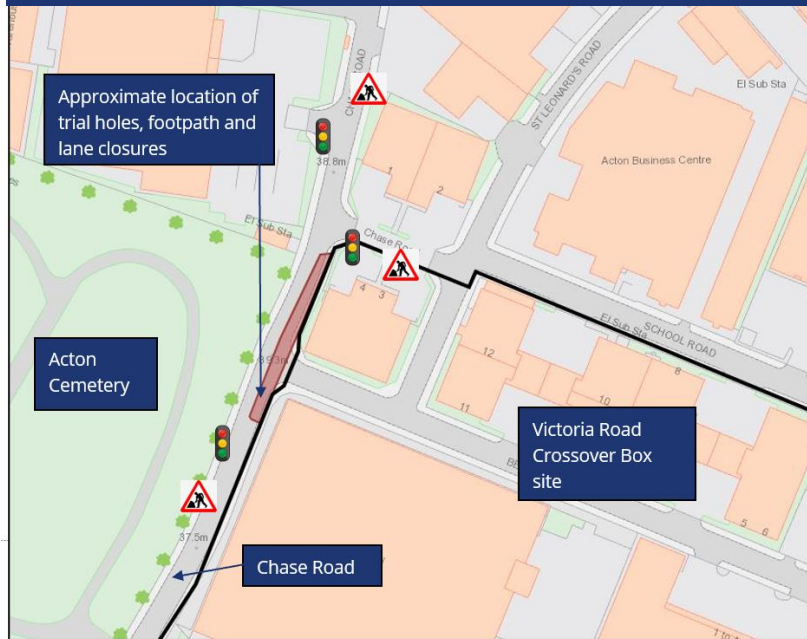

## Phase two – late-May

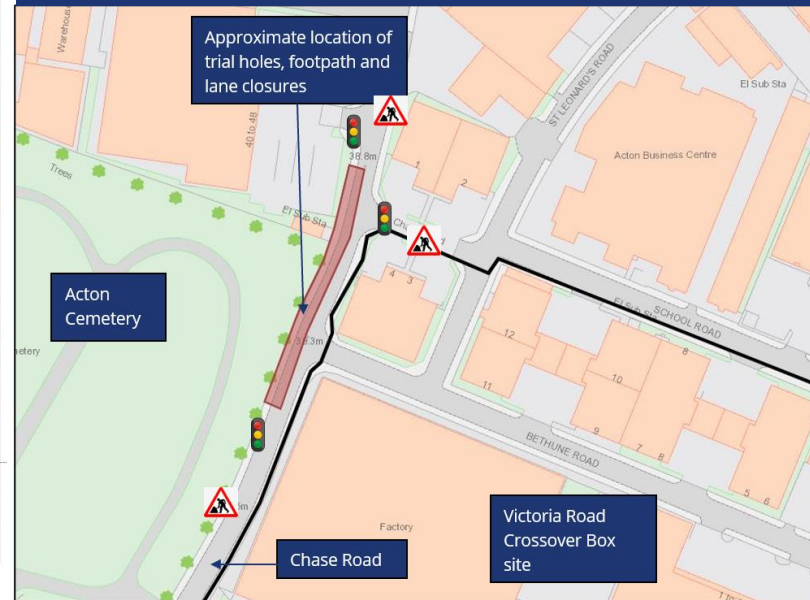

## Phase three – June to July 2021



These dates may change. You can view the notification about the Chase Road ground investigation works [here](#).

# Old Oak Common Lane- Boundary Wall



- Northbound Lane closed and three-way traffic lights in place.
- Required for safety reasons, due to the risk posed by the unstable Wells House Road Boundary Wall.
- We are currently progressing plans to stabilise the wall which will allow us to remove the lane closure in this location. We expect this will be done by the end of 2021.
- Northern most section of the lane closure may be lifted earlier and lights reduced to two-way, however this is dependant on the stability of the wall.



# Old Oak Common Lane- Wormwood Scrubs

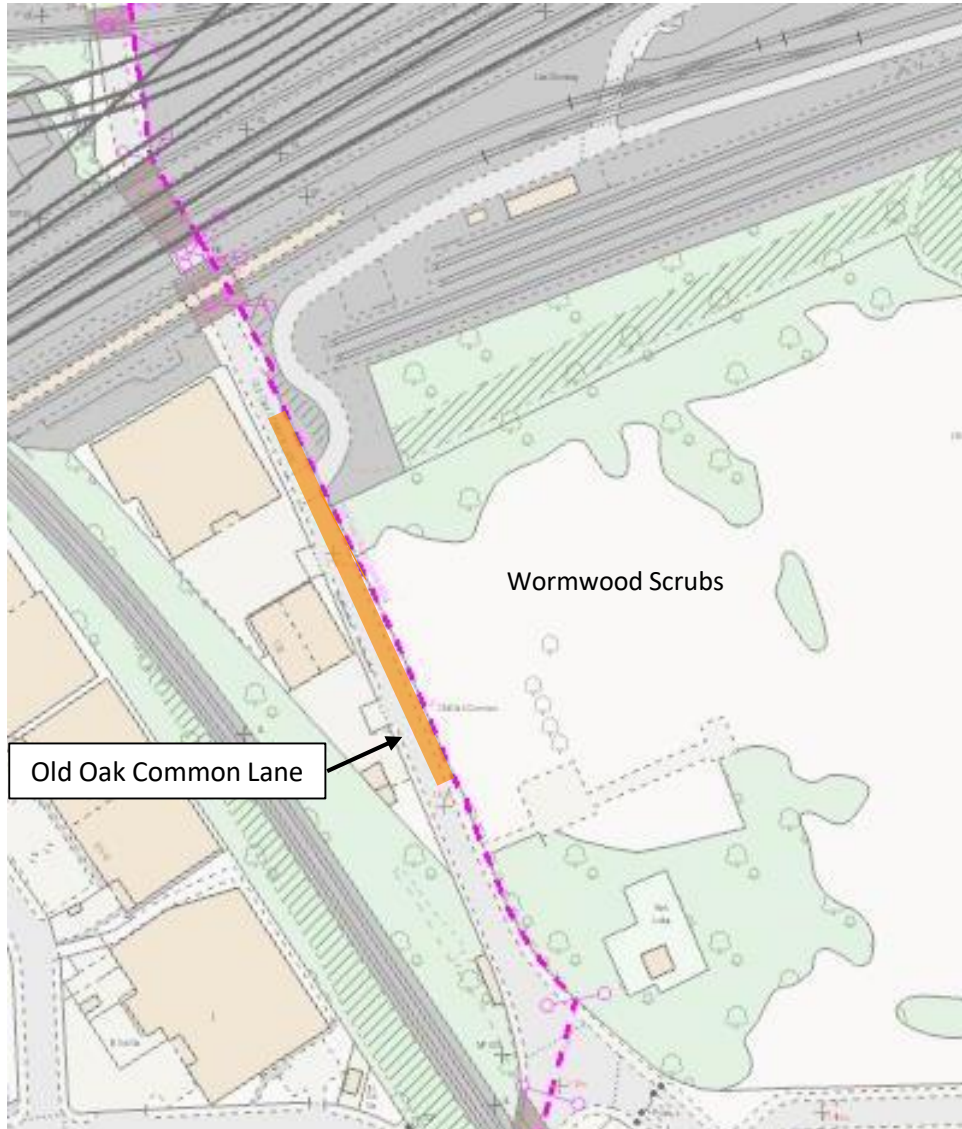

- Southbound Lane and footway closures on the weekends of 29-31 May, and 5- 6 June 2021 with two-way traffic lights.
- Utilities Investigation works including trial holes and slit trenches to help map utilities services in advance of creating the new access route to the UTX and SBS sites on Wormwood Scrubs.
- Weekend working to maintain local business access

# Old Oak Common Lane- Ground Investigation Works 11

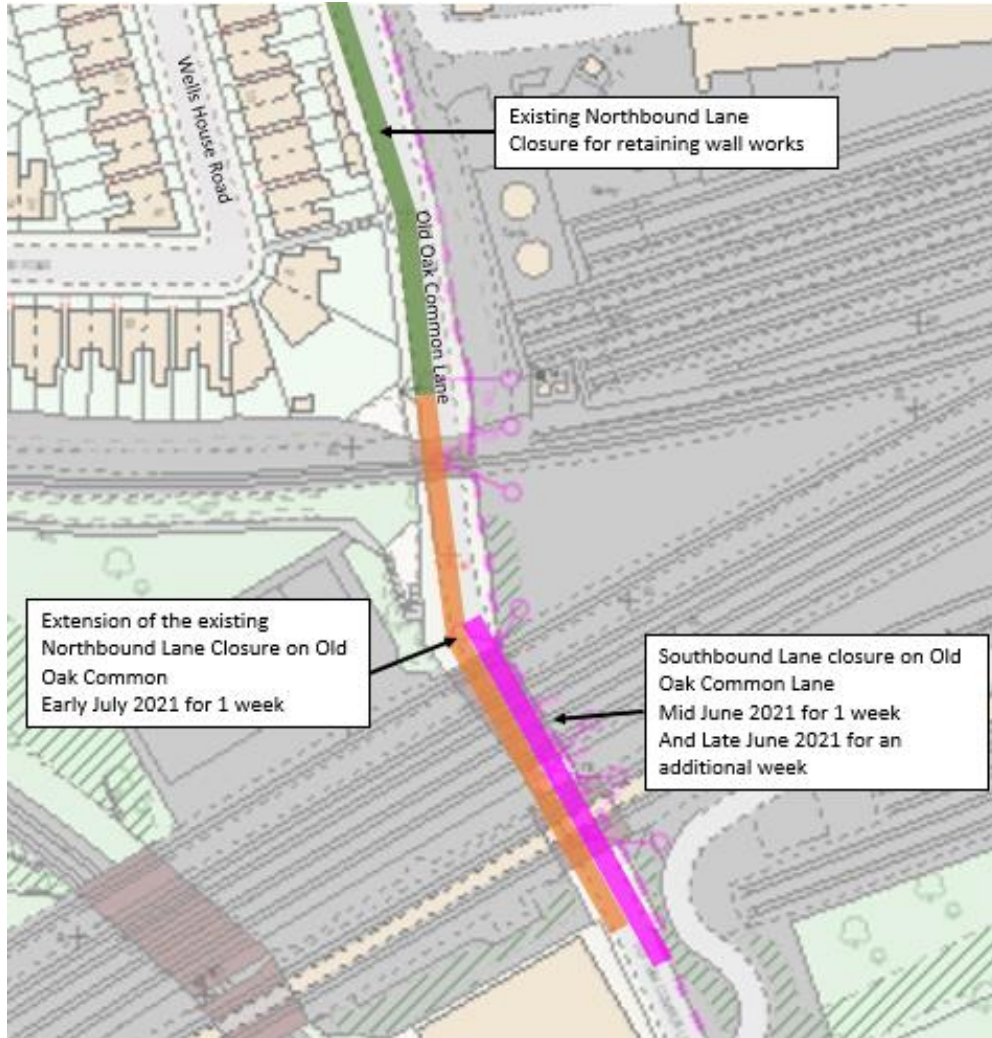

- Southbound Lane Closure with 2-way Traffic Lights on Old Oak Common Lane in Mid June for approximately one week, and again in Late June for approximately one week.
- Extension of the Northbound Lane Closure on Old Oak Common Lane in Early July for approximately one week.
- Ground Investigation works including boreholes & coring pits to take samples of the earth.

# Indicative programme - utility works (CSJv)

Location	Contractor	Traffic Management	Start / Finish	Description of works
<b>Chase Road</b> • <b>Utility Diversion</b>	CSJV, Thames Water	All under the same three-way traffic lights management	April 2021 to mid-July 2021	<ul style="list-style-type: none"> <li>- Final connection of new diversion to existing water main</li> <li>- Complete commissioning</li> </ul>
<b>Victoria Road</b> • <b>Utility Diversion</b> • <b>TBM</b>	CSJV, Cadent Gas, Various Comms Companies, Thames Water	All under two way & three-way traffic lights management	January 2021 to January 2022 (to be undertaken in phases along Victoria Road)	<ul style="list-style-type: none"> <li>- Gas connections</li> <li>- Communications cables</li> <li>- Water main install works</li> <li>- Sewer Lining Works</li> <li>- Excavation and Laying electrical cables</li> <li>- Installation of ducts</li> </ul>
<b>Atlas Road Roundabout</b> • <b>ARLT utilities protection</b>	CSJV	Works to be undertaken in 6 phases requiring 4/5 way or 2 way traffic lights	August 2021 – August 2022 (pending further programme development)	<ul style="list-style-type: none"> <li>- Trench excavation, installation and connection of Water &amp; Gas mains</li> </ul>

\*The dates of works are indicative and may change as the works progress – we will provide an update on [HS2inOldOak.co.uk](https://www.hs2inoldoak.co.uk)

# Indicative programme - SCSJV

Location	Contractor	Traffic Management	Start / Finish	Description of works
<b>Chase Road</b>	SCSJV	Traffic management layout to be confirmed, subject to further ground investigations and utility surveys	From September 2021 (to be confirmed)	Utility protection and diversion works
<b>Victoria Road</b>	SCSJV	Traffic management layout to be confirmed, subject to further ground investigations and utility surveys	From October 2021 to August 2022 (subject to confirmation and coordination with BBVS and CSJV)	Utility upgrade works
<b>Victoria Road</b>	SCSJV	Road closure	Four weekend closures during September and October 2021 (to be confirmed and coordinated with BBVS)	Conveyor installation between Flat Iron and Atlas Road sites (road and rail crossing)

\*The dates of works are indicative and may change as the works progress – we will provide an update on [HS2inOldOak.co.uk](https://www.hs2inoldoak.co.uk)



# BBVS Traffic Management Programme

Location	Traffic Management	Start / Finish	Description of works
<b>Old Oak Common Lane</b> • <b>Wells House Road Boundary Wall</b>	Northbound Lane Closure & three-way traffic lights	Ongoing to end 2021	Lane closure for safety reasons due to risks posed by the unstable Wells House Road Boundary Wall
<b>Old Oak Common Lane</b> • <b>Utilities Investigation Works adjacent Wormwood Scrubs</b>	Southbound Lane Closures and two-way traffic lights	29-31 May, and 5- 6 June 2021	Utilities Investigation works including trial holes and slit trenches to help map utilities services in advance of creating the new access route to the UTX and SBS sites on Wormwood Scrubs
<b>Old Oak Common Lane</b> • <b>Ground Investigation Works</b>	Extension of existing Northbound Lane Closure	Early July for approx. 1 week	Ground Investigation works including boreholes & coring pits to take samples of the earth
<b>Old Oak Common Lane</b> • <b>Ground Investigation Works</b>	Southbound Lane Closure and two-way traffic lights	Mid June for approx. 1 week & Late June for approx. 1 week.	Ground Investigation works including boreholes & coring pits to take samples of the earth
<b>Old Oak Common Lane</b> • <b>Wormwood Scrubs Access Route Set-up</b>	Southbound Lane Closure with two-way traffic lights	Late July over approx. 3 weekends.	Construction of the new access route from Old Oak Common Lane onto the SBS and UTX sites on Wormwood Scrubs

\*The dates of works are indicative and may change as the works progress – we will provide an update on [HS2inOldOak.co.uk](https://www.hs2inoldoak.co.uk)

# BBVS Traffic Management Programme

Location	Traffic Management	Start / Finish	Description of works
<b>Old Oak Common Lane</b> <ul style="list-style-type: none"> <li>• <b>Conveyor installation works</b></li> </ul>	Full Road Closure- details TBC	Over one weekend in September 2021	Full Road Closure to install the conveyor over Old Oak Common Lane
<b>Old Oak Common Lane</b> <ul style="list-style-type: none"> <li>• <b>Old Oak Common Station Site entrance</b></li> </ul>	Road and footway closures – details TBC	September 2021- TBC	Localised Road and footway closures to facilitate changes to the Old Oak Common Station site entrance layout.
<b>Old Oak Common Lane</b> <ul style="list-style-type: none"> <li>• <b>Adjacent to Satellite Sites South of Wells House Road</b></li> </ul>	Lane Closure- details TBC	October 2021	Site establishment works for conveyor sites.
<b>Old Oak Common Lane</b> <ul style="list-style-type: none"> <li>• <b>Crossrail retaining wall works</b></li> </ul>	Lane Closure- details TBC	November 2021	Crossrail retaining wall piling and kerb re-alignment works
<b>Old Oak Common Lane</b> <ul style="list-style-type: none"> <li>• <b>Wycombe Bridge Demolition</b></li> </ul>	Full Road Closure- details TBC	March 2022	Full weekend road closure for the demolition of the Wycombe Bridge

\*The dates of works are indicative and may change as the works progress – we will provide an update on [HS2inOldOak.co.uk](https://www.hs2inoldoak.co.uk)

**Any questions?**

