

These maps are based on our emerging design and may change as we continue to refine the design, complete environmental assessments and take into consideration further feedback

**Phase 2b Route**

- At Grade
- Bored Tunnel
- Cut And Cover
- Cutting
- Embankment
- Viaduct
- Box Structure
- Depot
- Green Tunnel
- Retained Cut
- Retaining Wall
- Station
- Tunnel Portal
- Underground Box

**Legend**

- Electricity Substations
- Station (July 2017)
- Building Footprint
- Other Transport Facilities
- Shaft
- Portal
- Tunnel Excavated Extent
- Balancing Pond
- Main Construction Compounds

- New/Recent Developments
- Earthworks (Rail & Non Rail)
- Road Closures
- Proposed Access off Highway
- Satellite Construction Compound

- Event Locations
- Community Area Boundary
- Road Edge of Carriageway
- Public Rights Of Way - Existing
- Public Rights Of Way - New
- Public Rights Of Way - Stopped Up Perm.
- Main Network Rail Alignment
- Rail Alignment Formation Edges

**High Speed Two  
Phase 2b  
Engagement Event Maps  
June 2018**

**Map 49 - (LA07)**

*Published*

**HS2**

Registered in England. Registration number 06791686.  
Registered office: 2 Snowhill, Queensway, Birmingham B4 6GA

© Crown copyright and database rights 2018.  
OS 100049190

Scale at A3: 1:10,000

Doc Number: HS2-HS2-SE-MAP-000-000009

Date: 25/05/18



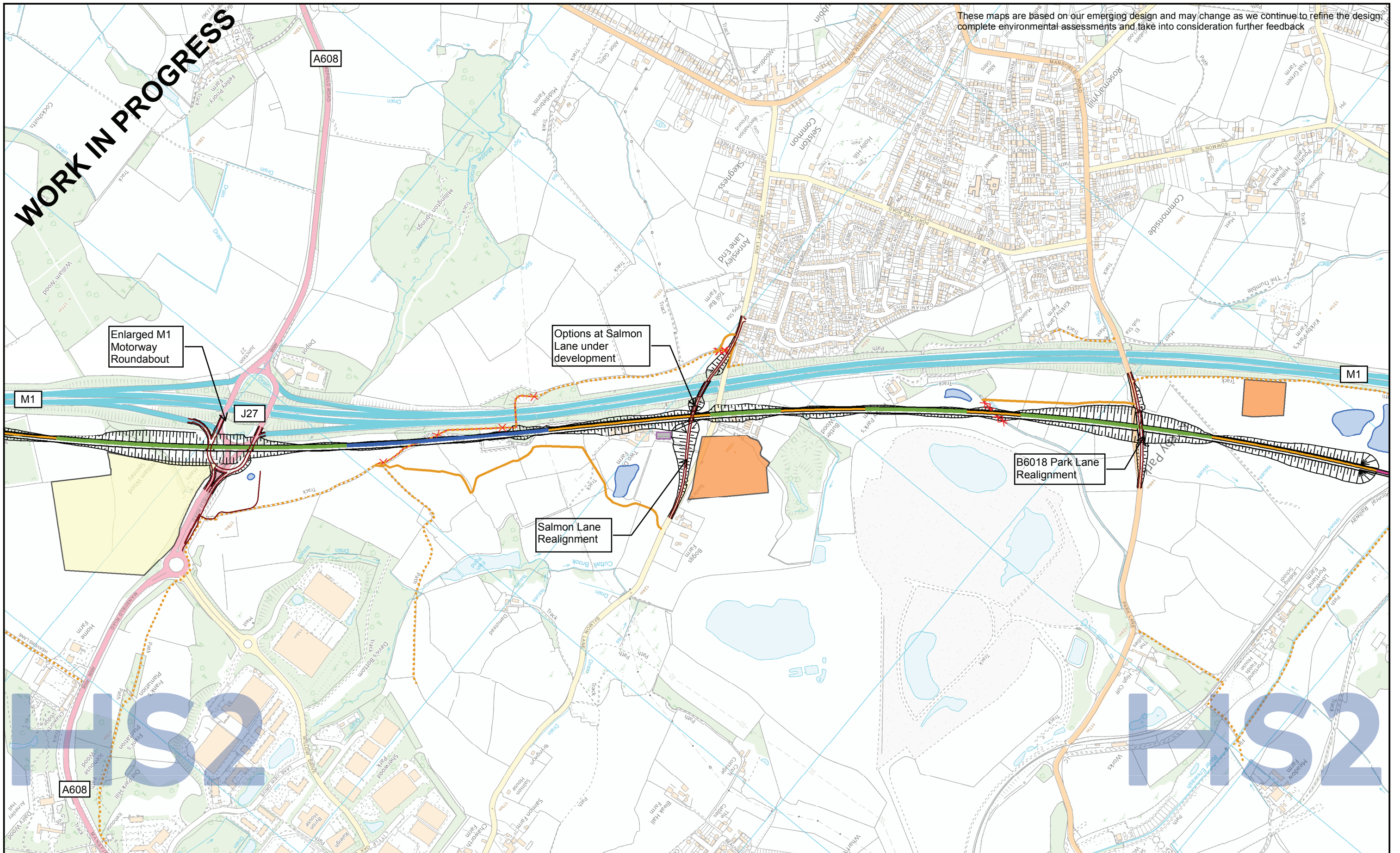

These maps are based on our emerging design and may change as we continue to refine the design, complete environmental assessments and take into consideration further feedback

**Phase 2b Route**

- At Grade
- Bored Tunnel
- Cut And Cover
- Cutting
- Embankment
- Viaduct
- Box Structure
- Depot
- Green Tunnel
- Retained Cut
- Retaining Wall
- Station
- Tunnel Portal
- Underground Box

**Legend**

- Electricity Substations
- Station (July 2017)
- Building Footprint
- Other Transport Facilities
- Shaft
- Portal
- Tunnel Excavated Extent
- Balancing Pond
- Main Construction Compounds

**New/Recent Developments**

- Earthworks (Rail & Non Rail)
- Road Closures
- Proposed Access off Highway
- Satellite Construction Compound

**Event Locations**

- Community Area Boundary
- Road Edge of Carriageway
- Public Rights Of Way - Existing
- Public Rights Of Way - New
- Public Rights Of Way - Stopped Up Perm.
- Main Network Rail Alignment
- Rail Alignment Formation Edges

**Map 50 - (LA07)**

Published

**High Speed Two Phase 2b Engagement Event Maps June 2018**

Map 50 - (LA07)

Published

**HS2**

Registered in England. Registration number 06791686.  
Registered office: 2 Snowhill, Queensway, Birmingham B4 6QA

© Crown copyright and database rights 2018.  
OS 100049190

Scale at A3: 1:10,000

Doc Number: HS2-HS2-SE-MAP-000-000009

Date: 25/05/18



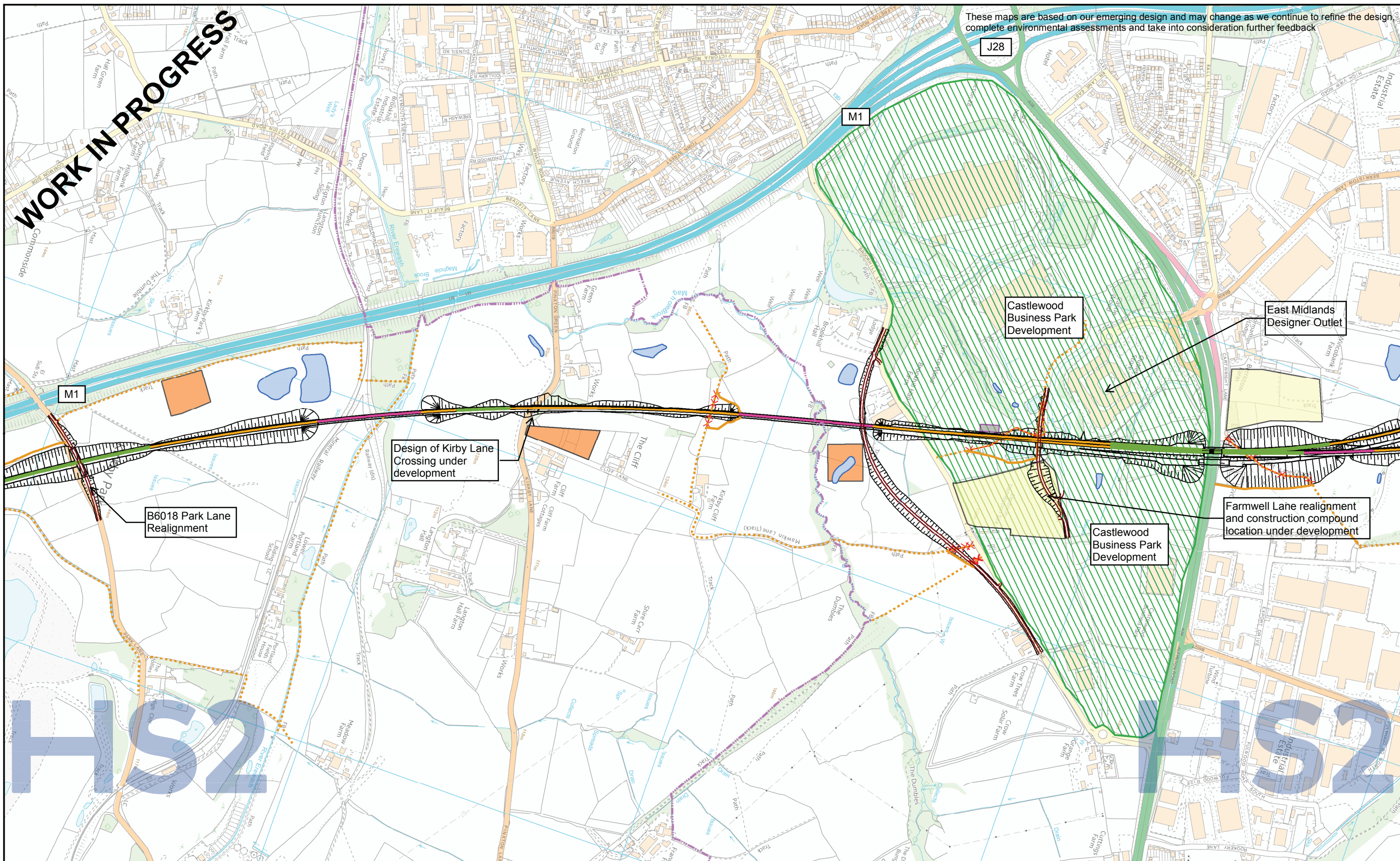

**Phase 2b Route**

- At Grade
- Bored Tunnel
- Cut And Cover
- Cutting
- Embankment
- Viaduct
- Box Structure
- Depot
- Green Tunnel
- Retained Cut
- Retaining Wall
- Station
- Tunnel Portal
- Underground Box

**Legend**

- Event Locations
- Community Area Boundary
- Road Edge of Carriageway
- Public Rights Of Way - Existing
- Public Rights Of Way - New
- Public Rights Of Way - Stopped Up Perm.
- Main Network Rail Alignment
- Rail Alignment Formation Edges
- Electricity Substations
- Station (July 2017)
- Building Footprint
- Other Transport Facilities
- Shaft
- Portal
- Tunnel Excavated Extent
- Balancing Pond
- Main Construction Compounds
- New/Recent Developments
- Earthworks (Rail & Non Rail)
- Road Closures
- Proposed Access off Highway
- Satellite Construction Compound

**High Speed Two  
Phase 2b  
Engagement Event Maps  
June 2018**

**Map 51 - (LA07)**

*Published*

**HS2**

Registered in England. Registration number 06791686.  
Registered office: 2 Snowhill, Queensway, Birmingham B4 6GA

© Crown copyright and database rights 2018.  
OS 100049190

Scale at A3: 1:10,000

**Doc Number: HS2-HS2-SE-MAP-000-000009**

**Date: 25/05/18**